

MGA2020 ZONE 55

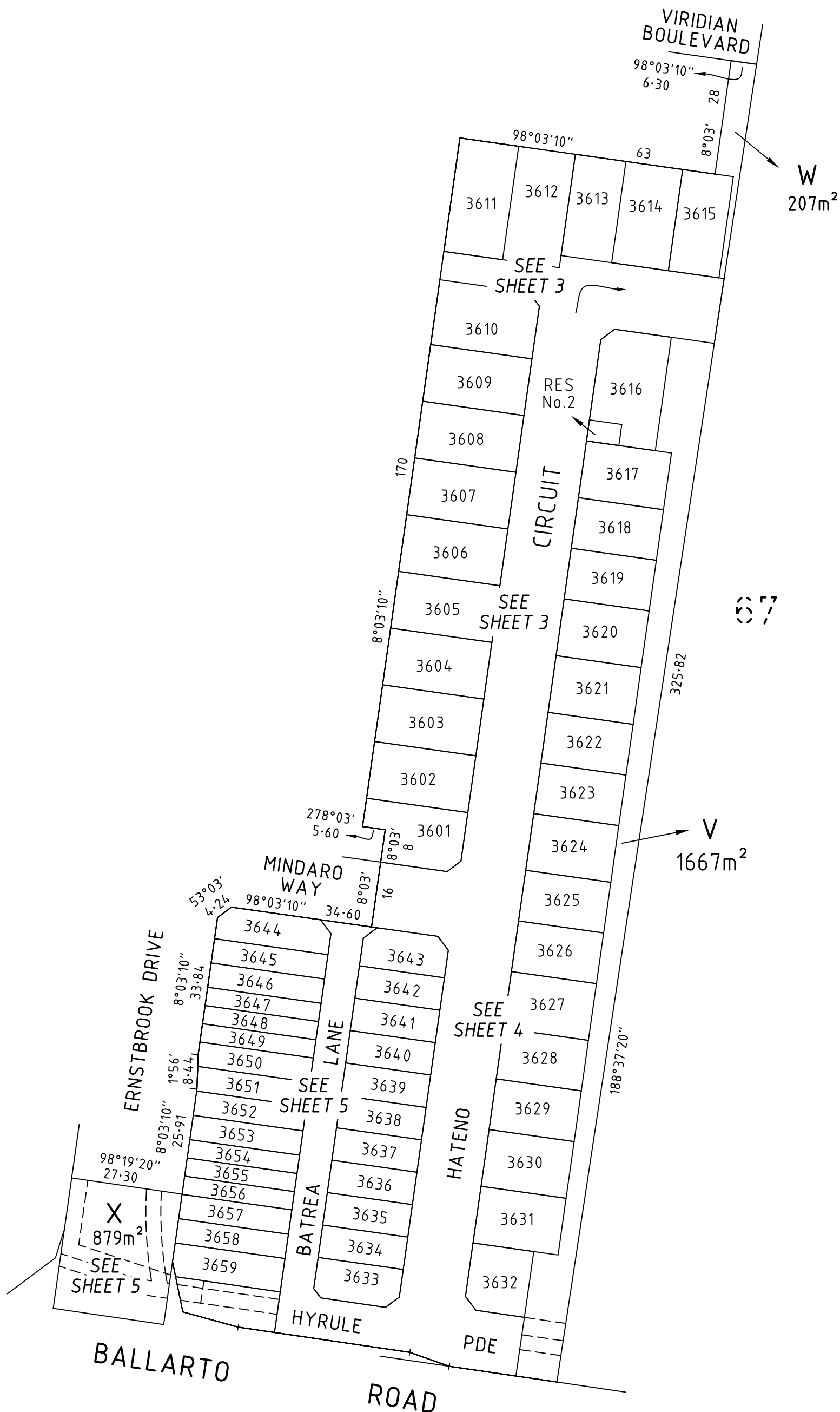

Beveridge Williams
 Development and Infrastructure Consultants
 Melbourne ph : 03 9524 8888
 www.beveridgewilliams.com.au

SURVEYORS REF
2101578/36

SCALE
1 : 1000

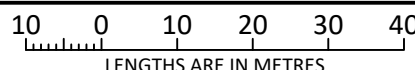

ORIGINAL SHEET
SIZE: A3

SHEET 2

LICENSED SURVEYOR: ADRIAN FREEMAN
 VERSION 8, DATE: 19/05/2026

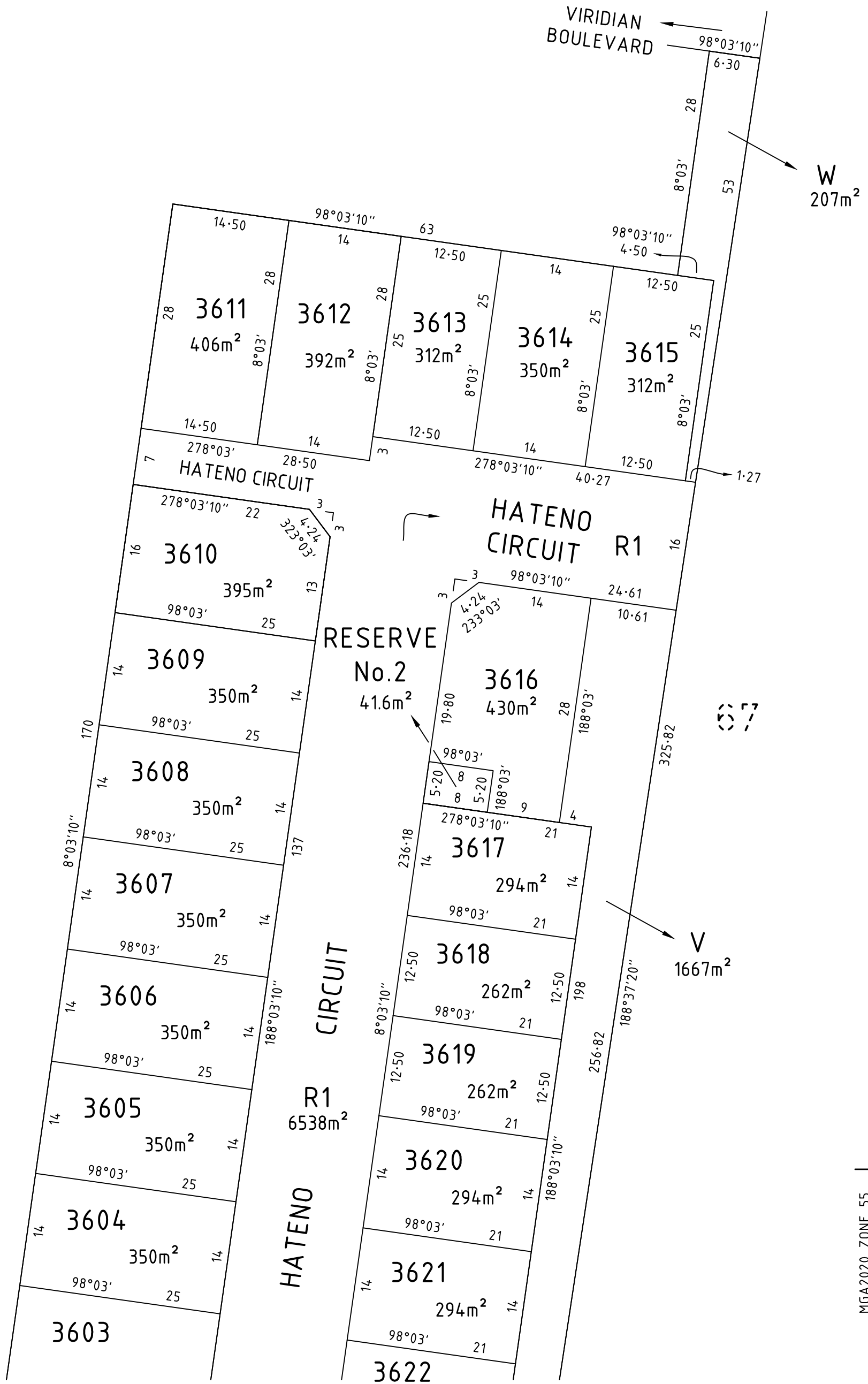

SEE SHEET 4

SEE SHEET 4



PS933897T

MGA2020 ZONE 55



SEE SHEET 3

SEE SHEET 3

3604

3603

3602

3601

3621

3622

3623

3624

3625

3626

3627

3628

3629

3630

3631

3632

MINDARO WAY

WAY

MINDARO WAY R1

DRIVE

3644

3645

3646

3647

3648

3649

3650

3651

3652

3653

3654

3655

3656

3657

3658

3659

RES No.1

R1

SEE SHEET 5

SEE SHEET 5

SEE SHEET 5

SEE SHEET 5

BATREA LANE

HATENO R1

6538m²

HYRULE R1

PARADE ROAD

BALLARTO

V 1667m²

SEE SHEET 5

SEE SHEET 5

SEE SHEET 5

SEE SHEET 5

SURVEYORS REF 2101578/36

SCALE 1 : 500

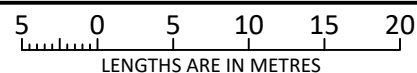

ORIGINAL SHEET SIZE: A3

SHEET 4



Beveridge Williams

Development and Infrastructure Consultants

Melbourne ph : 03 9524 8888

www.beveridgewilliams.com.au

LICENSED SURVEYOR: ADRIAN FREEMAN
VERSION 8, DATE: 19/05/2026

CREATION OF RESTRICTION

THE REGISTERED PROPRIETORS OF THE BURDENED LAND COVENANT WITH THE REGISTERED PROPRIETORS OF THE BENEFITED LAND AS SET OUT IN THE RESTRICTION WITH THE INTENT THAT THE BURDEN OF THE RESTRICTION RUNS WITH AND BINDS THE BURDENED LAND AND THE BENEFIT OF THE RESTRICTION IS ANNEXED TO AND RUNS WITH THE BENEFITED LAND.

RESTRICTION 'A'

LAND TO BENEFIT & TO BE BURDENED:

BURDENED LAND: LOTS 3601 TO 3659 (BOTH INCLUSIVE) ON THIS PLAN

BENEFITING LAND: LOTS 3601 TO 3659 (BOTH INCLUSIVE) ON THIS PLAN

DESCRIPTION OF RESTRICTION:

THE REGISTERED PROPRIETOR OR PROPRIETORS FOR THE TIME BEING OF ANY BURDENED LOT ON THIS PLAN MUST NOT BUILD OR PERMIT ANY OTHER PERSON UNDER ITS CONTROL OR DIRECTION TO:

- 1) CONSTRUCT OR ALLOW TO BE CONSTRUCTED ANY BUILDING, STRUCTURE OR FENCE OTHER THAN A BUILDING, STRUCTURE OR FENCE IN ACCORDANCE WITH THE LATEST COPY OF THE RIVERFIELD SQUARE DESIGN GUIDELINES (INCLUDING ANY AMENDMENTS FROM TIME TO TIME) ENDORSED BY THE CASEY CITY COUNCIL UNDER PLANNING PERMIT No. PA22-0318;
- 2) CONSTRUCT OR ALLOW TO BE CONSTRUCTED ANY BUILDING OR STRUCTURE OUTSIDE A BUILDING ENVELOPE APPLIED TO A LOT ON THE BUILDING ENVELOPE PLAN ENDORSED UNDER PLANNING PERMIT No. PA22-0318 UNLESS ENCROACHMENTS OUTSIDE THE BUILDING ENVELOPE PLAN ARE PERMITTED IN ACCORDANCE WITH THE LATEST RIVERFIELD SQUARE DESIGN GUIDELINES DETAILED IN CONDITION 1.

A COPY OF THE ENDORSED RIVERFIELD SQUARE DESIGN GUIDELINES AND BUILDING ENVELOPES ARE AVAILABLE AT: www.ngdd.com.au

VARIATION:

ANY VARIATION TO THE ENDORSED BUILDING ENVELOPE PLAN OR CONSENT TO BUILD OUTSIDE THE ENDORSED BUILDING ENVELOPE PLAN FOR CONDITION 2 OF RESTRICTION 'A' WHERE ENCROACHMENTS OUTSIDE THE BUILDING ENVELOPE PLAN ARE NOT PERMITTED BY THE LATEST ENDORSED COPY OF THE RIVERFIELD SQUARE DESIGN GUIDELINES WILL REQUIRE APPROVAL FROM THE CASEY CITY COUNCIL AND RIVERFIELD SQUARE DESIGN ASSESSMENT PANEL.

EXPIRY DATE:

THIS RESTRICTION SHALL CEASE TO HAVE EFFECT TEN (10) YEARS AFTER THE DATE OF REGISTRATION OF THIS PLAN.

RESTRICTION 'B'

LAND TO BENEFIT & TO BE BURDENED:

BURDENED LAND: LOTS 3617 TO 3631 (BOTH INCLUSIVE) ON THIS PLAN

BENEFITING LAND: LOTS 3617 TO 3631 (BOTH INCLUSIVE) ON THIS PLAN

DESCRIPTION OF RESTRICTION:

THE REGISTERED PROPRIETOR OR PROPRIETORS FOR THE TIME BEING OF ANY BURDENED LOT ON THIS PLAN OF SUBDIVISION SHALL NOT AT ANY TIME ON THE SAID LOT OR ANY PARTS THEREOF:

- 1) CONSTRUCT OR EXTEND ANY DWELLING OR ALLOW THE CONSTRUCTION OR EXTENSION OF ANY DWELLING THAT DOES NOT COMPLY WITH "TYPE A" OF THE SMALL LOT HOUSING CODE AS INCORPORATED INTO THE CASEY PLANNING SCHEME UNLESS THE CONSTRUCTION OR EXTENSION OF ANY DWELLING HAS BEEN APPROVED BY THE RESPONSIBLE AUTHORITY UNDER THE RELEVANT PLANNING REGULATIONS.

EXPIRY DATE:

THIS RESTRICTION SHALL CEASE TO HAVE EFFECT TEN (10) YEARS AFTER THE DATE OF REGISTRATION OF THIS PLAN.

RESTRICTION 'C'

LAND TO BENEFIT & TO BE BURDENED:

BURDENED LAND: LOTS 3632 to 3659 (BOTH INCLUSIVE) ON THIS PLAN

BENEFITING LAND: LOTS 3632 to 3659 (BOTH INCLUSIVE) ON THIS PLAN

DESCRIPTION OF RESTRICTION:

THE REGISTERED PROPRIETOR OR PROPRIETORS FOR THE TIME BEING OF ANY BURDENED LOT ON THIS PLAN OF SUBDIVISION SHALL NOT AT ANY TIME ON THE SAID LOT OR ANY PARTS THEREOF:

- 1) CONSTRUCT OR EXTEND ANY DWELLING OR ALLOW THE CONSTRUCTION OR EXTENSION OF ANY DWELLING THAT DOES NOT COMPLY WITH "TYPE B" OF THE SMALL LOT HOUSING CODE AS INCORPORATED INTO THE CASEY PLANNING SCHEME UNLESS THE CONSTRUCTION OR EXTENSION OF ANY DWELLING HAS BEEN APPROVED BY THE RESPONSIBLE AUTHORITY UNDER THE RELEVANT PLANNING REGULATIONS.

EXPIRY DATE:

THIS RESTRICTION SHALL CEASE TO HAVE EFFECT TEN (10) YEARS AFTER THE DATE OF REGISTRATION OF THIS PLAN.