

0 2.5 5 10 15 20 Scale 1:500 @ A3
 0 2.5 5 10 15 20 Scale 1:250 @ A1

LEGEND - MARKETING PLAN

- STORMWATER DRAIN, PIT & PROPERTY INLET
- MELBOURNE WATER DRAIN & PIT
- SWALE DRAIN
- SEWER & MAINTENANCE STRUCTURES
- HOUSE DRAIN
- SERVICE CONDUITS
- TACTILE PAVERS
- ELECTRICITY (UNDERGROUND)
- ELECTRICITY (OVERHEAD)
- OPTIC FIBRE
- TELECOMMUNICATIONS
- GAS
- WATER
- RECYCLED WATER
- EXISTING ELECTRICITY (UNDERGROUND)
- EXISTING ELECTRICITY (OVERHEAD)
- EXISTING GAS
- EXISTING OPTIC FIBRE
- EXISTING TELECOMMUNICATIONS
- EXISTING WATER
- EXISTING RECYCLED WATER
- EXISTING STORMWATER DRAIN
- EXISTING SEWER
- EXISTING HOUSE DRAIN
- EXISTING SWALE DRAIN
- EXISTING SURFACE LEVEL
- FINISHED BUILDING LINE LEVEL
- FINISHED RIDGE LINE LEVEL
- TOP OF RETAINING WALL
- BOTTOM OF RETAINING WALL
- RETAINING WALL
- EXISTING RETAINING WALL
- RIDGE LINE
- PERMANENT SURVEY MARK
- TEMPORARY BENCH MARK
- DIRECTION OF FALL
- OVERLAND FLOW
- ALLOTMENT TO BE GRADED EVENLY IN
- DIRECTION OF FALL TO LEVELS INDICATED
- CONCRETE EDGE STRIP WITH SUBSOIL DRAIN
- "NO ROAD" SIGN & BARRIER
- PROPOSED DRIVEWAY
- LIMIT OF WORKS
- EXISTING TREE TO BE REMOVED
- PAVEMENT TREATMENT
- STRUCTURAL FILL > 200mm DEEP
- EX. STRUCTURAL FILL > 200mm DEEP
- LOT HATCHING
- ROAD PAVEMENT
- FOOTPATH
- DRIVEWAY
- INDUSTRIAL STRENGTH DRV / LANWAYS
- NATURE STRIP
- RESERVES
- ELECTRICAL KIOSK
- DRAINAGE RESERVE
- MEDIUM DENSITY LOTS
- MAINTENANCE ACCESS TRACK
- DRY OUT AREA

- NOTES:**
- These plans are preliminary only and have not been approved by Council. They are subject to change without notice and have been provided as a guide only.
 - This plan must be read in conjunction with the Plan of Subdivision. If any discrepancies are identified between the two plans, the Plan of Subdivision takes precedence.
 - Proposed services and connection points shown are preliminary only and subject to authority advice and approval. Vehicle crossing locations shown are subject to Council approval.
 - Existing surface levels refer to the existing surface surveyed by Beveridge Williams & Co Pty Ltd in August 2021.
 - Finished surface levels shown are preliminary only and may be subject to change during design and/or construction.
 - The depth of fill can be determined by calculating the depth between the existing and proposed finished surface levels.
 - Fill depths do not take into account any removal of topsoil, grubbing, or excavation associated with the construction of any temporary or permanent infrastructure within the subdivision.
 - The plan shows the indicative extent of fill greater than 200mm in depth. These extents may be subject to change during design and/or construction. Fill less than 200mm in depth is not shown on this plan.
 - The fill depth shown on this plan is for fill placed during construction of the subdivision whilst the site is under the control of Beveridge Williams & Co Pty Ltd. Beveridge Williams & Co Pty Ltd has no further knowledge or records of any other filling works throughout this subdivision, including prior to the survey being undertaken, or after the completion of construction.
 - Beveridge Williams & Co Pty Ltd will not be liable for any loss or damages incurred or suffered by any party due to the use of the plan or relying on the information contained within the plan.
 - Fill volumes and depths are calculated between the design surface and existing surface, except in areas where standing water was present in the August 2021 survey. In areas where standing water was present in 2021, existing surface levels are shown to an additional survey completed during construction. Areas of standing water will be dewatered, desludged and filled under level 1 supervision.
 - In areas where standing water has been dewatered, desludged, and filled under level 1 supervision the approximate fill depths have been outlined in the above table.

WARNING
BWARE OF UNDERGROUND SERVICES
 The locations of underground services are approximate only and their exact position should be proven on site.
 No guarantee is given that all existing services are shown.
 Locate all underground services before commencement of works
BEFORE YOU DIG
 www.bywida.com.au



0 5 10 20 30 40 Scale 1:1000 @ A3
 0 5 10 20 30 40 Scale 1:500 @ A1

SERVICE OFFSET TABLE

Location	Gas		ND - Water		Water		Electricity		Telecommunication		Sewer	
	Side	Offset (m)	Side	Offset (m)	Side	Offset (m)	Side	Offset (m)	Side	Offset (m)	Side	Offset (m)
MINDAROW WAY	N	2.10	N	2.50	N	2.95	S	2.60	S	1.90	-	-
HATENO CIRCUIT (N-S)	W	2.10	W	2.50	W	2.95	E	2.60	E	1.90	E	1.00
HATENO CIRCUIT (E-W)	N	2.10	N	2.50	N	2.95	S	2.60	S	1.90	-	-
HYRULE PARADE	N	2.10	N	2.60	N	3.20	S	1.55	S	0.85	N	1.30
BATREA LANE (N-S)	-	-	-	-	-	-	W	2.20	-	-	E	2.50
BATREA LANE (E-W)	-	-	N	1.00	N	1.60	N	2.40	-	-	-	-

NOTE: STREET TREES ARE TO BE PLANTED IN THE CENTRE OF ALL NATURE STRIPS

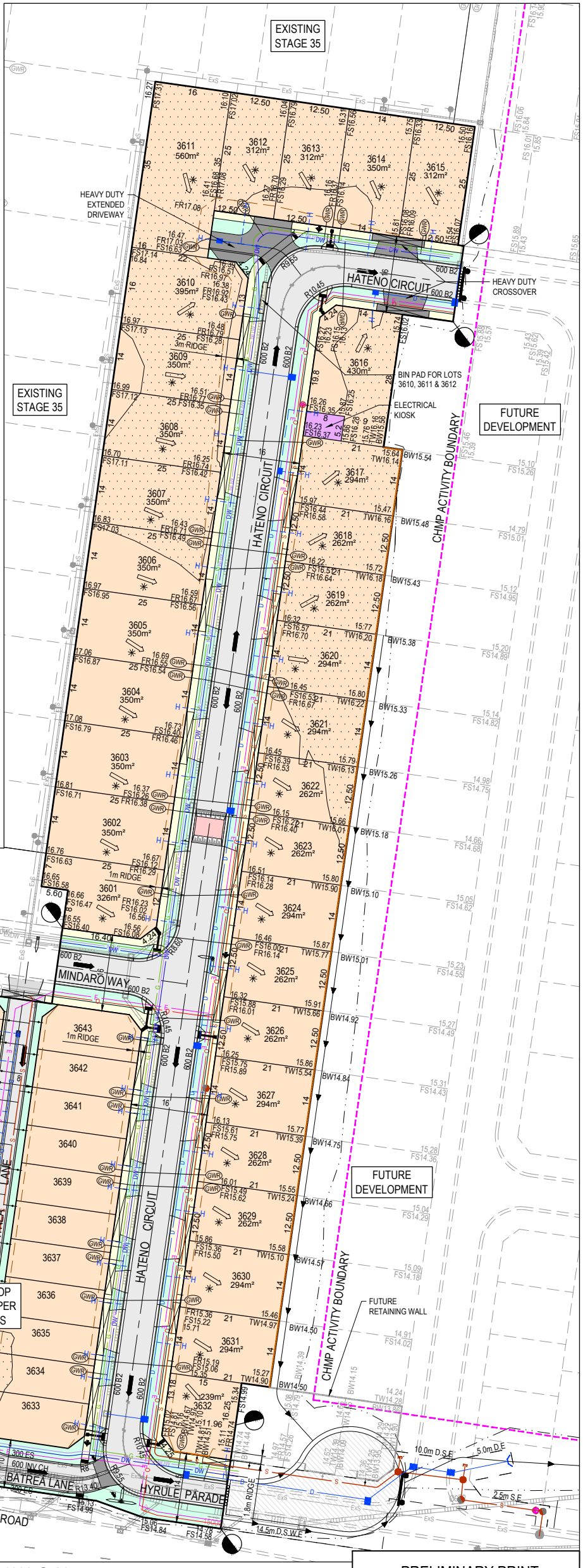

0 5 10 20 30 40 Scale 1:1000 @ A3
 0 5 10 20 30 40 Scale 1:500 @ A1

© COPYRIGHT All rights reserved
 Beveridge Williams & Co. Pty Ltd has granted a licence to the principle to use this document for its intended purpose. No unauthorised copying is permitted.

P9	LOT 3632 WALL UPDATE	17.04.2026	KLW	AP
P8	LOTS 3611 & 3612 WATER TAPPING UPDATED	01.04.2026	AJ	AP
P7	GAS INCLUDED	24.03.2026	KLW	AP
P6	ELECTRICAL KIOSK ADDED	11.03.2026	KLW	AP
P5	3632 HD MOVED & ELEC ADDED TO BATREA LANE	23.02.2026	KLW	AP

BROWN COMMUNITIES **Riverfield square CLYDE**

BW Beveridge Williams
 Development & Infrastructure Consultants
 1 Glenferrie Road Malvern VIC 3144
 ph: 03 9524 8888
 www.beveridgewilliams.com.au

Project Details: RIVERFIELD SQUARE STAGE 36 CITY OF CASEY
 Drawing Title: MARKETING PLAN (SHEET 1 OF 2)

Sheet 01 of 02
 Scale: AS SHOWN
 Project Ref: 2101578 Stage No: 36 Drawing No: M01 Rev: P9

Q:\me\jobs\data\2101578 - Di Renzo - 1615 Ballarto Road, Clyde_Eng\Stage 36\Drawings\2101578-36-M.dwg

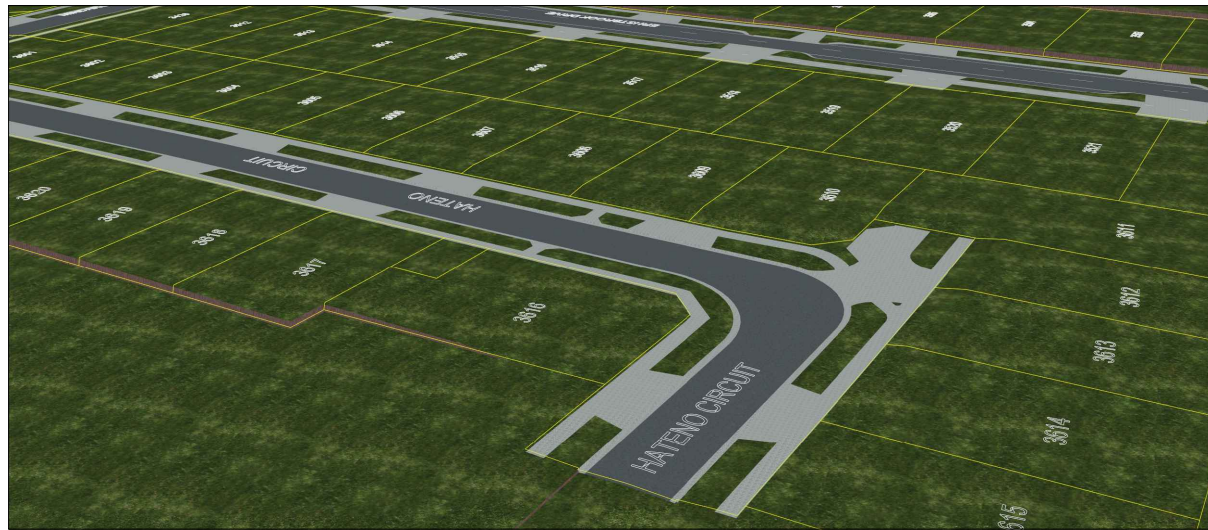

DIGITAL RENDER - LOCATION 1
LOT 3615 LOOKING SOUTH WEST



DIGITAL RENDER - LOCATION 2
LOT 3623 LOOKING SOUTH WEST

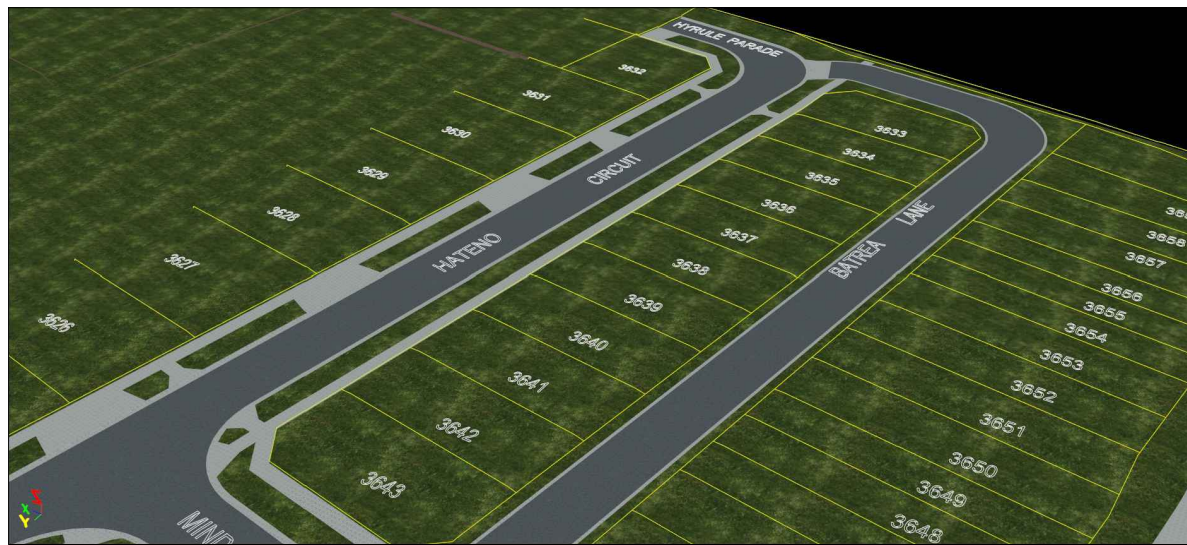

DIGITAL RENDER - LOCATION 3
LOT 3643 LOOKING SOUTH EAST



DIGITAL RENDER - LOCATION 4
LOT 3642 LOOKING NORTH EAST

WARNING
Beware of Underground Services
The locations of underground services are approximate only and their exact position should be proven on site.
No guarantee is given that all existing services are shown.
Locate all underground services before commencement of works
BEFORE YOU DIG
www.byda.com.au

PRELIMINARY PRINT
NOT FOR CONSTRUCTION

© COPYRIGHT All rights reserved Beveridge Williams & Co. Pty Ltd has granted a licence to the principle to use this document for its intended purpose. No unauthorised copying is permitted						
PS	LOT 3632 WALL UPDATE	17.04.2026	KLW	AP		
REV	DESCRIPTION	DATE	DRN	APP	REV	DESCRIPTION



Designed A.JOHN
Date 12.09.2025
Drawn A.JOHN
Checked A.PHILALAY
Date 12.09.2025
Approved S.FALKENSTEIN
Reg. No. PE0016296
Date 15.09.2025
PS Number PS933897T

BW Beveridge Williams
Development & Infrastructure Consultants
1 Glenferrie Road
Malvern VIC 3144
ph: 03 9524 8888
www.beveridgewilliams.com.au

Project Details
RIVERFIELD SQUARE
STAGE 36
CITY OF CASEY
Drawing Title
MARKETING PLAN
(SHEET 2 OF 2)

Sheet 02 of 02
Scale
NOT TO SCALE
Project Ref 2101578
Stage No 36
Drawing No M02
Rev P5

G:\me\jobs\stage 2101578 - Di Renzo - 1675 Ballarto Road, Clyde\Eng\Stage 36\Drawings\2101578-36-M.dwg