

City of Casey

Approved By: **Irshad Ghazi**
Planning Ref: **PA22-0318**
File No: **SEng00025/25**
Council Ref: **R6327**
Date : **25/09/2025**

Approval subject to below conditions:

· Works are to be carried out in accordance with an approved Environmental Management Plan (EMP) and Traffic Management Plan (TMP).

· Relevant service authorities notification and approval is obtained.

· Before starting any work, the contractor must contact Council's Construction Supervision Team on 9705 5200 to arrange Council supervision of the works.

· PDF copy of the "As-constructed" engineering plans must be submitted to engineeringplans@casey.vic.gov.au with references to Council reference numbers.

· A CCTV report must be submitted to the Council supervisor and SubdivisionsConstruction@casey.vic.gov.au for all drainage lines prior to issue of practical completion.

· As-constructed plans and asset information (A-SPEC format) must be provided to Council's satisfaction before statement of compliance will be issued. Grid Coordinates must be MGA Zone 55 (GDA 2020).



ISSUED FOR
CONSTRUCTION

© COPYRIGHT All rights reserved
Beveridge Williams & Co. Pty Ltd has granted a licence to the principle to use this document for its intended purpose.
No unauthorised copying is permitted

REV	DESCRIPTION	DATE	DRN.	APP.	REV	DESCRIPTION	DATE	DRN.	APP.
B	ROAD NAME AMENDED	08.08.25	M.F.J.	S.F.					
A	ISSUED FOR CONSTRUCTION	07.07.25	M.F.J.	S.F.					



Designed	K.LIM WAN
Date	17.02.2025
Drawn	L.SUTHERLAND
Checked	S.YOUNG
Date	17.02.2025
Approved	S.YOUNG
Reg. No.	PE0006009
Date	17.02.2025
PS Number	PS927179L

BW Beveridge Williams
Development & Infrastructure Consultants
1 Glenferrie Road
Malvern VIC 3144
ph: 03 9524 8888
www.beveridgewilliams.com.au

Project Details	RIVERFIELD SQUARE STAGE 32 CITY OF CASEY
Drawing Title	TYPICAL ROAD CROSS SECTIONS

Sheet 02 of 18

Scale
1:100 @ A1

Project Ref	Stage No	Drawing No	Rev
2101578	32	002	B

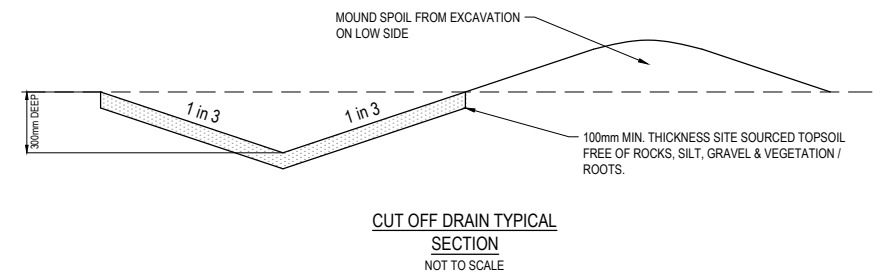
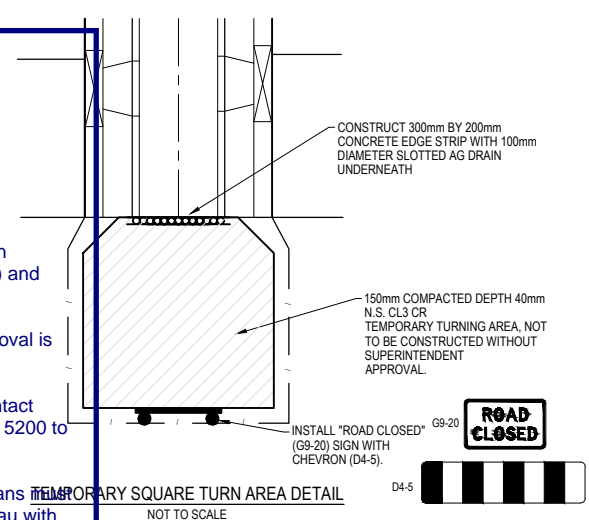
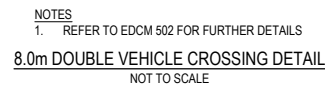
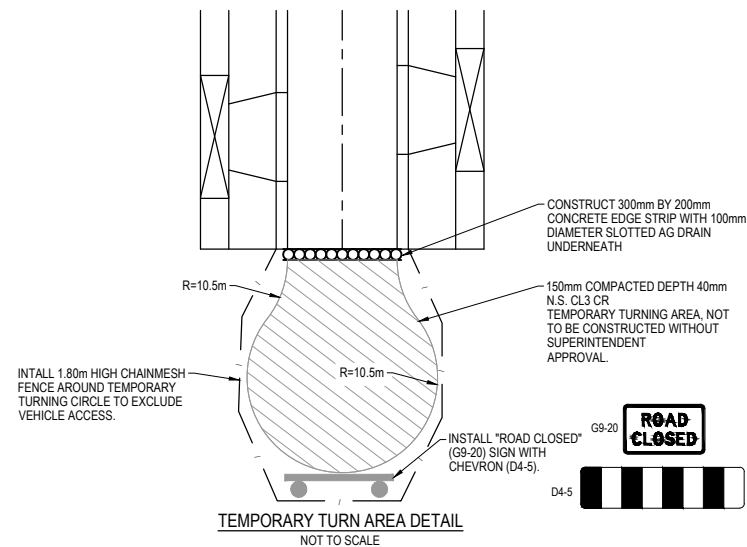

City of Casey

Approved By: **Irshad Ghazi**
Planning Ref: **PA22-0318**
File No: **SEng00025/25**
Council Ref: **R6327**
Date : **25/09/2025**

Approval subject to below conditions:

- Work to be carried out in accordance with an approved Environmental Management Plan (EMP) and Traffic Management Plan (TMP).
- Relevant service authorities notification and approval is obtained.
- Before starting any work, the contractor must contact Council's Construction Supervision Team on 9705 5200 to arrange Council supervision of the works.
- PDF copy of the "As-constructed" engineering plans **TEMPOR** be submitted to engineeringplans@casey.vic.gov.au with references to Council reference numbers.
- A CCTV report must be submitted to the Council supervisor and SubdivisionsConstruction@casey.vic.gov.au for all drainage lines prior to issue of practical completion.
- As-constructed plans and asset information (A-SPEC format) must be provided to Council's satisfaction before statement of compliance will be issued. Grid Coordinates must be MGA Zone 55 (GDA 2020).

ISSUED FOR
CONSTRUCTION

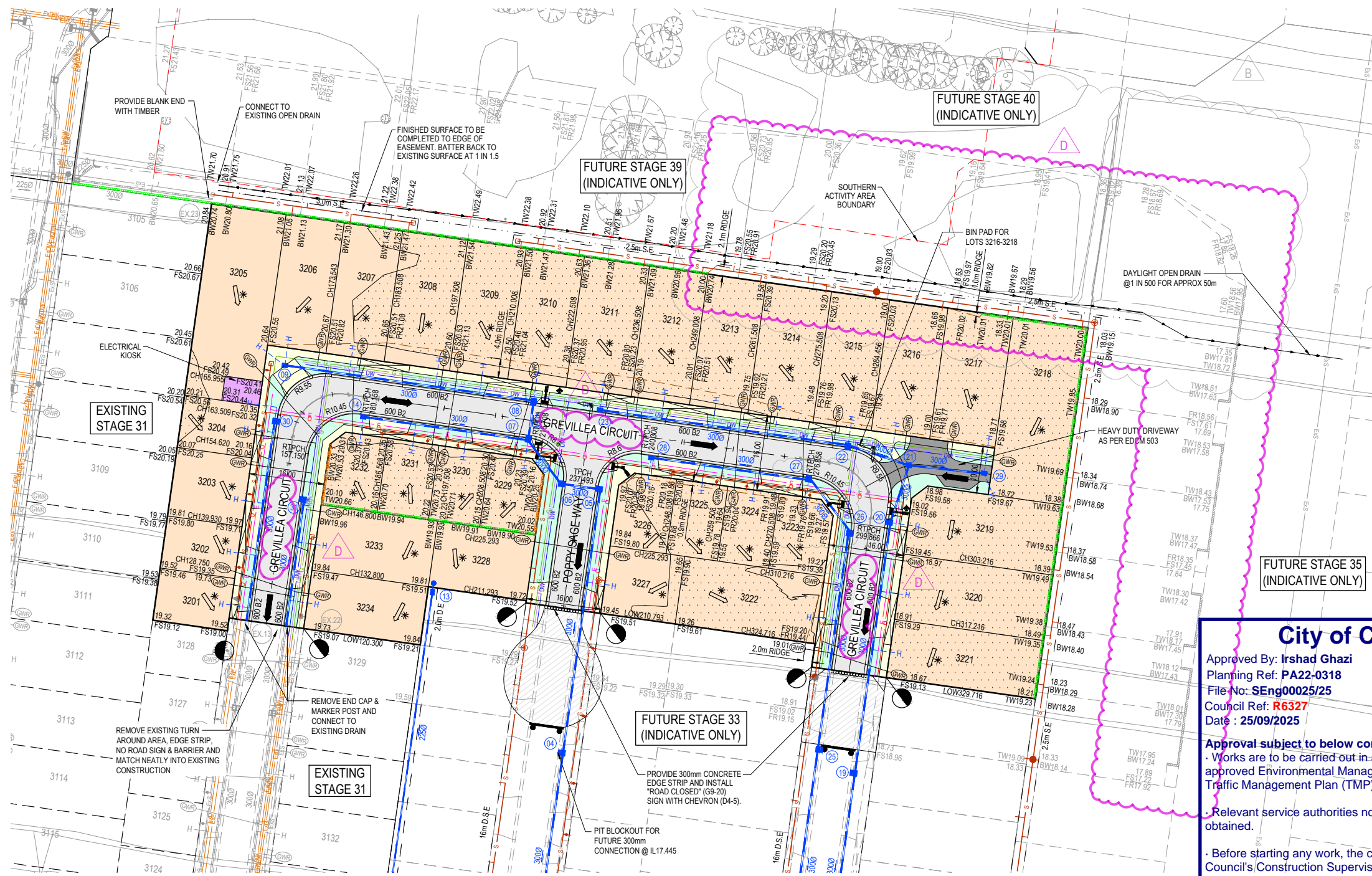

LEGEND - LAYOUT PLAN

- STORMWATER DRAIN, PIT & PROPERTY INLET
- MELBOURNE WATER DRAIN & PIT
- SWALE DRAIN
- SEWER & MAINTENANCE STRUCTURES
- HOUSE DRAIN
- SERVICE CONDUITS
- TACTILE PAVERS (INDICATIVE ONLY)
- ELECTRICITY (UNDERGROUND)
- ELECTRICITY (OVERHEAD)
- OPTIC FIBRE
- TELECOMMUNICATIONS
- GAS
- WATER
- RECYCLED WATER
- EXISTING ELECTRICITY (UNDERGROUND)
- EXISTING ELECTRICITY (OVERHEAD)
- EXISTING GAS
- EXISTING OPTIC FIBRE
- EXISTING TELECOMMUNICATIONS
- EXISTING WATER
- EXISTING RECYCLED WATER
- EXISTING STORMWATER DRAIN
- EXISTING MELBOURNE WATER DRAIN
- EXISTING SEWER
- EXISTING HOUSE DRAIN
- EXISTING SWALE DRAIN
- EXISTING SURFACE LEVEL
- FINISHED BUILDING LINE LEVEL
- FINISHED RIDGE LINE LEVEL
- TOP OF RETAINING WALL
- BOTTOM OF RETAINING WALL
- RIDGE LINE
- MASS ROCK RETAINING WALL
- CONCRETE RETAINING WALL
- EXISTING RETAINING WALL
- ZERO LOT LINES
- PAVEMENT TREATMENT
- STRUCTURAL FILL > 200mm DEEP
- EX. STRUCTURAL FILL > 200mm DEEP
- EX. WATER FEATURE / DAM
- DIRECTION OF FALL
- OVERLAND FLOW
- ALLOTMENT TO BE GRADED EVENLY IN
- DIRECTION OF FALL TO LEVELS INDICATED
- CONCRETE EDGE STRIP WITH SUBSOIL DRAIN
- "NO ROAD" SIGN & BARRIER
- LIMIT OF WORKS
- EXISTING TREE TO BE REMOVED
- PERMANENT SURVEY MARK
- TEMPORARY BENCH MARK
- PROPOSED DRIVEWAY
- TREE PROTECTION ZONE (TPZ)

City of Casey

Approved By: **Irshad Ghazi**
Planning Ref: **PA22-0318**
File No: **SEng00025/25**
Council Ref: **R6327**
Date: **25/09/2025**

Approval subject to below conditions:

- Works are to be carried out in accordance with an approved Environmental Management Plan (EMP) and Traffic Management Plan (TMP).
- Relevant service authorities notification and approval is obtained.
- Before starting any work, the contractor must contact Council's Construction Supervision Team on 9705 5200 to arrange Council supervision of the works.
- PDF copy of the "As-constructed" engineering plans must be submitted to engineeringplans@casey.vic.gov.au with references to Council reference numbers.
- A CCTV report must be submitted to the Council supervisor and SubdivisionsConstruction@casey.vic.gov.au for all drainage lines prior to issue of practical completion.
- As-constructed plans and asset information (A-SPEC format) must be provided to Council's satisfaction before statement of compliance will be issued. Grid Coordinates must be MGA Zone 55 (GDA 2020).

LEGEND:

- PAVEMENT TREATMENT
- STRUCTURAL FILL > 200mm DEEP
- EX. STRUCTURAL FILL > 200mm DEEP
- LOT HATCHING
- ROAD PAVEMENT
- FOOTPATH
- DRIVEWAY
- INDUSTRIAL STRENGTH DRV / LANEWAYS
- NATURE STRIP
- RESERVES
- ELECTRICAL KIOSK
- DRAINAGE RESERVE
- MEDIAN DENSITY LOTS
- MAINTENANCE ACCESS TRACK
- DRY OUT AREA

WARNING
BWARE OF UNDERGROUND SERVICES

The locations of underground services are approximate only and their exact position should be proven on site.
No guarantee is given that all existing services are shown.
Locate all underground services before commencement of works

DIAL 1100 BEFORE YOU DIG

www.1100.com.au

NOTE: DOUBLE DRIVEWAYS ARE TO BE 8m WIDE, REFER TO DWG 003

SERVICE OFFSET TABLE

Location	Gas		ND - Water		Water		Electricity		Telecommunication		Sewer	
	Side	Offset (m)	Side	Offset (m)	Side	Offset (m)	Side	Offset (m)	Side	Offset (m)	Side	Offset (m)
GREVILLEA CIRCUIT (3201-3204)	EAST	2.10	EAST	2.50	EAST	2.95	WEST	2.50	WEST	1.85	W & E	1.3 & 1.0
GREVILLEA CIRCUIT (3206-3215)	NORTH	2.10	NORTH	2.50	NORTH	2.95	SOUTH	2.50	SOUTH	1.85	S	1.3
GREVILLEA CIRCUIT (3219-3221)	WEST	2.10	WEST	2.50	WEST	2.95	EAST	2.60	EAST	1.85	W	1.0
POPPY SAGE WAY	WEST	2.10	WEST	2.50	WEST	2.95	EAST	2.50	EAST	1.85	W & E	1.0 & 1.3

NOTE: STREET TREES ARE TO BE PLANTED IN THE CENTRE OF ALL NATURE STRIPS

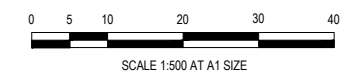

ISSUED FOR CONSTRUCTION

© COPYRIGHT All rights reserved Beveridge Williams & Co. Pty Ltd has granted a licence to the principle to use this document for its intended purpose. No unauthorised copying is permitted											
D	ROAD NAME AMENDED	08.08.25	M.F.J.	S.F.							
C	LOT 3223 AND PITS 2627 UPDATED	29.07.25	AP	SF							
B	LOT BOUNDARIES UPDATED FOR STAGES 35 & 40	16.07.25	KLW	SF							
A	ISSUED FOR CONSTRUCTION	07.07.25	M.F.J.	S.F.							
REV	DESCRIPTION	DATE	DRN.	APP.	REV	DESCRIPTION	DATE	DRN.	APP.		

BROWN COMMUNITIES

Riverfield square CLYDE

BW Beveridge Williams
Development & Infrastructure Consultants
1 Glenferrie Road
Malvern VIC 3144
ph: 03 9524 8888
www.beveridgewilliams.com.au

Project Details
RIVERFIELD SQUARE
STAGE 32
CITY OF CASEY
Drawing Title
LAYOUT PLAN
(SHEET 1 OF 2)

Sheet 04 of 18
Scale 1:500 @ A1
Project Ref 2101578 Stage No 32 Drawing No 010 Rev D

FOR CONTINUATION SEE SHEET 2101578-32-010

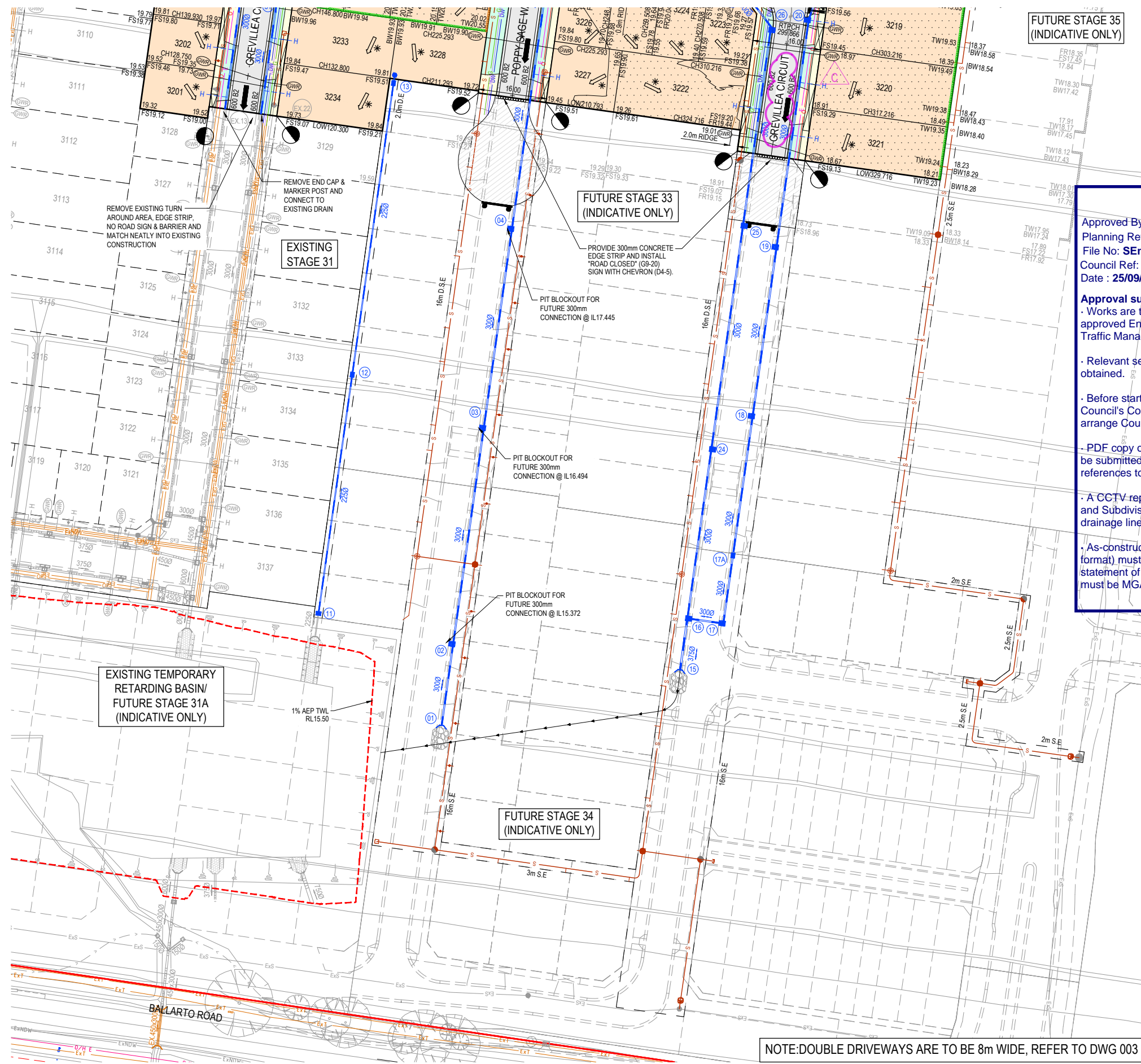

FUTURE STAGE 35
(INDICATIVE ONLY)

City of Casey

Approved By: **Irshad Ghazi**
Planning Ref: **PA22-0318**
File No: **SEng00025/25**
Council Ref: **R6327**
Date : **25/09/2025**

Approval subject to below conditions:

- Works are to be carried out in accordance with an approved Environmental Management Plan (EMP) and Traffic Management Plan (TMP).
- Relevant service authorities notification and approval is obtained.
- Before starting any work, the contractor must contact Council's Construction Supervision Team on 9705 5200 to arrange Council supervision of the works.
- PDF copy of the "As-constructed" engineering plans must be submitted to engineeringplans@casey.vic.gov.au with references to Council reference numbers.
- A CCTV report must be submitted to the Council supervisor and SubdivisionsConstruction@casey.vic.gov.au for all drainage lines prior to issue of practical completion.
- As-constructed plans and asset information (A-SPEC format) must be provided to Council's satisfaction before statement of compliance will be issued. Grid Coordinates must be MGA Zone 55 (GDA 2020).

LEGEND - LAYOUT PLAN

- STORMWATER DRAIN, PIT & PROPERTY INLET
- MELBOURNE WATER DRAIN & PIT
- SWALE DRAIN
- SEWER & MAINTENANCE STRUCTURES
- HOUSE DRAIN
- SERVICE CONDUITS
- TACTILE PAVERS (INDICATIVE ONLY)
- ELECTRICITY (UNDERGROUND)
- ELECTRICITY (OVERHEAD)
- OPTIC FIBRE
- TELECOMMUNICATIONS
- GAS
- WATER
- RECYCLED WATER
- EXISTING ELECTRICITY (UNDERGROUND)
- EXISTING ELECTRICITY (OVERHEAD)
- EXISTING GAS
- EXISTING OPTIC FIBRE
- EXISTING TELECOMMUNICATIONS
- EXISTING WATER
- EXISTING RECYCLED WATER
- EXISTING STORMWATER DRAIN
- EXISTING MELBOURNE WATER DRAIN
- EXISTING SEWER
- EXISTING HOUSE DRAIN
- EXISTING SWALE DRAIN
- EXISTING SURFACE LEVEL
- FINISHED BUILDING LINE LEVEL
- FINISHED RIDGE LINE LEVEL
- TOP OF RETAINING WALL
- BOTTOM OF RETAINING WALL
- RIDGE LINE
- MASS ROCK RETAINING WALL
- CONCRETE RETAINING WALL
- EXISTING RETAINING WALL
- ZERO LOT LINES
- PAVEMENT TREATMENT
- STRUCTURAL FILL > 200mm DEEP
- EX. STRUCTURAL FILL > 200mm DEEP
- EX. WATER FEATURE / DAM
- DIRECTION OF FALL
- OVERLAND FLOW
- ALLOTMENT TO BE GRADED EVENLY IN
- DIRECTION OF FALL TO LEVELS INDICATED
- CONCRETE EDGE STRIP WITH SUBSOIL DRAIN
- "NO ROAD" SIGN & BARRIER
- LIMIT OF WORKS
- EXISTING TREE TO BE REMOVED
- PERMANENT SURVEY MARK
- TEMPORARY BENCH MARK
- PROPOSED DRIVEWAY
- TREE PROTECTION ZONE (TPZ)

LEGEND:

- PAVEMENT TREATMENT
- STRUCTURAL FILL > 200mm DEEP
- EX. STRUCTURAL FILL > 200mm DEEP
- LOT HATCHING
- ROAD PAVEMENT
- FOOTPATH
- DRIVEWAY
- INDUSTRIAL STRENGTH DRV / LANEWAYS
- NATURE STRIP
- RESERVES
- ELECTRICAL KIOSK
- DRAINAGE RESERVE
- MEDIAN DENSITY LOTS
- MAINTENANCE ACCESS TRACK
- DRY OUT AREA

WARNING

BEWARE OF UNDERGROUND SERVICES

The locations of underground services are approximate only and their exact position should be proven on site.
No guarantee is given that all existing services are shown.
Locate all underground services before commencement of works
DIAL 1100 BEFORE YOU DIG
www.1100.com.au

ISSUED FOR
CONSTRUCTION

© COPYRIGHT All rights reserved
Beveridge Williams & Co. Pty Ltd has granted a licence to the principle to use this document for its intended purpose.
No unauthorised copying is permitted

REV	DESCRIPTION	DATE	DRN.	APP.	REV	DESCRIPTION	DATE	DRN.	APP.
C	ROAD NAME AMENDED	08.08.25	M.F.J.	S.F.					
B	PIT 17A ADDED	16.07.25	KLW	SF					
A	ISSUED FOR CONSTRUCTION	07.07.25	M.F.J.	S.F.					



Designed
Date
Drawn
Checked
Date
Approved
Reg. No.
Date
PS Number

K.LIM WAN
17.02.2025
L.SUTHERLAND
17.02.2025
S.YOUNG
17.02.2025
S.YOUNG
PE0006609
17.02.2025
PS927179L

BW Beveridge Williams
Development & Infrastructure Consultants
1 Glenferrie Road
Malvern VIC 3144
ph: 03 9524 8888
www.beveridgewilliams.com.au

Project
Details
RIVERFIELD SQUARE
STAGE 32
CITY OF CASEY
Drawing
Title
LAYOUT PLAN
(SHEET 2 OF 2)

Sheet 05 of 18

Scale
1:500 @ A1

Project Ref	Stage No	Drawing No	Rev
2101578	32	011	C

K:\Jobs\2101578 - Di Renzo - 1675 Ballarto Road, Clyde\Eng\Stage 32\Drawings\2101578-32-010-LAY.dwg

LEGEND	
	EXISTING SURFACE
	DESIGN LINE
	FUTURE DESIGN LINE
	EXISTING SURFACE AT RIGHT BOUNDARY
	RIGHT LIP OF KERB
	EXISTING SURFACE AT LEFT BOUNDARY
	LEFT LIP OF KERB

City of Casey

Approved By: **Irshad Ghazi**
Planning Ref: **PA22-0318**
File No: **SEng00025/25**
Council Ref: **R6327**
Date : **25/09/2025**

Approval subject to below conditions:

- Works are to be carried out in accordance with an approved Environmental Management Plan (EMP) and Traffic Management Plan (TMP).
- Relevant service authorities notification and approval is obtained.
- Before starting any work, the contractor must contact Council's Construction Supervision Team on 9705 5200 to arrange Council supervision of the works.
- PDF copy of the "As-constructed" engineering plans must be submitted to engineeringplans@casey.vic.gov.au with references to Council reference numbers.
- A CCTV report must be submitted to the Council supervisor and SubdivisionsConstruction@casey.vic.gov.au for all drainage lines prior to issue of practical completion.
- As-constructed plans and asset information (A-SPEC format) must be provided to Council's satisfaction before statement of compliance will be issued. Grid Coordinates must be MGA Zone 55 (GDA 2020).

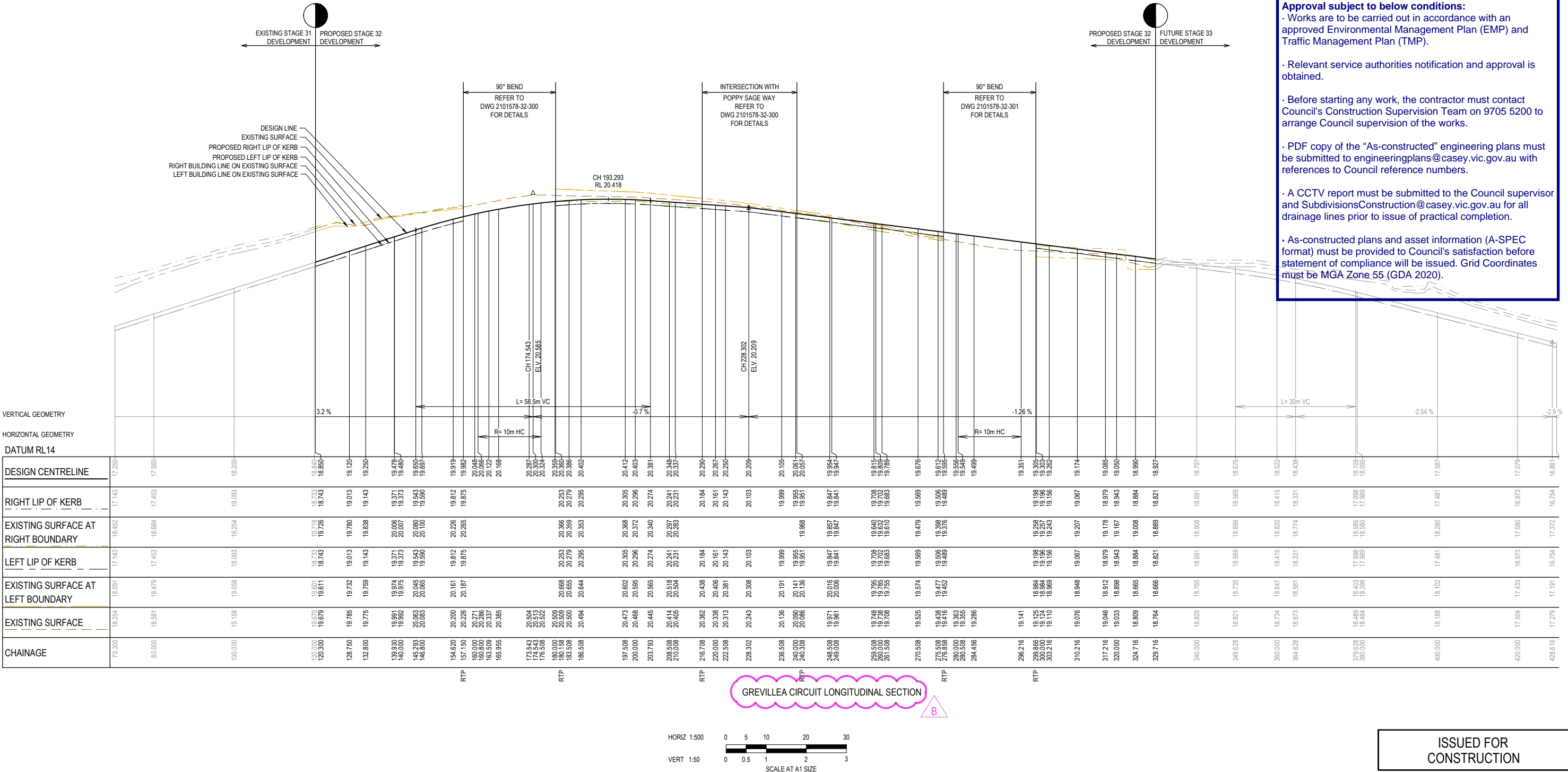

© COPYRIGHT All rights reserved Beveridge Williams & Co. Pty Ltd has granted a licence to the principle to use this document for its intended purpose. No unauthorised copying is permitted					
B	ROAD NAME AMENDED	08.08.25	M.F.J.	S.F.	
A	ISSUED FOR CONSTRUCTION	07.07.25	M.F.J.	S.F.	
REV	DESCRIPTION	DATE	DRN.	APP.	REV

Designed
Date
Drawn
Checked
Date
Approved
Reg. No.
Date
PS Number

KLIM WAN
17.02.2025
L.SUTHERLAND
S.YOUNG
17.02.2025
S.YOUNG
PE0006608
17.02.2025
PS927119L

Development & Infrastructure Consultants
1 Glenferrie Road
Malvern VIC 3144
ph: 03 9524 8888
www.beveridgewilliams.com.au

Project Details
RIVERFIELD SQUARE
STAGE 32
CITY OF CASEY

Drawing Title
ROAD LONGITUDINAL SECTIONS
GREVILLEA CIRCUIT

Sheet 06 of 18

Scale
1:500 H 1:50 V @ A1

Project Ref
2101578

Stage No
32

Drawing No
100

Rev
B

LEGEND	
	EXISTING SURFACE
	DESIGN LINE
	FUTURE DESIGN LINE
	EXISTING SURFACE AT RIGHT BOUNDARY
	RIGHT LIP OF KERB
	EXISTING SURFACE AT LEFT BOUNDARY
	LEFT LIP OF KERB

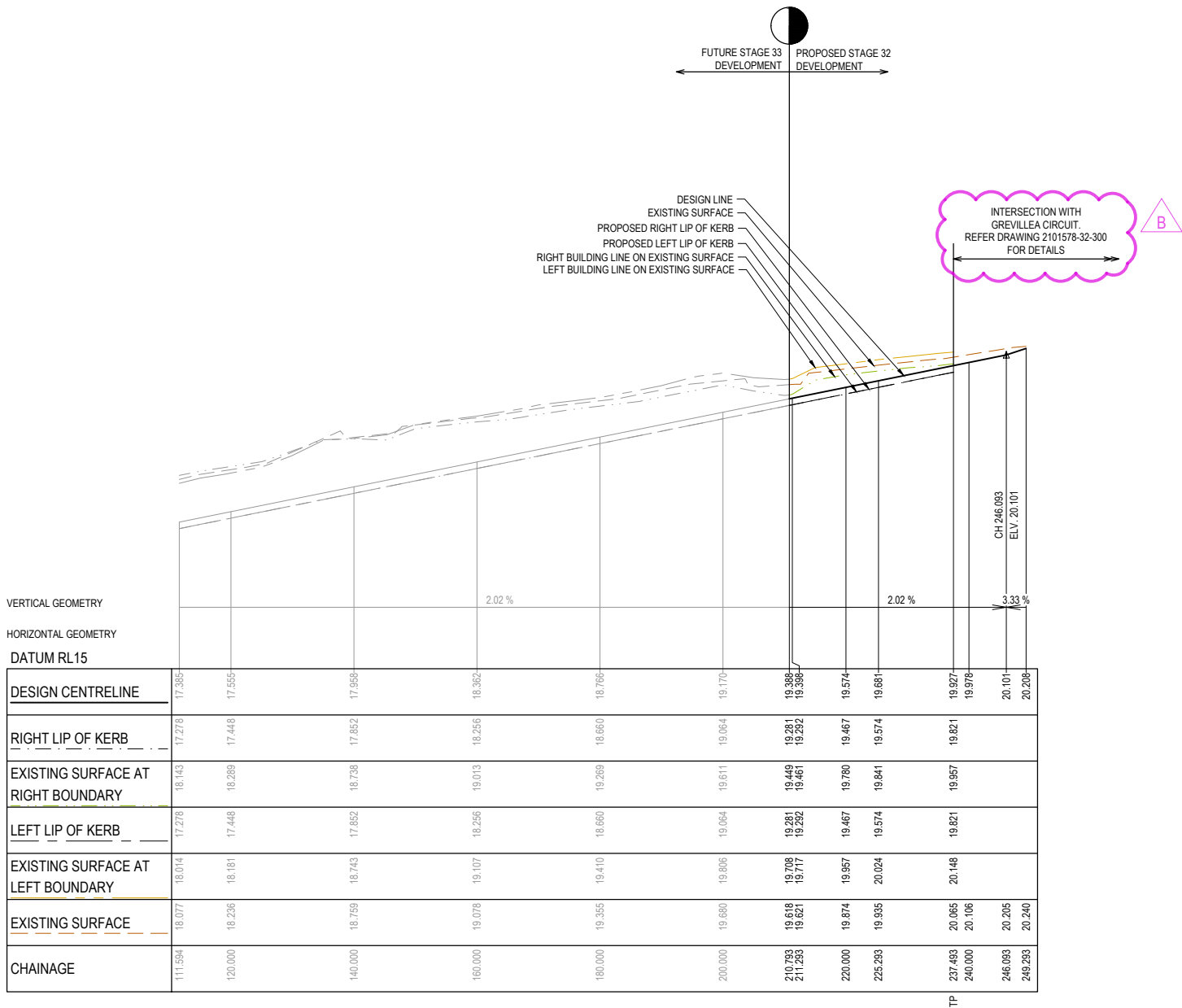

POPPY SAGE WAY LONGITUDINAL SECTION

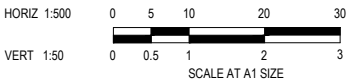

City of Casey

Approved By: **Irshad Ghazi**
Planning Ref: **PA22-0318**
File No: **SEng00025/25**
Council Ref: **R6327**
Date : **25/09/2025**

Approval subject to below conditions:

- Works are to be carried out in accordance with an approved Environmental Management Plan (EMP) and Traffic Management Plan (TMP).
- Relevant service authorities notification and approval is obtained.
- Before starting any work, the contractor must contact Council's Construction Supervision Team on 9705 5200 to arrange Council supervision of the works.
- PDF copy of the "As-constructed" engineering plans must be submitted to engineeringplans@casey.vic.gov.au with references to Council reference numbers.
- A CCTV report must be submitted to the Council supervisor and SubdivisionsConstruction@casey.vic.gov.au for all drainage lines prior to issue of practical completion.
- As-constructed plans and asset information (A-SPEC format) must be provided to Council's satisfaction before statement of compliance will be issued. Grid Coordinates must be MGA Zone 55 (GDA 2020).

ISSUED FOR
CONSTRUCTION

© COPYRIGHT All rights reserved
Beveridge Williams & Co. Pty Ltd has granted a licence to the principle to use this document for its intended purpose.
No unauthorised copying is permitted

REV	DESCRIPTION	DATE	DRN.	APP.	REV	DESCRIPTION	DATE	DRN.	APP.
B	ROAD NAME AMENDED	08.08.25	M.F.J.	S.F.					
A	ISSUED FOR CONSTRUCTION	07.07.25	M.F.J.	S.F.					



Designed
Date
17.02.2025
Drawn
L.SUTHERLAND
Checked
Date
17.02.2025
S.YOUNG
Approved
Reg. No.
PE0005609
Date
17.02.2025
PS Number
PS927179L

BW Beveridge Williams
Development & Infrastructure Consultants
1 Glenferrie Road
Malvern VIC 3144
ph: 03 9524 8888
www.beveridgewilliams.com.au

Project
Details
RIVERFIELD SQUARE
STAGE 32
CITY OF CASEY
Drawing
Title
ROAD LONGITUDINAL SECTIONS
POPPY SAGE WAY

Sheet 07 of 18

Scale
1:500 H 1:50 V @ A1

Project Ref	Stage No	Drawing No	Rev
2101578	32	101	B

City of Casey

Approved By: **Irshad Ghazi**
Planning Ref: **PA22-0318**
File No: **SEng00025/25**
Council Ref: **R6327**
Date : **25/09/2025**

Approval subject to below conditions:

· Works are to be carried out in accordance with an approved Environmental Management Plan (EMP) and Traffic Management Plan (TMP).

· Relevant service authorities notification and approval is obtained.

· Before starting any work, the contractor must contact Council's Construction Supervision Team on 9705 5200 to arrange Council supervision of the works.

· PDF copy of the "As-constructed" engineering plans to be submitted to engineeringplans@casey.vic.gov.au with references to Council reference numbers.

· A CCTV report must be submitted to the Council supervisor and Subdivisions Construction@casey.vic.gov.au for all drainage lines prior to issue of practical completion.

· As-constructed plans and asset information (A-SPEC format) must be provided to Council's satisfaction before statement of compliance will be issued. Grid Coordinates must be MGA Zone 55 (GDA 2020).

STRUCTURAL FILL REQUIRED UNDER PAVEMENT AND FOOTPATHS WHERE CONSTRUCTED ABOVE NATURAL SURFACE. REFER GEOTECH REPORT FOR SPECIFICATION

LEGEND

--- EXISTING SURFACE
--- DESIGN SURFACE
STRUCTURAL FILL

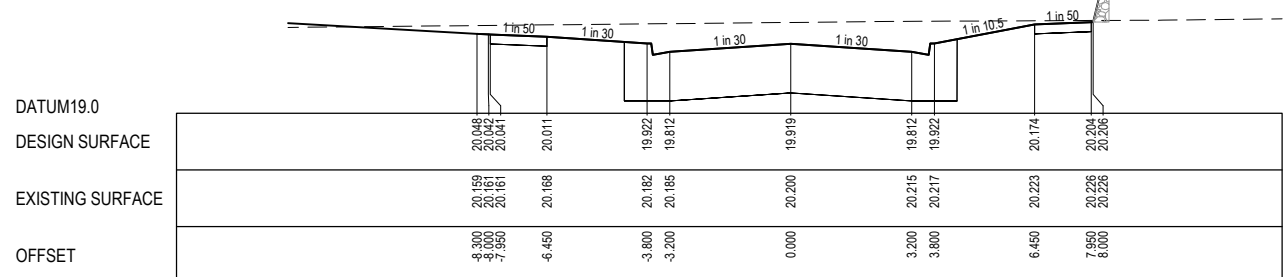
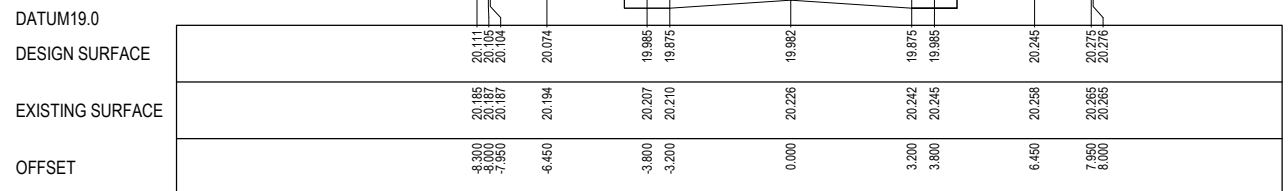
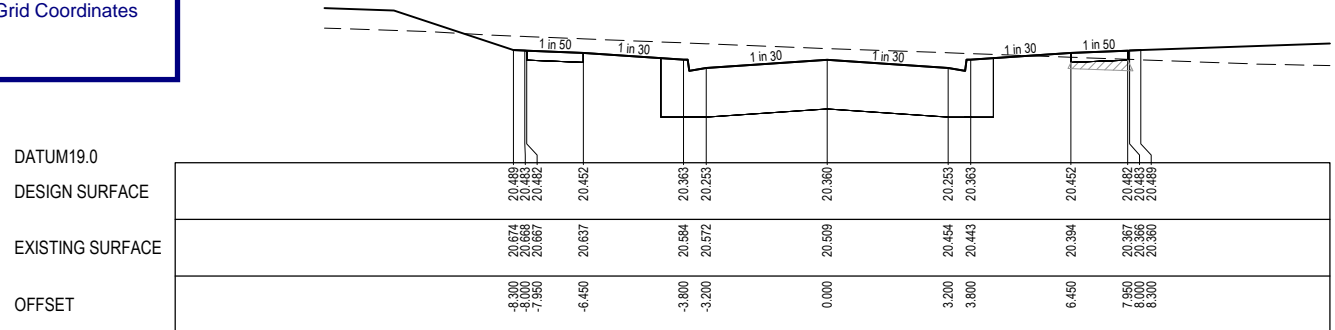
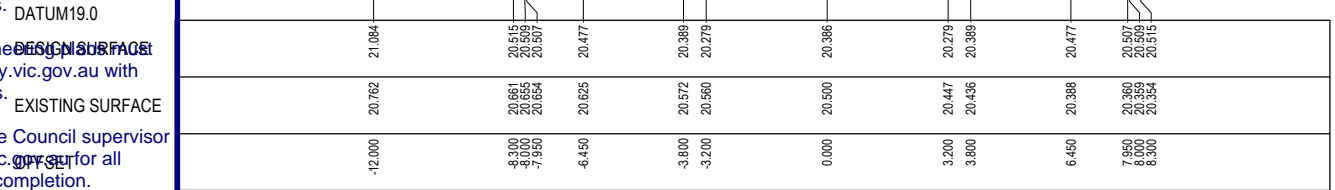
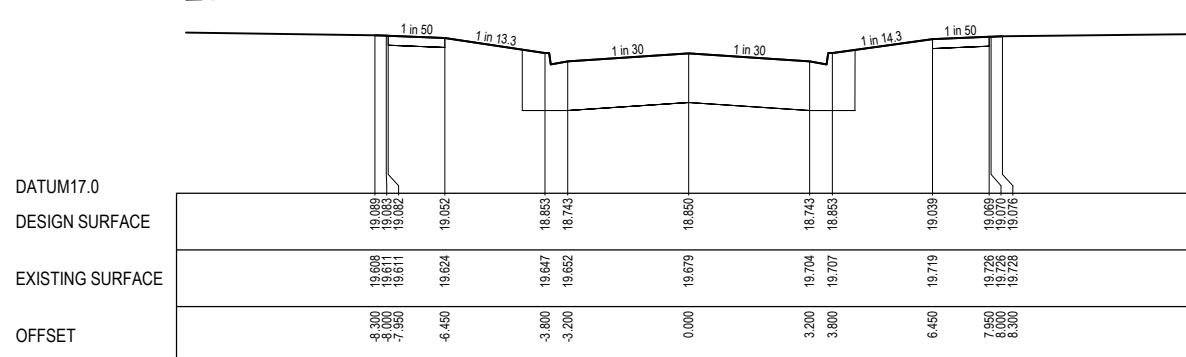
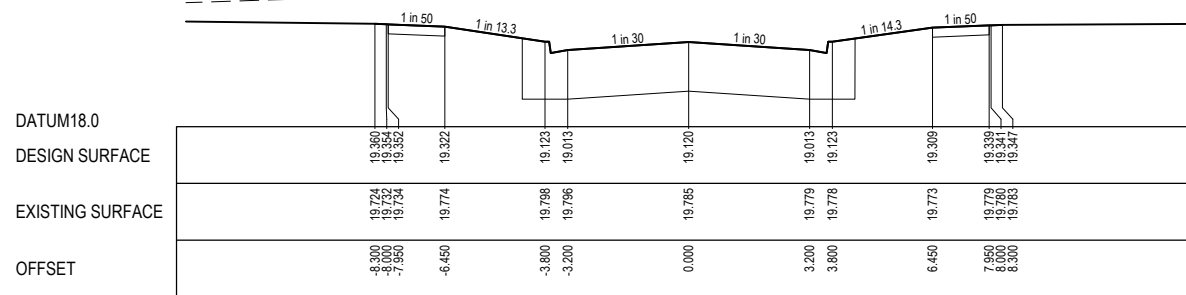
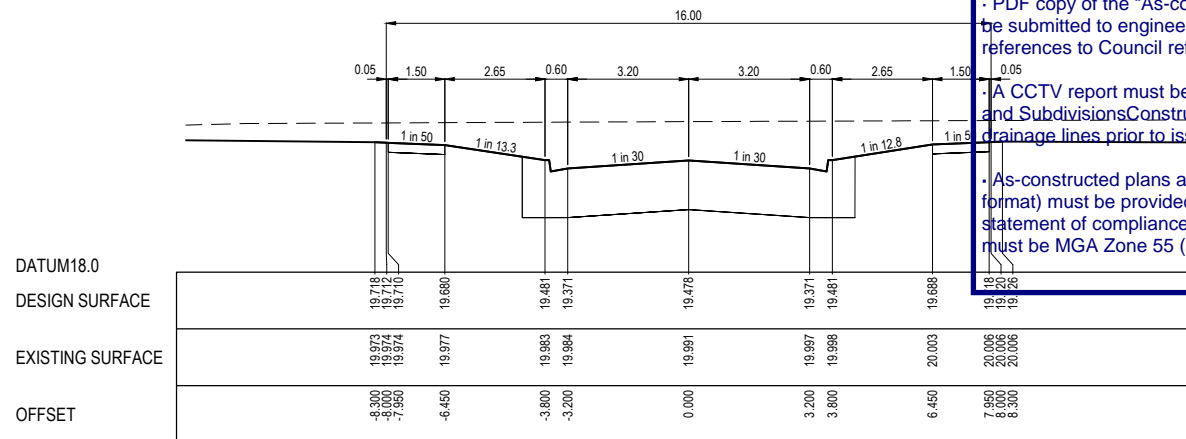

HORIZ 1:100

VERT. 1:50

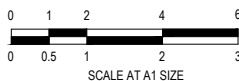

ISSUED FOR CONSTRUCTION

© COPYRIGHT All rights reserved
Beveridge Williams & Co. Pty Ltd has granted a licence to the principle to use this document for its intended purpose.
No unauthorised copying is permitted

REV	DESCRIPTION	DATE	DRN.	APP.	REV	DESCRIPTION	DATE	DRN.	APP.
B	ROAD NAME AMENDED	08.08.25	M.F.J.	S.F.					
A	ISSUED FOR CONSTRUCTION	07.07.25	M.F.J.	S.F.					



Designed
Date
Drawn
Checked
Date
Approved
Reg. No.
Date
PS Number

K.LIM WAN
17.02.2025
L.SUTHERLAND
17.02.2025
S.YOUNG
17.02.2025
S.YOUNG
PE0006609
17.02.2025
PS927119L

BW Beveridge Williams
Development & Infrastructure Consultants
1 Glenferrie Road
Malvern VIC 3144
ph: 03 9524 8888
www.beveridgewilliams.com.au

Project
Details
RIVERFIELD SQUARE
STAGE 32
CITY OF CASEY
Drawing
Title
ROAD CROSS SECTIONS
GREVILLEA CIRCUIT
(SHEET 1 OF 3)

Sheet 08 of 18

Scale
1:100 H 1:50 V @ A1

Project Ref
2101578
Stage No
32
Drawing No
200
Rev
B

K:\Jobs Data\2101578 - Di Renzo - 1675 Ballarto Road, Clyde\Eng\Stage 32\Drawings\2101578-32-200-RXS.dwg

City of Casey

Approved By: **Irshad Ghazi**

Planning Ref: **PA22-0318**

File No: **SEng00025/25**

Council Ref: **R6327**

Date : **25/09/2025**

Approval subject to below conditions:

- Works are to be carried out in accordance with an approved Environmental Management Plan (EMP) and Traffic Management Plan (TMP).

· Relevant service authorities notification and approval is obtained.

· Before starting any work, the contractor must contact Council's Construction Supervision Team on 9705 5200 to arrange Council supervision of the works.

· PDF copy of the "As-constructed" engineering plans must be submitted to engineeringplans@casey.vic.gov.au with references to Council reference numbers.

· A CCTV report must be submitted to the Council supervisor and Subdivisions Construction at casey.vic.gov.au for all drainage lines prior to issue of practical completion.

· As-constructed plans and asset information (A-SPEC format) must be provided to Council's satisfaction before statement of compliance will be issued. Grid Coordinates must be MGA Zone 55 (GDA 2020).

STRUCTURAL FILL REQUIRED UNDER PAVEMENT AND FOOTPATHS WHERE CONSTRUCTED ABOVE NATURAL SURFACE. REFER GEOTECH REPORT FOR SPECIFICATION

LEGEND

---	EXISTING SURFACE
---	DESIGN SURFACE
	STRUCTURAL FILL

DATUM19.0

DESIGN SURFACE

EXISTING SURFACE

OFFSET

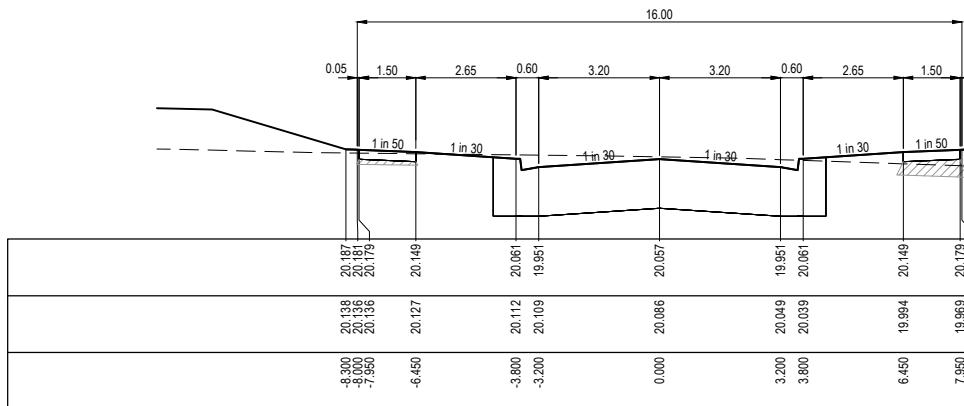

RTPCH 240.308

DATUM19.0

DESIGN SURFACE

EXISTING SURFACE

OFFSET

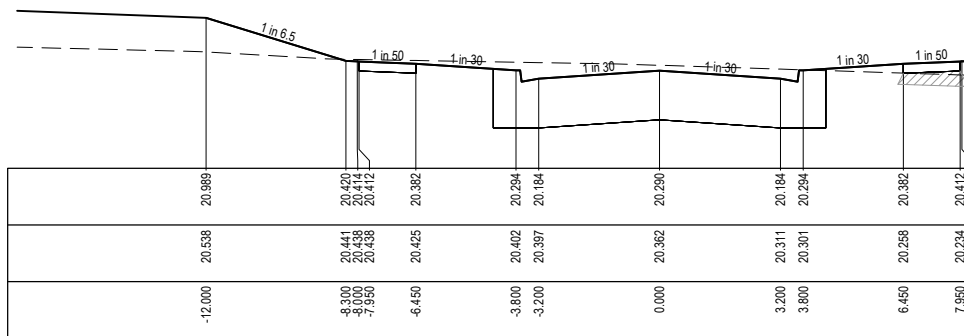

RTPCH 216.708

DATUM19.0

DESIGN SURFACE

EXISTING SURFACE

OFFSET

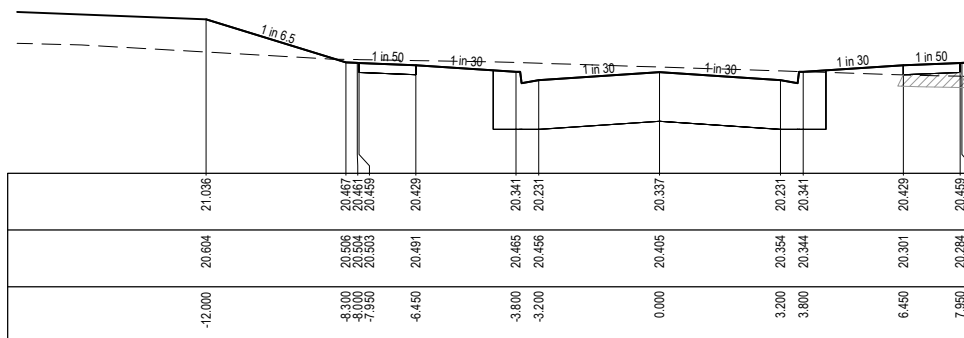

CH 210.008

DATUM19.0

DESIGN SURFACE

EXISTING SURFACE

OFFSET

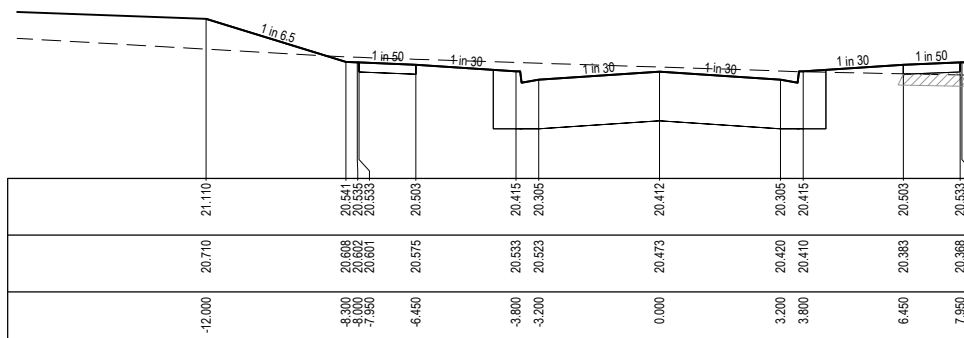

CH 197.508

DATUM18.0

DESIGN SURFACE

EXISTING SURFACE

OFFSET

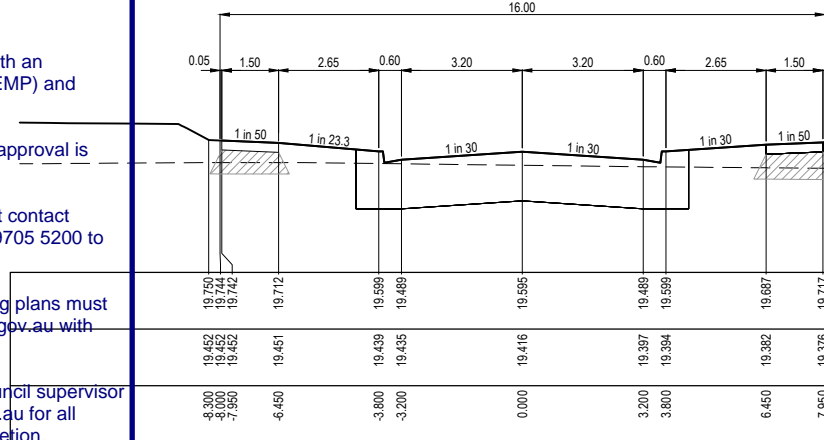

RTPCH 276.858

DATUM18.0

DESIGN SURFACE

EXISTING SURFACE

OFFSET

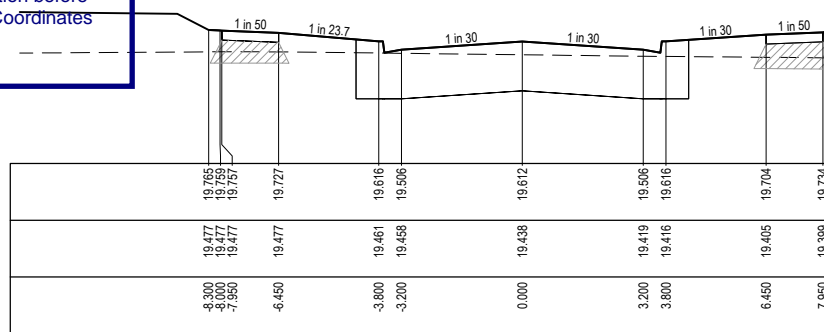

CH 275.508

DATUM18.0

DESIGN SURFACE

EXISTING SURFACE

OFFSET

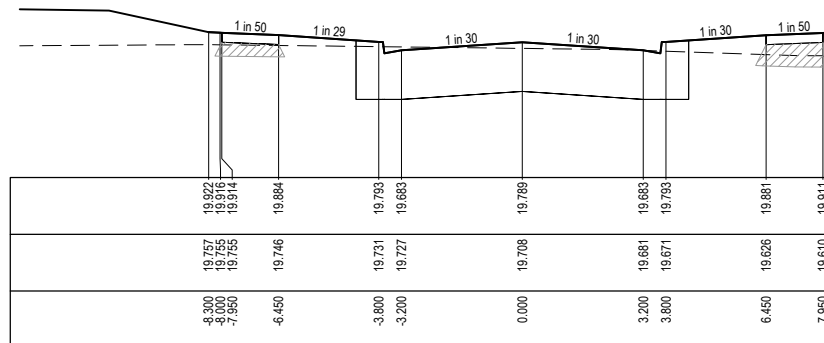

CH 261.508

DATUM19.0

DESIGN SURFACE

EXISTING SURFACE

OFFSET

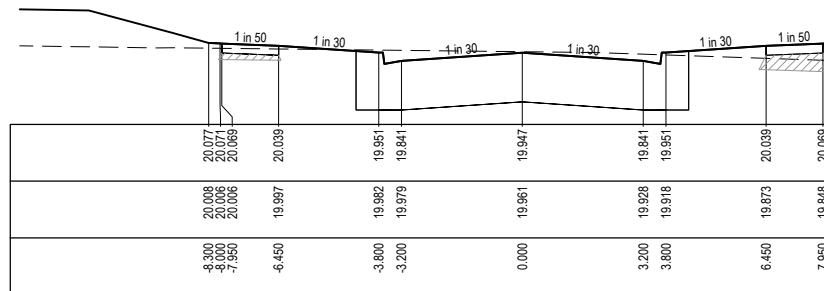

CH 249.008

HORIZ 1:100

VERT. 1:50

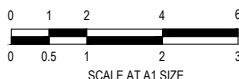

SCALE AT A1 SIZE

ISSUED FOR
CONSTRUCTION

© COPYRIGHT All rights reserved
Beveridge Williams & Co. Pty Ltd has granted a licence to the principle to use this document for its intended purpose.
No unauthorised copying is permitted

REV	DESCRIPTION	DATE	DRN.	APP.	REV	DESCRIPTION	DATE	DRN.	APP.
B	ROAD NAME AMENDED	08.08.25	M.F.J.	S.F.					
A	ISSUED FOR CONSTRUCTION	07.07.25	M.F.J.	S.F.					



Designed
Date
Drawn
Checked
Date
Approved
Reg. No.
Date
PS Number

K.LIM WAN
17.02.2025
L.SUTHERLAND
17.02.2025
S.YOUNG
17.02.2025
S.YOUNG
PE0005609
17.02.2025
PS927179L



Beveridge Williams
Development & Infrastructure Consultants
1 Glenferrie Road
Malvern VIC 3144
ph: 03 9524 8888
www.beveridgewilliams.com.au

Project
Details
RIVERFIELD SQUARE
STAGE 32
CITY OF CASEY
Drawing
Title
ROAD CROSS SECTIONS
GREVILLEA CIRCUIT
(SHEET 2 OF 3)

Sheet 09 of 18

Scale
1:100 H 1:50 V @ A1

Project Ref
2101578
Stage No
32
Drawing No
201
Rev
B

K:\Jobs Data\2101578 - Di Renzo - 1675 Ballarto Road, Clyde\Eng\Stage 32\Drawings\2101578-32-200-RXS.dwg

STRUCTURAL FILL REQUIRED UNDER PAVEMENT AND FOOTPATHS WHERE CONSTRUCTED ABOVE NATURAL SURFACE. REFER GEOTECH REPORT FOR SPECIFICATION

LEGEND

EXISTING SURFACE

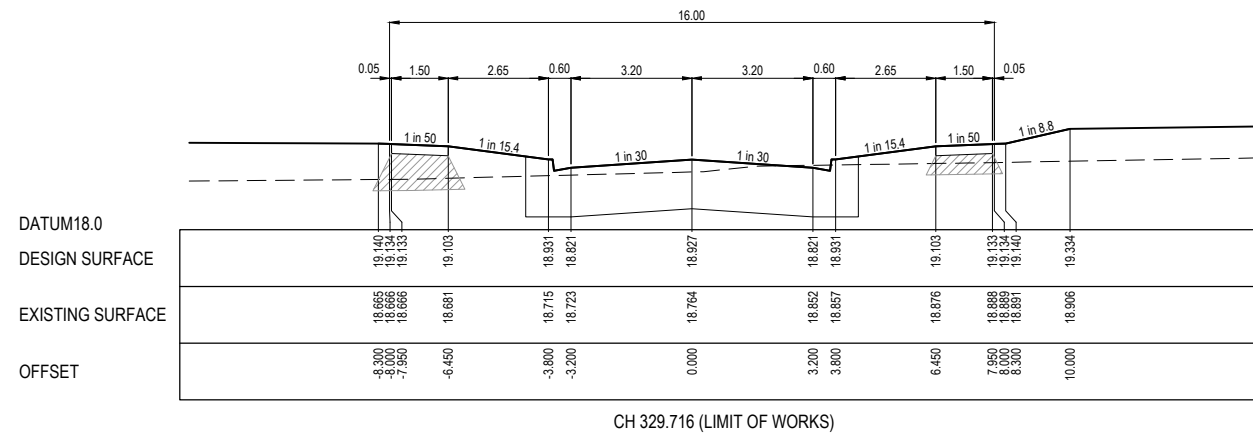
DESIGN SURFACE

CH 329.716 (LIMIT OF WORKS)

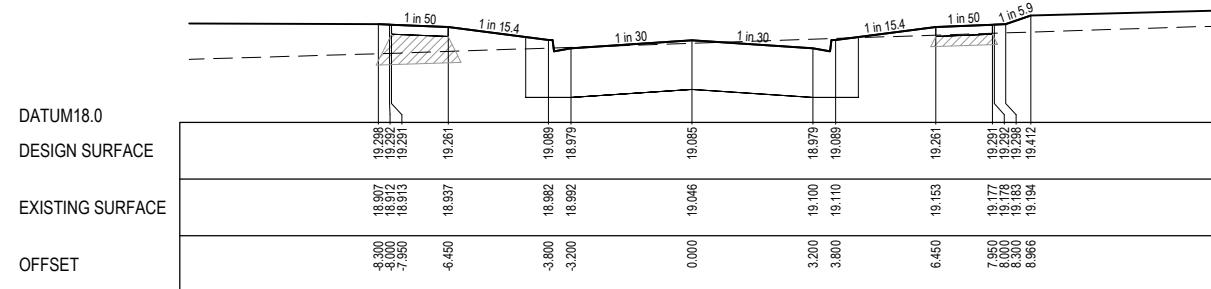

CH 317.216

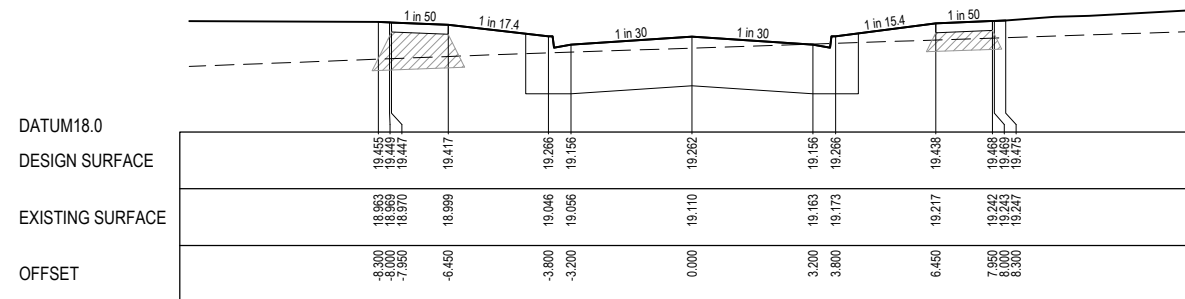

CH 303.216

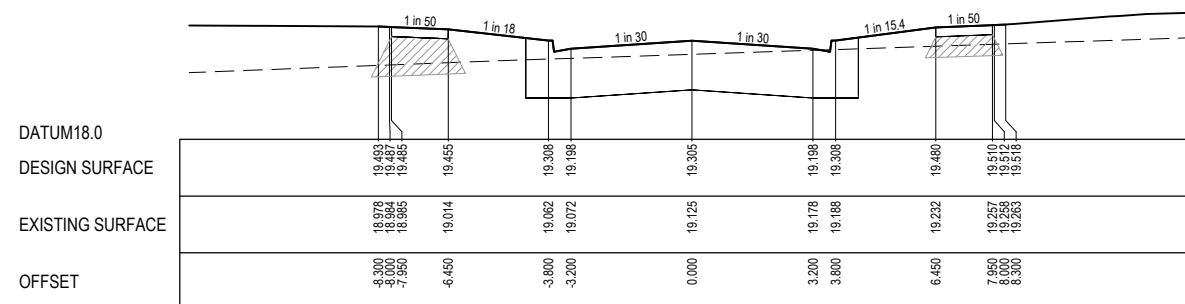

RTPCH 299.866

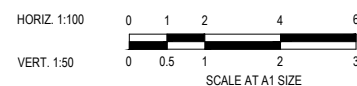

ISSUED FOR CONSTRUCTION

© COPYRIGHT All rights reserved Beveridge Williams & Co. Pty Ltd has granted a licence to the principle to use this document for its intended purpose. No unauthorised copying is permitted									
B	ROAD NAME AMENDED	08.08.25	M.F.J.	S.F.					
A	ISSUED FOR CONSTRUCTION	07.07.25	M.F.J.	S.F.					
REV	DESCRIPTION	DATE	DRN.	APP.	REV	DESCRIPTION	DATE	DRN.	APP.



Designed
Date
Drawn
Checked
Date
Approved
Reg. No.
Date
PS Number

K.LIM WAN
17.02.2025
L.SUTHERLAND
17.02.2025
S.YOUNG
17.02.2025
S.YOUNG
PE0005690
17.02.2025
PS927179L

Beveridge Williams
Development & Infrastructure Consultants
1 Glenferrie Road
Malvern VIC 3144
ph: 03 9524 8888
www.beveridgewilliams.com.au

Project Details	RIVERFIELD SQUARE STAGE 32 CITY OF CASEY	Sheet 10 of 18
Scale	1:100 H 1:50 V @ A1	
Project Ref	2101578	Stage No 32
Drawing No	202	Rev B

STRUCTURAL FILL REQUIRED UNDER PAVEMENT AND FOOTPATHS WHERE CONSTRUCTED ABOVE NATURAL SURFACE. REFER GEOTECH REPORT FOR SPECIFICATION

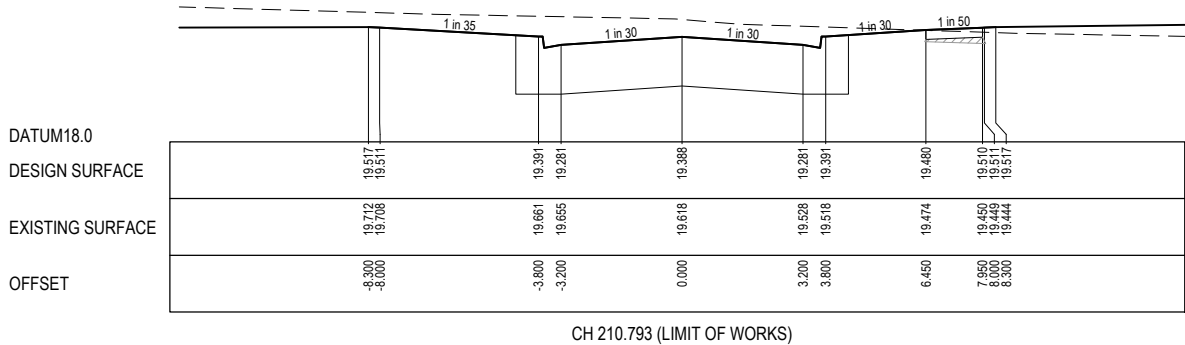
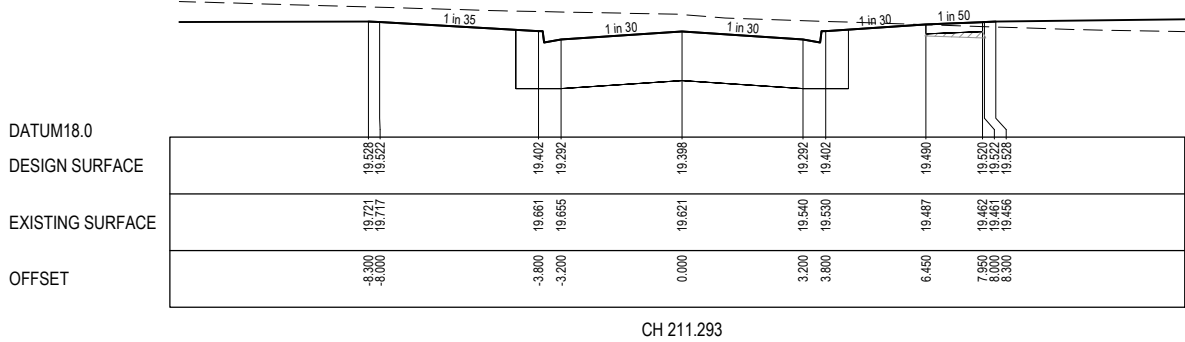
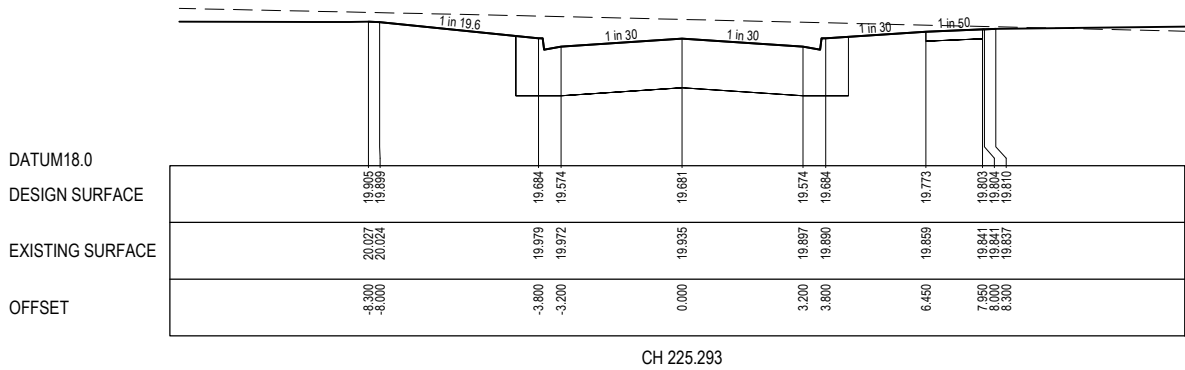
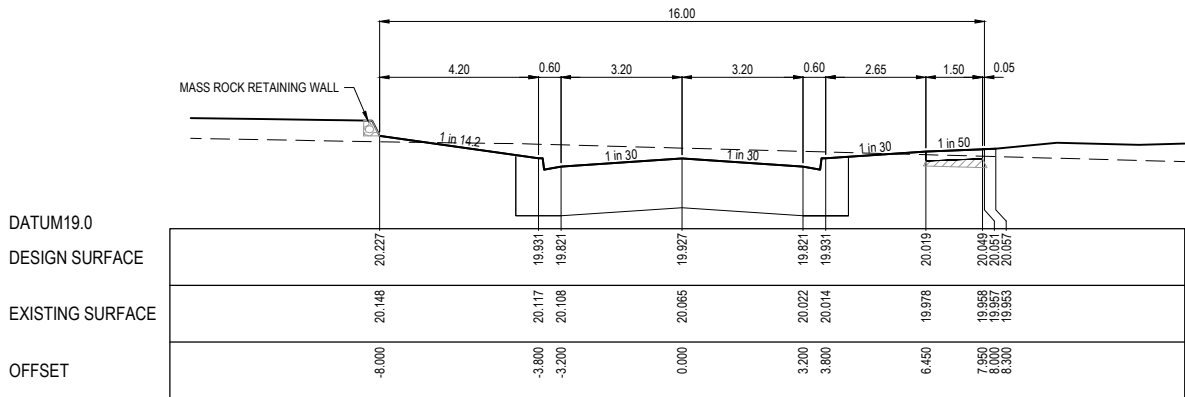
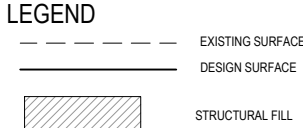

City of Casey

Approved By: **Irshad Ghazi**
Planning Ref: **PA22-0318**
File No: **SEng00025/25**
Council Ref: **R6327**
Date : **25/09/2025**

Approval subject to below conditions:

· Works are to be carried out in accordance with an approved Environmental Management Plan (EMP) and Traffic Management Plan (TMP).

· Relevant service authorities notification and approval is obtained.

· Before starting any work, the contractor must contact Council's Construction Supervision Team on 9705 5200 to arrange Council supervision of the works.

· PDF copy of the "As-constructed" engineering plans must be submitted to engineeringplans@casey.vic.gov.au with references to Council reference numbers.

· A CCTV report must be submitted to the Council supervisor and SubdivisionsConstruction@casey.vic.gov.au for all drainage lines prior to issue of practical completion.

· As-constructed plans and asset information (A-SPEC format) must be provided to Council's satisfaction before statement of compliance will be issued. Grid Coordinates must be MGA Zone 55 (GDA 2020).

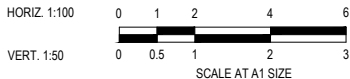

ISSUED FOR
CONSTRUCTION

© COPYRIGHT All rights reserved
Beveridge Williams & Co. Pty Ltd has granted a licence to the principle to use this document for its intended purpose.
No unauthorised copying is permitted

REV	DESCRIPTION	DATE	DRN.	APP.	REV	DESCRIPTION	DATE	DRN.	APP.
A	ISSUED FOR CONSTRUCTION	07.07.25	M.F.J.	S.F.					



Designed
Date
Drawn
Checked
Date
Approved
Reg. No.
Date
PS Number

K.LIM WAN
17.02.2025
L.SUTHERLAND
S.YOUNG
17.02.2025
S.YOUNG
PE0006908
17.02.2025
PS927179L

BW Beveridge Williams
Development & Infrastructure Consultants
1 Glenferrie Road
Malvern VIC 3144
ph: 03 9524 8888
www.beveridgewilliams.com.au

Project
Details
RIVERFIELD SQUARE
STAGE 32
CITY OF CASEY
Drawing
Title
ROAD CROSS SECTIONS
POPPY SAGE WAY

Sheet 11 of 18

Scale
1:100 H 1:50 V @ A1

Project Ref	Stage No	Drawing No	Rev
2101578	32	203	A

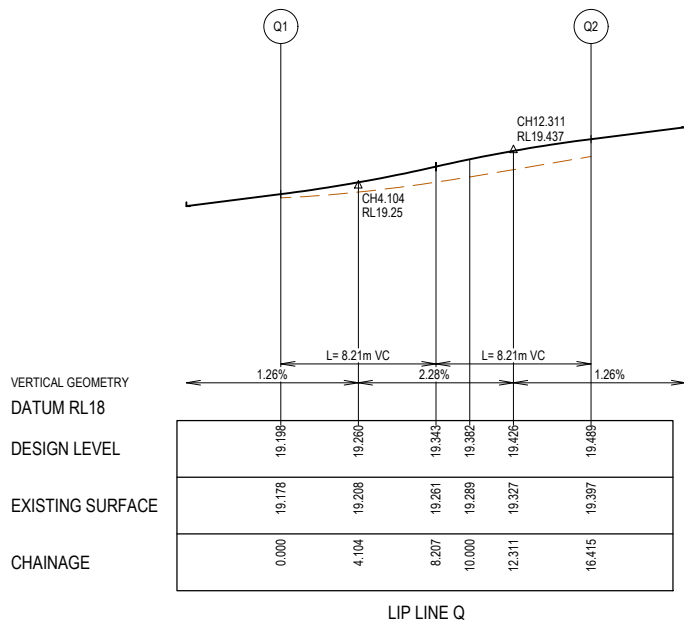

LIP LINE Q

Point no	Easting	Northing	RL
Q1	5431.518	77985.865	19.198
Q2	5422.635	77997.676	19.489

Curve no	I	Radius	Arc	A	B	X	Y	I	Mid point RL
Q1 - Q2	90.000	10.450	16.415	3.061	2.265	3.999	3.390	4.104	19.343

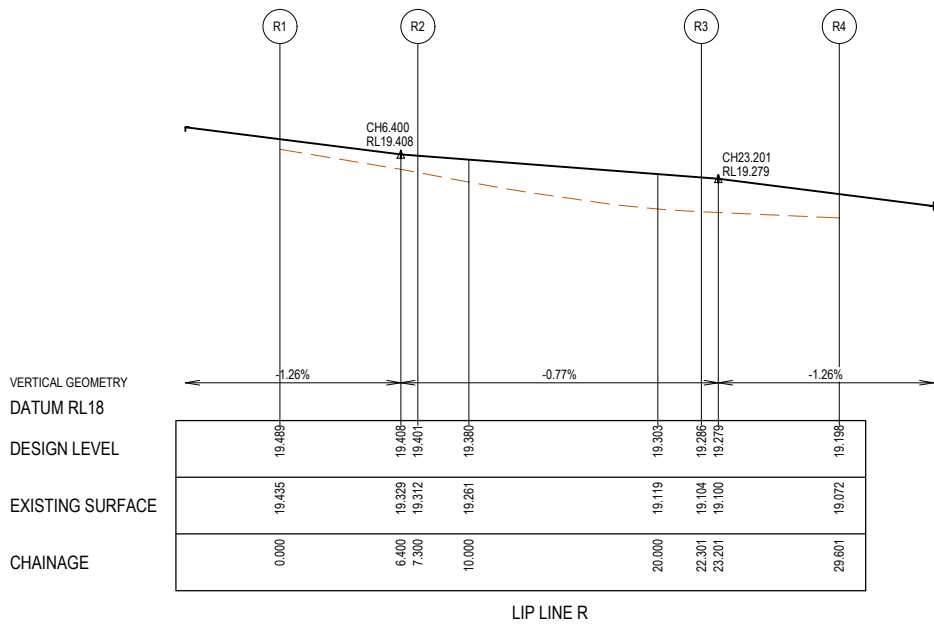

LIP LINE R

Point no	Easting	Northing	RL
R1	5423.532	78004.013	19.489
R2	5430.760	78002.991	19.401
R3	5438.878	77992.197	19.286
R4	5437.855	77984.969	19.198

Curve no	I	Radius	Arc	A	B	X	Y	I	Mid point RL
R2 - R3	90.000	9.550	15.001	2.797	2.070	3.655	3.098	3.750	19.343

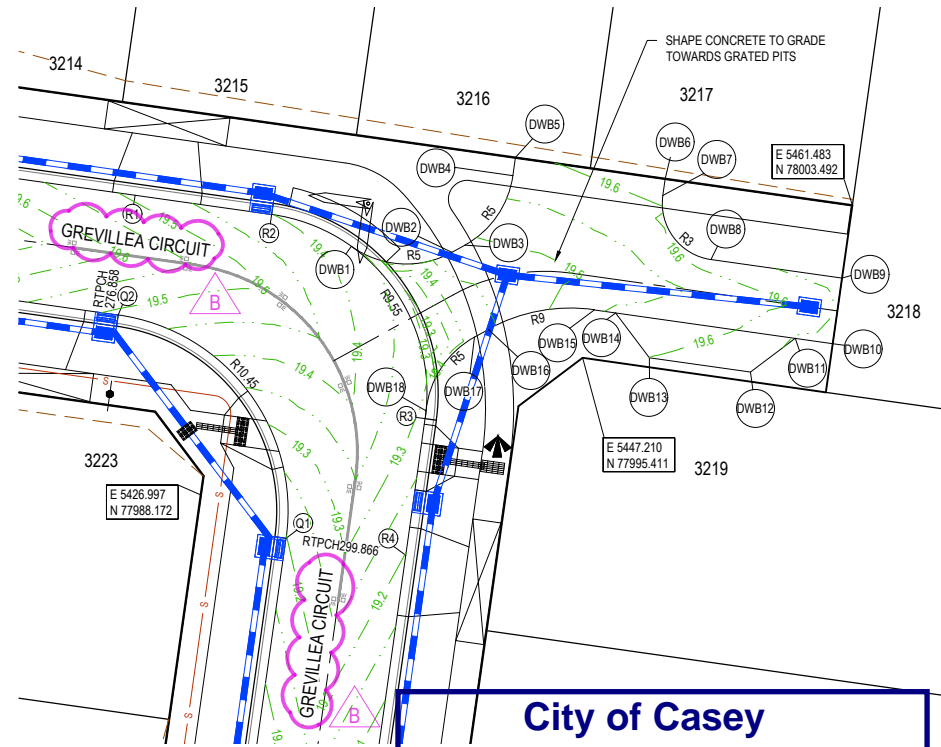

City of Casey

Approved By: **Irshad Ghazi**
Planning Ref: **PA22-0318**
File No: **SEng00025/25**
Council Ref: **R6327**
Date : **25/09/2025**

Approval subject to below conditions:

· Works are to be carried out in accordance with an approved Environmental Management Plan (EMP) and Traffic Management Plan (TMP).

· Relevant service authorities notification and approval is obtained.

· Before starting any work, the contractor must contact Council's Construction Supervision Team on 9705 5200 to arrange Council supervision of the works.

· PDF copy of the "As-constructed" engineering plans must be submitted to engineeringplans@casey.vic.gov.au with references to Council reference numbers.

· A CCTV report must be submitted to the Council supervisor and SubdivisionsConstruction@casey.vic.gov.au for all drainage lines prior to issue of practical completion.

· As-constructed plans and asset information (A-SPEC format) must be provided to Council's satisfaction before statement of compliance will be issued. Grid Coordinates must be MGA Zone 55 (GDA 2020).

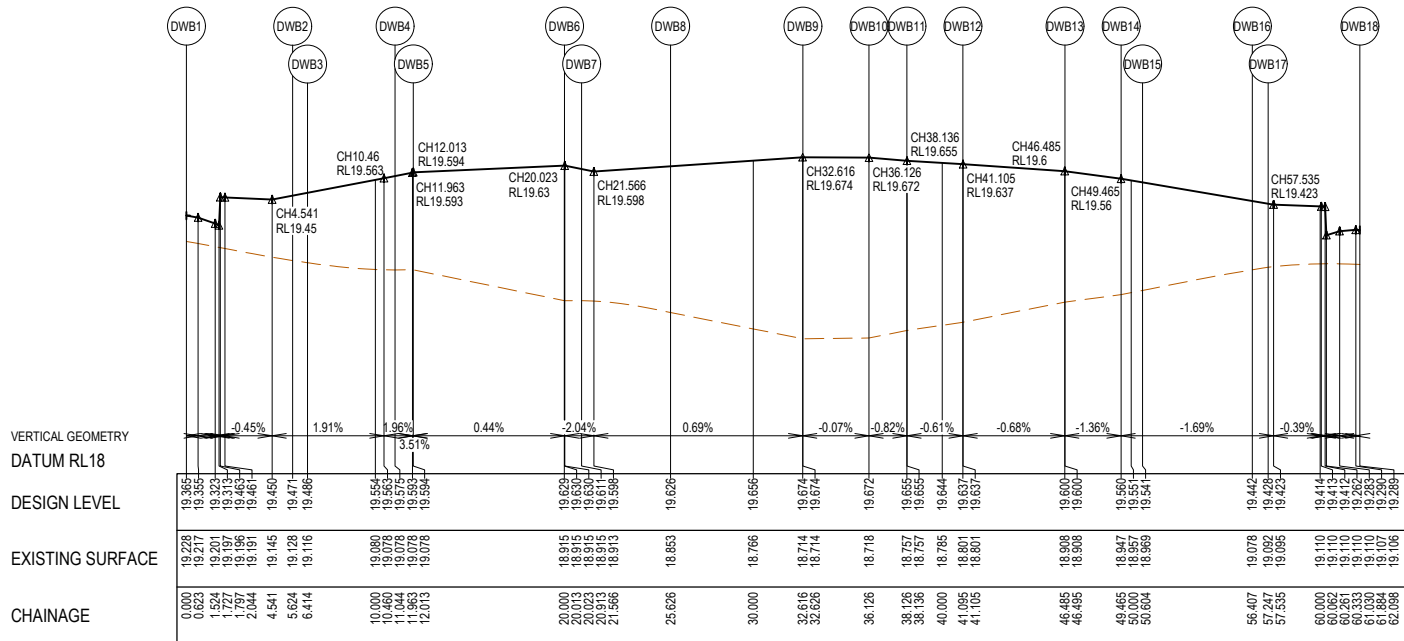

LIP LINE DWB

Point no	Easting	Northing	RL
DWB1	5434.975	78001.304	19.365
DWB2	5440.298	78000.995	19.471
DWB3	5440.990	78001.376	19.486
DWB4	5443.525	78005.053	19.575
DWB5	5443.660	78006.013	19.594
DWB6	5451.581	78004.893	19.630
DWB7	5451.455	78004.001	19.611
DWB8	5454.006	78000.611	19.626
DWB9	5460.937	77999.630	19.674
DWB10	5460.446	77996.165	19.672
DWB11	5458.466	77996.445	19.655
DWB12	5456.093	77994.660	19.637
DWB13	5450.746	77995.416	19.600
DWB14	5448.961	77997.790	19.560
DWB15	5447.833	77997.949	19.541
DWB16	5442.224	77996.918	19.442
DWB17	5441.489	77996.512	19.428
DWB18	5438.928	77992.615	19.289

Curve no	I	Radius	Arc	A	B	X	Y	I	Mid point RL
DWB1 - DWB2	64.445	5.000	5.624	0.770	0.574	1.388	1.279	1.406	19.458
DWB3 - DWB4	53.056	5.000	4.630	0.526	0.393	1.147	1.086	1.158	19.530
DWB7 - DWB8	90.000	3.000	4.712	0.879	0.650	1.148	0.973	1.178	19.610
DWB15 - DWB16	36.944	9.000	5.803	0.464	0.347	1.445	1.407	1.451	19.492
DWB17 - DWB18	55.585	5.000	4.851	0.577	0.430	1.201	1.131	1.213	19.415

LEGEND

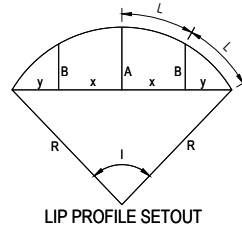
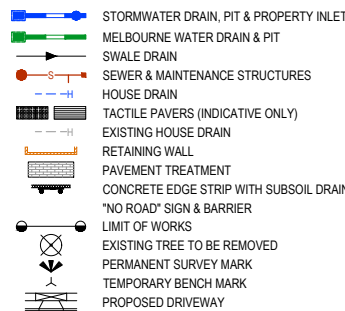

ISSUED FOR
CONSTRUCTION

© COPYRIGHT All rights reserved
Beveridge Williams & Co. Pty Ltd has granted a licence to the principle to use this document for its intended purpose.
No unauthorised copying is permitted

REV	DESCRIPTION	DATE	DRN.	APP.	REV	DESCRIPTION	DATE	DRN.	APP.
B	ROAD NAME AMENDED	08.08.25	M.F.J.	S.F.					
A	ISSUED FOR CONSTRUCTION	07.07.25	M.F.J.	S.F.					



Designed
Date
Drawn
Checked
Date
Approved
Reg. No.
Date
PS Number

K.LIM WAN
17.02.2025
L.SUTHERLAND
17.02.2025
S.YOUNG
17.02.2025
S.YOUNG
PE0005608
17.02.2025
PS927179L

BW Beveridge Williams
Development & Infrastructure Consultants
1 Glenferrie Road
Malvern VIC 3144
ph: 03 9524 8888
www.beveridgewilliams.com.au

Project
Details
RIVERFIELD SQUARE
STAGE 32
CITY OF CASEY
Drawing
Title
INTERSECTION DETAILS
(SHEET 2 OF 2)

Sheet 13 of 18

Scale
1:200 H 1:20 V @ A1

Project Ref
2101578
Stage No
32
Drawing No
301
Rev
B

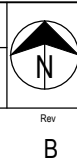

City of Casey

Approved By: Irshad Ghazi
Planning Ref: PA22-0318
File No: SEng00025/25
Council Ref: R6327
Date : 25/09/2025

Approval subject to below conditions:

- Works are to be carried out in accordance with an approved Environmental Management Plan (EMP) and Traffic Management Plan (TMP).
- Relevant service authorities notification and approval is obtained.
- Before starting any work, the contractor must contact Council's Construction Supervision Team on 9705 5200 to arrange Council supervision of the works.
- PDF copy of the "As-constructed" engineering plans must be submitted to engineeringplans@casey.vic.gov.au with references to Council reference numbers.
- A CCTV report must be submitted to the Council supervisor and SubdivisionsConstruction@casey.vic.gov.au for all drainage lines prior to issue of practical completion.
- As-constructed plans and asset information (A-SPEC format) must be provided to Council's satisfaction before statement of compliance will be issued. Grid Coordinates must be MGA Zone 55 (GDA 2020).



- NOTES
1.

RRPM'S AT MAX 6m SPACING.
2.

LINEMARKING TO BE EXTENDED AT LEAST 6m FROM THE TANGENT POINT
3.

LINEMARKING IN ACCORDANCE WITH AS1742.
4.

TGSI TO BE INSTALLED IN ACCORDANCE WITH AS1428.4.1-2009 & VICROADS SUPPLEMENTARY STANDARD TEM Vol 2 Part 2.23
5.

ALL STREET NAME SIGNS AT INTERSECTIONS TO INCLUDE RELEVANT STREET NUMBERING.
6.

ALL LINE MARKING PAINT SHALL BE LONG LIFE TYPE. LATERAL WORKS AND ARROWS BEING COLD APPLIED PLASTIC TROWELLED INTO PLACE (MATERIAL DEGADUR PLASTELINE) AND LONGITUDINAL LINES BEING EXTRUDED THERMOPLASTIC MATERIAL.
7.

EVERY LOT TO HAVE STREET NUMBER STAMPED ON KERB IN ACCORDANCE WITH COUNCIL REQUIREMENTS. CONTRACTOR TO OBTAIN LATEST STREET NUMBERING FROM SURVEY CONSULTANT PRIOR TO STAMPING.

© COPYRIGHT All rights reserved Beveridge Williams & Co. Pty Ltd has granted a licence to the principle to use this document for its intended purpose. No unauthorised copying is permitted									
B	ROAD NAME AMENDED	08.08.26	M.F.J.	S.F.					
A	ISSUED FOR CONSTRUCTION	07.07.25	M.F.J.	S.F.					
REV	DESCRIPTION	DATE	DRN.	APP.	REV	DESCRIPTION	DATE	DRN.	APP.



Designed
Date

K.LIM WAN
17.02.2025

Drawn
Date

L.SUTHERLAND
17.02.2025

Checked
Date

S.YOUNG
17.02.2025

Approved
Reg. No.
Date

S.YOUNG
PE0005609
17.02.2025

PS Number

PS927179L

BW

Beveridge Williams

Development & Infrastructure Consultants

1 Glenferrie Road
Malvern VIC 3144

ph: 03 9524 8888
www.beveridgewilliams.com.au

Project
Details

RIVERFIELD SQUARE
STAGE 32
CITY OF CASEY

Drawing
Title

SIGNAGE & LINE MARKING PLANS

ISSUED FOR
CONSTRUCTION

Sheet 14 of 18

Scale
1:500 @ A1

Project Ref	Stage No	Drawing No	Rev
2101578	32	350	B



City of Casey

Approved By: **Irshad Ghazi**
Planning Ref: **PA22-0318**
File No: **SEng00025/25**
Council Ref: **R6327**
Date : **25/09/2025**

Approval subject to below conditions:

· Works are to be carried out in accordance with an approved Environmental Management Plan (EMP) and Traffic Management Plan (TMP).

· Relevant service authorities notification and approval is obtained.

· Before starting any work, the contractor must contact Council's Construction Supervision Team on 9705 5200 to arrange Council supervision of the works.

· PDF copy of the "As-constructed" engineering plans must be submitted to engineeringplans@casey.vic.gov.au with references to Council reference numbers.

· A CCTV report must be submitted to the Council supervisor and SubdivisionsConstruction@casey.vic.gov.au for all drainage lines prior to issue of practical completion.

· As-constructed plans and asset information (A-SPEC format) must be provided to Council's satisfaction before statement of compliance will be issued. Grid Coordinates must be MGA Zone 55 (GDA 2020).

NOTES:
ALL STORMWATER DRAINS UP TO AND INCLUDING 750mm DIA. ARE TO BE CLASS 2 R.R.J. PIPES UNLESS NOTED OTHERWISE.

LEGEND	
	EXISTING SURFACE
	DESIGN SURFACE
	DRAINAGE PIPE/PIT
	EXISTING DRAINAGE PIPE/PIT
	HYDRAULIC GRADE LINE
	DENOTES 20mm CLASS 3 FCR BACKFILL

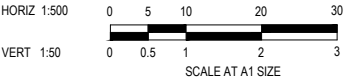
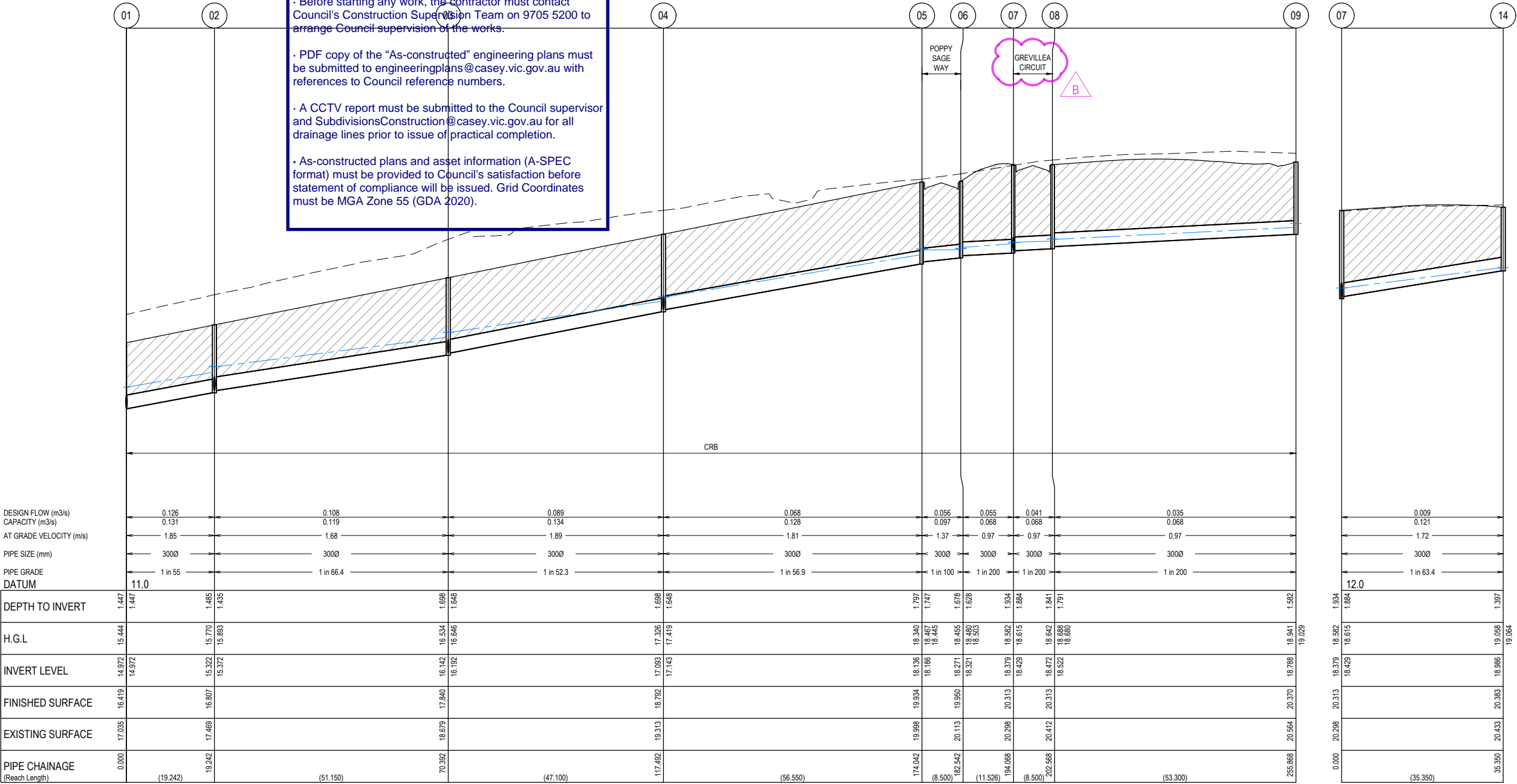

ISSUED FOR CONSTRUCTION

© COPYRIGHT All rights reserved
Beveridge Williams & Co. Pty Ltd has granted a licence to the principle to use this document for its intended purpose.
No unauthorised copying is permitted

REV	DESCRIPTION	DATE	DRN.	APP.	REV	DESCRIPTION	DATE	DRN.	APP.
B	ROAD NAME AMENDED	08.08.27	M.F.J.	S.F.					
A	ISSUED FOR CONSTRUCTION	07.07.25	M.F.J.	S.F.					



Designed: K.LIM WAN
Date: 17.02.2025
Drawn: L.SUTHERLAND
Checked: S.YOUNG
Date: 17.02.2025
Approved: S.YOUNG
Reg. No: PE0005608
Date: 17.02.2025
PS Number: PS927179L

BW Beveridge Williams
Development & Infrastructure Consultants
1 Glenferrie Road
Malvern VIC 3144
ph: 03 9524 8888
www.beveridgewilliams.com.au

Project Details
RIVERFIELD SQUARE
STAGE 32
CITY OF CASEY

Drawing Title
DRAINAGE LONGITUDINAL SECTIONS
(SHEET 1 OF 4)

Sheet 15 of 18

Scale
1:500 H 1:50 V @ A1

Project Ref	Stage No	Drawing No	Rev
2101578	32	400	B

Approved By: **Irshad Ghazi**
Planning Ref: **PA22-0318**
File No: **SEng00025/25**
Council Ref: **R6327**
Date : **25/09/2025**

Approval subject to below conditions:

- Works are to be carried out in accordance with an approved Environmental Management Plan (EMP) and Traffic Management Plan (TMP).
- Relevant service authorities notification and approval is obtained.
- Before starting any work, the contractor must contact Council's Construction Supervision Team on 9705 5200 to arrange Council supervision of the works.
- PDF copy of the "As-constructed" engineering plans must be submitted to engineeringplans@casey.vic.gov.au with references to Council reference numbers.
- A CCTV report must be submitted to the Council supervisor and SubdivisionsConstruction@casey.vic.gov.au for all drainage lines prior to issue of practical completion.
- As-constructed plans and asset information (A-SPEC format) must be provided to Council's satisfaction before statement of compliance will be issued. Grid Coordinates must be MGA Zone 55 (GDA 2020).

Approved By: **Irshad Ghazi**
Planning Ref: **PA22-0318**
File No: **SEng00025/25**
Council Ref: **R6327**
Date : **25/09/2025**

Approval subject to below conditions:

- Works are to be carried out in accordance with an approved Environmental Management Plan (EMP) and Traffic Management Plan (TMP).
- Relevant service authorities notification and approval is obtained.
- Before starting any work, the contractor must contact Council's Construction Supervision Team on 9705 5200 to arrange Council supervision of the works.
- PDF copy of the "As-constructed" engineering plans must be submitted to engineeringplans@casey.vic.gov.au with references to Council reference numbers.
- A CCTV report must be submitted to the Council supervisor and SubdivisionsConstruction@casey.vic.gov.au for all drainage lines prior to issue of practical completion.
- As-constructed plans and asset information (A-SPEC format) must be provided to Council's satisfaction before statement of compliance will be issued. Grid Coordinates must be MGA Zone 55 (GDA 2020).

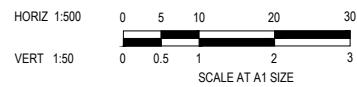
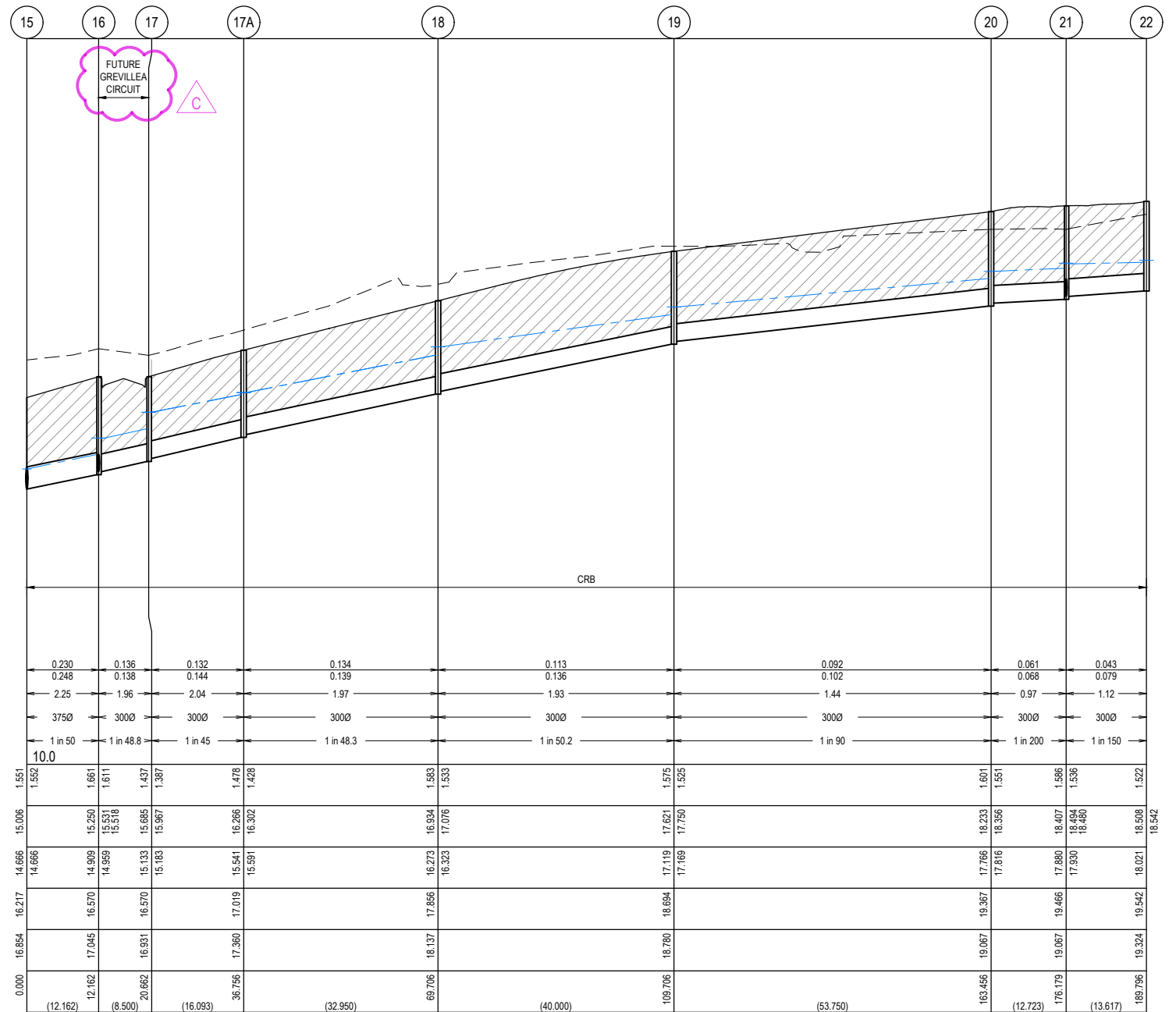
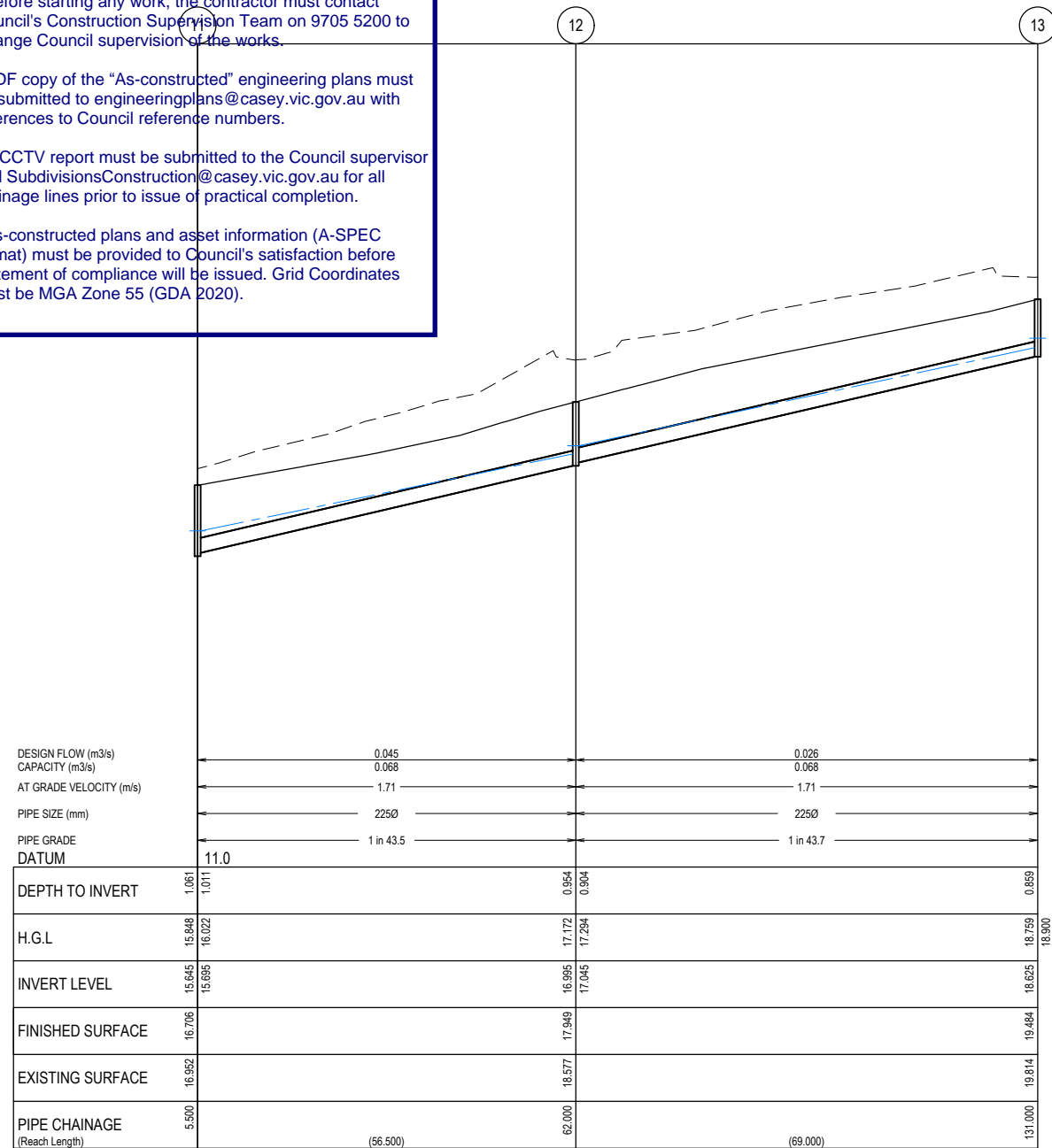

ISSUED FOR
CONSTRUCTION

© COPYRIGHT. All rights reserved. Beveridge Williams & Co. Pty Ltd has granted a licence to the principle to use this document for its intended purpose. No unauthorised copying is permitted																			
C	ROAD NAME AMENDED				08.08.27	M.F.J.	S.F.												
B	PIT 17A ADDED				16.07.25	KLW	SF												
A	ISSUED FOR CONSTRUCTION				07.07.25	M.F.J.	S.F.												
REV	DESCRIPTION				DATE	DRN	APP.	REV	DESCRIPTION				DATE	DRN	APP.				



Designed Date	K.LIM WAN 17.02.2025
Drawn L.SUTHERLAND	
Checked Date	S.YOUNG 17.02.2025
Approved Reg. No.	S.YOUNG PE0005609
Date	17.02.2025
PS Number	PS927179L



Beveridge Williams

Development & Infrastructure Consultants

1 Glenferrie Road
Malvern VIC 3144

ph: 03 9524 8888
www.beveridgewilliams.com.au

Project Details	RIVERFIELD SQUARE STAGE 32 CITY OF CASEY
Drawing Title	DRAINAGE LONGITUDINAL SECTIONS (SHEET 2 OF 4)

Sheet 16 of 18

Scale
1:500 H 1:50 V @ A1

Project Ref	Stage No	Drawing No	Rev
2101578	32	401	C

City of Casey

Approved By: **Irshad Ghazi**
Planning Ref: **PA22-0318**
File No: **SEng00025/25**
Council Ref: **R6327**
Date : **25/09/2025**

Approval subject to below conditions:

- Works are to be carried out in accordance with an approved Environmental Management Plan (EMP) and Traffic Management Plan (TMP).

- Relevant service authorities notification and approval is obtained.

- Before starting any work, the contractor must contact Council's Construction Supervision Team on 9705 5200 to arrange Council supervision of the works.

- PDF copy of the "As-constructed" engineering plans must be submitted to engineeringplans@casey.vic.gov.au with references to Council reference numbers.

- A CCTV report must be submitted to the Council supervisor and SubdivisionsConstruction@casey.vic.gov.au for all drainage lines prior to issue of practical completion.

- As-constructed plans and asset information (A-SPEC format) must be provided to Council's satisfaction before statement of compliance will be issued. Grid Coordinates must be MGA Zone 55 (GDA 2020).

NOTES:
ALL STORMWATER DRAINS UP TO AND INCLUDING 750mm DIA. ARE TO BE CLASS 2 R.R.J. PIPES UNLESS NOTED OTHERWISE.

LEGEND	
	EXISTING SURFACE
	DESIGN SURFACE
	DRAINAGE PIPE/PIT
	EXISTING DRAINAGE PIPE/PIT
	HYDRAULIC GRADE LINE
	DENOTES 20mm CLASS 3 FCR BACKFILL

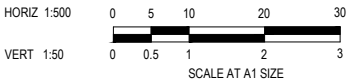
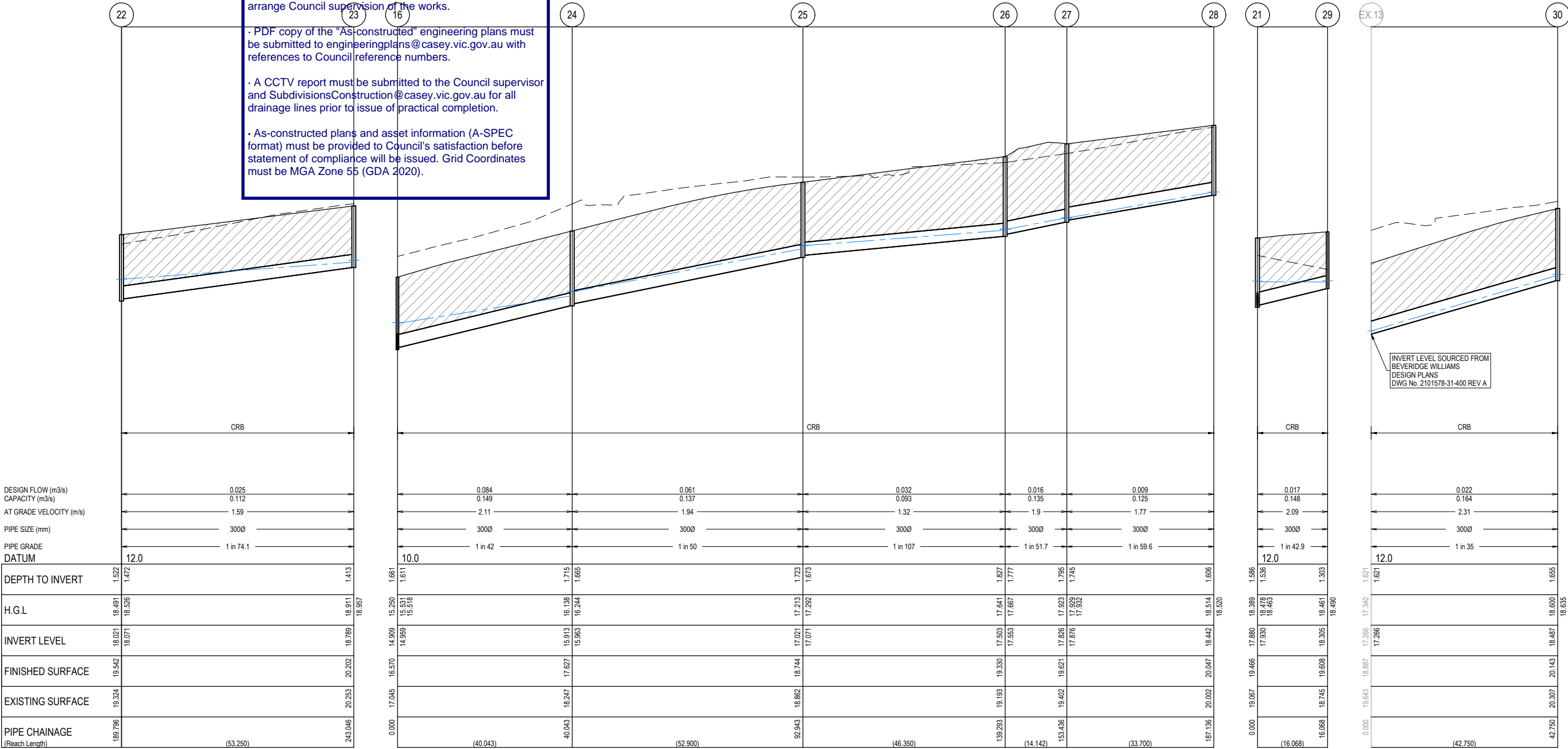

ISSUED FOR
CONSTRUCTION

© COPYRIGHT All rights reserved
Beveridge Williams & Co. Pty Ltd has granted a licence to the principle to use this document for its intended purpose.
No unauthorised copying is permitted

REV	DESCRIPTION	DATE	DRN.	APP.	REV	DESCRIPTION	DATE	DRN.	APP.
A	ISSUED FOR CONSTRUCTION	07.07.25	M.F.J.	S.F.					



Designed
Date
Drawn
Checked
Date
Approved
Reg. No.
Date
PS Number

K.LIM WAN
17.02.2025
L.SUTHERLAND
17.02.2025
S.YOUNG
17.02.2025
S.YOUNG
PE0005609
17.02.2025
PS927119L

BW Beveridge Williams
Development & Infrastructure Consultants
1 Glenferrie Road
Malvern VIC 3144
ph: 03 9524 8888
www.beveridgewilliams.com.au

Project
Details
RIVERFIELD SQUARE
STAGE 32
CITY OF CASEY
Drawing
Title
DRAINAGE LONGITUDINAL SECTIONS
(SHEET 3 OF 4)

Sheet 17 of 18

Scale
1:500 H 1:50 V @ A1

Project Ref	Stage No	Drawing No	Rev
2101578	32	402	A

NOTES:
ALL STORMWATER DRAINS UP TO AND INCLUDING 750mm DIA. ARE TO BE CLASS 2 R.R.J. PIPES UNLESS NOTED OTHERWISE.

LEGEND	
	EXISTING SURFACE
	DESIGN SURFACE
	DRAINAGE PIPE/PIT
	EXISTING DRAINAGE PIPE/PIT
	HYDRAULIC GRADE LINE
	DENOTES 20mm CLASS 3 FCR BACKFILL

EX.22

31

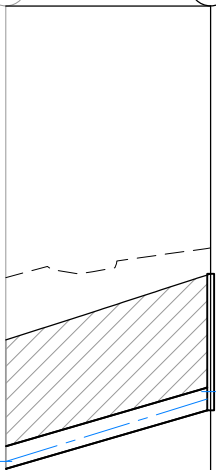

INVERT LEVEL SOURCED FROM
BEVERIDGE WILLIAMS
DESIGN PLANS
DWG No. 2101578-31-401 REV A

CRB

DESIGN FLOW (m3/s) 0.037
CAPACITY (m3/s) 0.164
AT GRADE VELOCITY (m/s) 2.31
PIPE SIZE (mm) 3000
PIPE GRADE 1 in 35
DATUM 11.0

DEPTH TO INVERT	1.704	1.803
H.G.L	17.276	18.104
INVERT LEVEL	17.181	17.955
FINISHED SURFACE	18.885	19.759
EXISTING SURFACE	19.709	20.102
PIPE CHAINAGE (Reach Length)	0.000	27.100

PIT SCHEDULE														
PIT NAME	PIT TYPE	LID		INTERNAL		INLET		OUTLET		F.S.L	DEPTH (m)	PIT	HAUNCH	REMARKS
		WIDTH (mm)	LENGTH (mm)	WIDTH (mm)	LENGTH (mm)	DIAMETER (mm)	INV R.L (mm)	DIAMETER (mm)	INV R.L (m)			DETAIL	DETAIL	
01	ENDWALL	-	-	-	-	300	14.972	300	14.972	16.419	1.447	-	-	TEMPORARY SANDBAG ENDWALL.
02	SIDE ENTRY PIT	600	900	600	900	300	15.372	300	15.322	16.807	1.485	EDCM 601	-	PROVIDE PIT BLOCKOUT FOR FUTURE 300mm CONNECTION AT IL15.372.
03	SIDE ENTRY PIT	600	900	600	900	300	16.192	300	16.142	17.84	1.698	EDCM 601	-	PROVIDE PIT BLOCKOUT FOR FUTURE 300mm CONNECTION AT IL16.494.
		-	-	-	-	300	16.192	-	-	-	-	-	-	-
04	SIDE ENTRY PIT	600	900	600	900	300	17.143	300	17.093	18.792	1.698	EDCM 601	-	PROVIDE PIT BLOCKOUT FOR FUTURE 300mm CONNECTION AT IL17.445.
05	SIDE ENTRY PIT	600	900	600	900	300	17.143	-	-	-	-	-	-	-
		-	-	-	-	300	17.143	-	-	-	-	-	-	-
06	SIDE ENTRY PIT	600	900	600	900	300	18.186	300	18.136	19.934	1.797	EDCM 601	-	-
07	SIDE ENTRY PIT	600	900	600	900	300	18.321	300	18.271	19.95	1.678	EDCM 601	-	-
08	SIDE ENTRY PIT	600	900	600	900	300	18.429	300	18.379	20.313	1.934	EDCM 601	-	-
		-	-	-	-	300	18.429	-	-	-	-	-	-	-
09	JUNCTION PIT	600	900	600	900	300	18.522	300	18.472	20.313	1.841	EDCM 601	-	-
11	JUNCTION PIT	600	900	600	900	-	-	300	18.788	20.37	1.582	EDCM605	-	PROVIDE HEAVY DUTY COVER.
12	JUNCTION PIT	600	900	600	900	-	-	300	18.986	20.383	1.397	EDCM605	-	REMOVE MARKER POST AND CONSTRUCT PIT
13	JUNCTION PIT	600	900	600	900	225	15.695	225	15.645	16.706	1.061	EDCM605	-	-
14	JUNCTION PIT	600	900	600	900	225	17.045	225	16.995	17.949	0.954	EDCM605	-	-
15	ENDWALL	-	-	-	-	-	-	225	18.625	19.484	0.859	EDCM605	-	-
16	SIDE ENTRY PIT	600	900	600	900	375	14.666	375	14.666	16.217	1.552	-	-	TEMPORARY SANDBAG ENDWALL.
17	SIDE ENTRY PIT	600	900	600	900	300	14.959	375	14.909	16.57	1.661	EDCM 601	-	PROVIDE HEAVY DUTY COVER.
		-	-	-	-	300	14.959	-	-	-	-	-	-	-
17A	SIDE ENTRY PIT	600	900	600	900	300	15.183	300	15.133	16.57	1.437	EDCM 601	-	PROVIDE HEAVY DUTY COVER.
18	JUNCTION PIT	600	900	600	900	300	15.591	300	15.541	17.019	1.478	EDCM605	-	PROVIDE HEAVY DUTY COVER.
19	SIDE ENTRY PIT	600	900	600	900	300	16.323	300	16.273	17.856	1.583	EDCM 601	-	-
20	SIDE ENTRY PIT	600	900	600	900	300	17.169	300	17.119	18.694	1.575	EDCM 601	-	-
21	SIDE ENTRY PIT	600	900	600	900	300	17.816	300	17.766	19.367	1.601	EDCM 601	-	-
22	GRADED PIT	600	900	600	900	300	17.93	300	17.88	19.466	1.586	EDCM 605	-	PROVIDE HEAVY DUTY GRADED COVER.
		-	-	-	-	300	17.93	-	-	-	-	-	-	-
23	SIDE ENTRY PIT	600	900	600	900	300	18.071	300	18.021	19.542	1.522	EDCM 601	-	-
24	JUNCTION PIT	600	900	600	900	-	-	300	18.789	20.202	1.413	EDCM605	-	-
25	SIDE ENTRY PIT	600	900	600	900	300	15.963	300	15.913	17.627	1.715	EDCM 601	-	-
26	SIDE ENTRY PIT	600	900	600	900	300	17.071	300	17.021	18.744	1.723	EDCM 601	-	-
27	SIDE ENTRY PIT	600	900	600	900	300	17.553	300	17.503	19.33	1.827	EDCM 601	-	-
28	SIDE ENTRY PIT	600	900	600	900	300	17.876	300	17.826	19.621	1.795	EDCM 601	-	-
29	JUNCTION PIT	600	900	600	900	-	-	300	18.442	20.047	1.606	EDCM605	-	-
30	GRADED PIT	600	900	600	900	-	-	300	18.305	19.608	1.303	EDCM605	-	PROVIDE HEAVY DUTY GRADED COVER.
31	SIDE ENTRY PIT	600	900	600	900	-	-	300	18.487	20.143	1.655	EDCM 601	-	-
32	SIDE ENTRY PIT	600	900	600	900	-	-	300	17.955	19.759	1.803	EDCM 601	-	-

City of Casey

Approved By: **Irshad Ghazi**

Planning Ref: **PA22-0318**

File No: **SENG00025/25**

Council Ref: **R6327**

C

City of Casey

Approved By: Irshad Ghazi

Planning Ref: PA22-0318

File No: SE000025/25

Council Ref: R6327

Date : 25/09/2025

Approval subject to below conditions:

· Works are to be carried out in accordance with an approved Environmental Management Plan (EMP) and Traffic Management Plan (TMP).

· Relevant service authorities notification and approval is obtained.

· Before starting any work, the contractor must contact Council's Construction Supervision Team on 9705 5200 to arrange Council supervision of the works.

· PDF copy of the "As-constructed" engineering plans must be submitted to engineeringplans@casey.vic.gov.au with references to Council reference numbers.

· A CCTV report must be submitted to the Council supervisor and SubdivisionsConstruction@casey.vic.gov.au for all drainage lines prior to issue of practical completion.

· As-constructed plans and asset information (A-SPEC format) must be provided to Council's satisfaction before statement of compliance will be issued. Grid Coordinates must be MGA Zone 55 (GDA 2020).

ISSUED FOR
CONSTRUCTION

© COPYRIGHT All rights reserved
Beveridge Williams & Co. Pty Ltd has granted a licence to the principle to use this document for its intended purpose.
No unauthorised copying is permitted

REV	DESCRIPTION	DATE	DRN.	APP.	REV	DESCRIPTION	DATE	DRN.	APP.
C	PITS 26 & 27 UPDATED	29.07.25	AP	SF					
B	PIT 17A ADDED	16.07.25	KLW	SF					
A	ISSUED FOR CONSTRUCTION	07.07.25	M.F.J.	S.F.					



Designed
Date
17.02.2025
Drawn
L.SUTHERLAND
Checked
Date
17.02.2025
S.YOUNG
Approved
Reg. No.
PE0006909
Date
17.02.2025
S.YOUNG
PS Number
PS927179L

BW Beveridge Williams
Development & Infrastructure Consultants
1 Glenferrie Road
Malvern VIC 3144
ph: 03 9524 8888
www.beveridgewilliams.com.au

Project
Details
RIVERFIELD SQUARE
STAGE 32
CITY OF CASEY
Drawing
Title
DRAINAGE LONGITUDINAL SECTIONS
(SHEET 4 OF 4)
AND PIT SCHEDULE

Sheet 18 of 18

Scale
1:500 H 1:50 V @ A1

Project Ref
2101578
Stage No
32
Drawing No
403
Rev
C

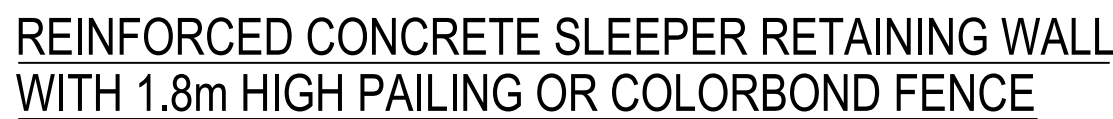

- REFER BEVERIDGE WILLIAMS DRAWINGS FOR WALL LOCATIONS AND HEIGHTS.
- WHERE BASALT IS PRESENT, THE BORED PIER FOOTINGS SHALL BE SOCKETED 900mm MINIMUM INTO SOLID UNDISTURBED BEDROCK

MASS ROCK RETAINING WALL DETAIL

RETAINING WALL NOTE:
THE RETAINING WALL DESIGN ASSUMES THAT ALL FILLING USED ON SITE IS APPROVED IMPORTED MATERIAL THAT HAS BEEN COMPACTED IN LAYERS TO MINIMUM OF 95% STANDARD COMPACTION IN ACCORDANCE WITH AS1289 AND THAT THE FILLING HAS BEEN PLACED UNDER CLASS 1 GEOTECHNICAL ENGINEER SUPERVISION IN ACCORDANCE WITH AS3798. SHOULD THIS BE FOUND NOT TO BE THE CASE DURING THE CONSTRUCTION PROCESS, REDESIGN OF RETAINING WALLS WILL BE REQUIRED.

WITH FENCE

NOTE 1:
ALL STEELWORK TO BE HOT DIP GALVANISED
AFTER FABRICATION.

1. ALL CONCRETE BASED ON $f_c = 25\text{MPa}$ NORMAL CONCRETE MIX.
2. CONCRETE SLUMP TO BE 80mm WITH A MAXIMUM AGGREGATE SIZE = 20mm.
3. CONCRETE THICKNESS NOMINATED ARE MINIMUM STRUCTURAL REQUIREMENTS.
4. ALL REINFORCEMENT TO BE 'N' TYPE HOT ROLLED DEFORMED BARS IN ACCORDANCE WITH AS4671 AND BE GRADE 500.
5. ALL REINFORCEMENT SHALL BE SECURELY SUPPORTED AND MAINTAINED IN CORRECT POSITION DURING CONCRETING.
6. WELDING OF REINFORCEMENT SHALL NOT BE PERMITTED WITHOUT THE APPROVAL OF THE STRUCTURAL ENGINEER.
7. ALL WELDING SHALL BE IN ACCORDANCE WITH AS1554.3
8. ALL CONCRETE WORKMANSHIP AND MATERIALS SHALL BE IN ACCORDANCE AS3600 AND OTHER RELEVANT AUSTRALIAN STANDARDS.
9. CONCRETE SHALL BE SUPPLIED BY AN APPROVED MANUFACTURER IN ACCORDANCE WITH AS1379.

CORROSION PROTECTION OF STEELWORK SHALL BE AS FOLLOWS
STEELWORK PERMANENTLY EXPOSED TO WEATHER OR
AGGRESSIVE ENVIROMENT SHALL BE HOT DIPPED GALVANISED.

ALL WORKMANSHIP & MATERIALS SHALL BE IN ACCORDANCE WITH AS4100 S.A STEEL STRUCTURES WELDING SHALL BE PERFORMED BY A QUALIFIED OPERATOR IN ACCORDANCE WITH AS1554. UNLESS STATED OTHERWISE.

A. ALL CLEATS, GUSSETS & END PLATES SHALL BE 10mm THICK.
B. WELDING ELECTRODE SHALL BE E48XX.
C. ALL FILLET WELDS SHALL BE 6mm CONTINUOUS.
D. ALL BUTT WELDS SHALL BE FULL PENETRATION.
E. BOLT HOLE CLEARANCE SHALL BE 2mm
F. ALL WELDS SHALL BE STRUCTURAL PURPOSE.

THE GRADE OF STRUCTURAL STEEL SHALL BE AS FOLLOWS U.N.O.

SECTION	GRADE (MPa)
HOT ROLLED SECTIONS	300

TOE OF WALL SHALL PENETRATE THROUGH ANY FILL MATERIAL & THE NATURAL SILT SOILS TO BE FOUNDED AT LEAST 100mm INTO THE UNDERLYING NATURAL STIFF CLAY OR WEATHERED ROCK.

ALL EXCAVATIONS SHALL HAVE FOUNDING DEPTHS & BEARING CAPACITY APPROVED BY THE ENGINEER OR BUILDING SURVEYOR BEFORE CONCRETE IS PLACED.

FOOTING EXCAVATIONS WHICH ARE DEEPEENED TO PENETRATE THROUGH UNSUITABLE SOILS SHALL BE BACKFILLED UP TO UNDERSIDE OF FOOTING WITH 15 MPa BLINDING CONCRETE.

ALL EXCAVATION FOUNDING SURFACES SHALL BE LEVEL (NOT INCLINED),
CLEAN CUT & FREE OF MUD OR WATER.

ALL SEEPAGE INFLOW SHALL BE REMOVED BEFORE PLACEMENT OF CONCRETE.

FOOTINGS SHALL BE FOUNDED IN STIFF NATURAL CLAY HAVING A
SAFE BEARING CAPACITY OF 100 kPa.

Approved By: Irshad Ghazi

Planning Ref: PA22-0318

File No: **SEng00025/25**

Council Ref: **R6327**

Date : 25/09/2025

Approval subject to below conditions:

- Works are to be carried out in accordance with an approved Environmental Management Plan (EMP) and Traffic Management Plan (TMP).

- Relevant service authorities notification and approval is obtained.

- Before starting any work, the contractor must contact Council's Construction Supervision Team on 9705 5200 to arrange Council supervision of the works.

· PDF copy of the “As-constructed” engineering plans must be submitted to engineeringplans@casey.vic.gov.au with references to Council reference numbers.

- A CCTV report must be submitted to the Council supervisor and SubdivisionsConstruction@casey.vic.gov.au for all drainage lines prior to issue of practical completion.

As-constructed plans and asset information (A-SPEC format) must be provided to Council's satisfaction before statement of compliance will be issued. Grid Coordinates must be MGA Zone 55 (GDA 2020).



REVISIONS				
P2	APPROVAL ISSUE		30.08.2024	MA
P1	APPROVAL ISSUE		26.08.2024	MA
REVISION	DETAILS		DATE	APPROVED

APPROVAL

CIVIL	
Designed M ALLAN	Date APRIL 2023
Drawn M.T	Scale AS SHOWN @ A1 SHEET

**MA CIVIL
DESIGN PTY LTD**

ABN: 75 128 863 445
0424 811 015
+61 3 9830 1101
55 Sir Garnet Rd, Surrey Hills, VIC
design@macivil.com.au
www.macivil.com.au

Project Title :

RIVERFIELD SQUARE ESTATE
1675 BALLATO ROAD,
CLYDE NORTH

Drawing Title :

RETAINING WALL DETAILS

SHEET 1

Drawing No :

177-01-S01

P2

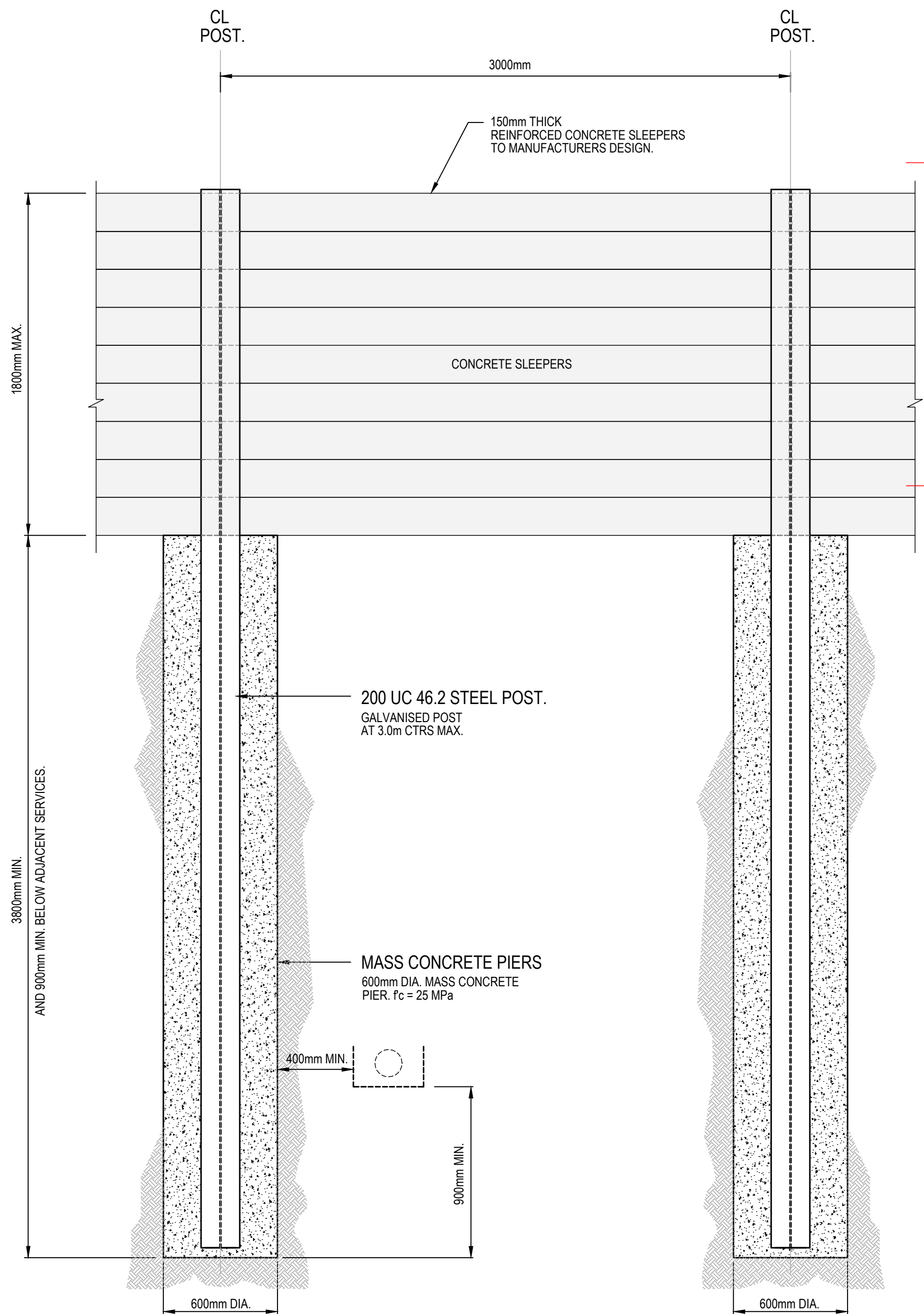

RETAINING WALL DETAIL
CONCRETE SLEEPER WITH 3.0m SPAN

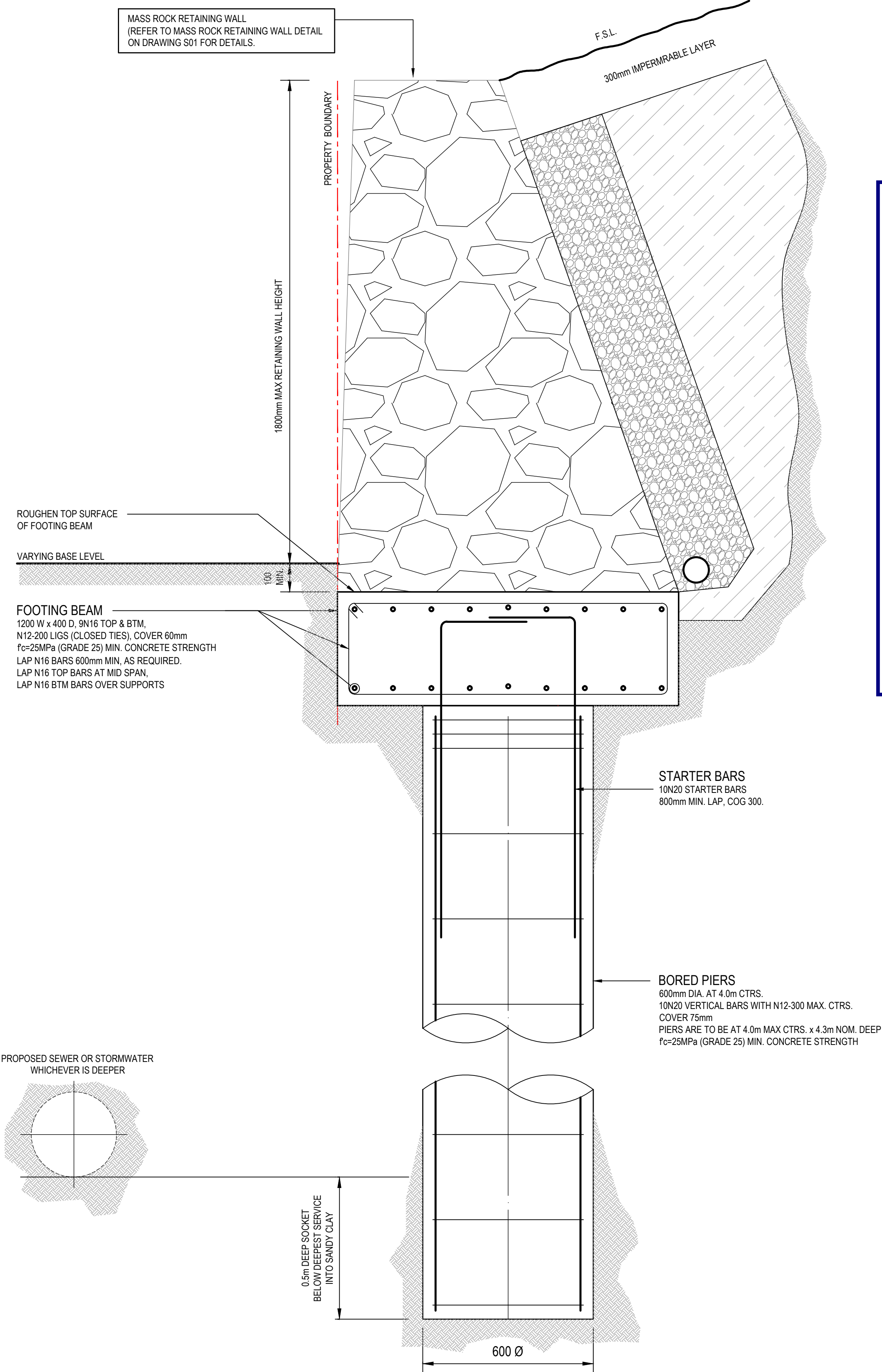

MASS ROCK RETAINING WALL ON PIERS NEAR PARALLEL SEWER OR STORMWATER DETAIL
SCALE 1:10

City of Casey

Approved By: Irshad Ghazi
Planning Ref: PA22-0318
File No: SEng00025/25
Council Ref: R6327
Date : 25/09/2025

Approval subject to below conditions:
· Works are to be carried out in accordance with an approved Environmental Management Plan (EMP) and Traffic Management Plan (TMP).
· Relevant service authorities notification and approval is obtained.
· Before starting any work, the contractor must contact Council's Construction Supervision Team on 9705 5200 to arrange Council supervision of the works.
· PDF copy of the "As-constructed" engineering plans must be submitted to engineeringplans@casey.vic.gov.au with references to Council reference numbers.
· A CCTV report must be submitted to the Council supervisor and SubdivisionsConstruction@casey.vic.gov.au for all drainage lines prior to issue of practical completion.
· As-constructed plans and asset information (A-SPEC format) must be provided to Council's satisfaction before statement of compliance will be issued. Grid Coordinates must be MGA Zone 55 (GDA 2020).



REVISIONS			
P2	APPROVAL ISSUE	30.08.2024	MA
P1	APPROVAL ISSUE	26.08.2024	MA
REVISION	DETAILS	DATE	APPROVED

APPROVAL

CIVIL	
Designed M ALLAN	Date APRIL 2023
Drawn M.T	Scale AS SHOWN @ A1 SHEET

MA CIVIL
DESIGN
PTY LTD

ABN: 75 128 863 445
0424 811 015
+61 3 9830 1101
55 Sir Garnet Rd, Surrey Hills, VIC
design@macivil.com.au
www.macivil.com.au

Project Title :
RIVERFIELD SQUARE ESTATE
1675 BALLATO ROAD,
CLYDE NORTH

Drawing Title :
RETAINING WALL DETAILS
SHEET 2

Drawing No :
177-01-S02

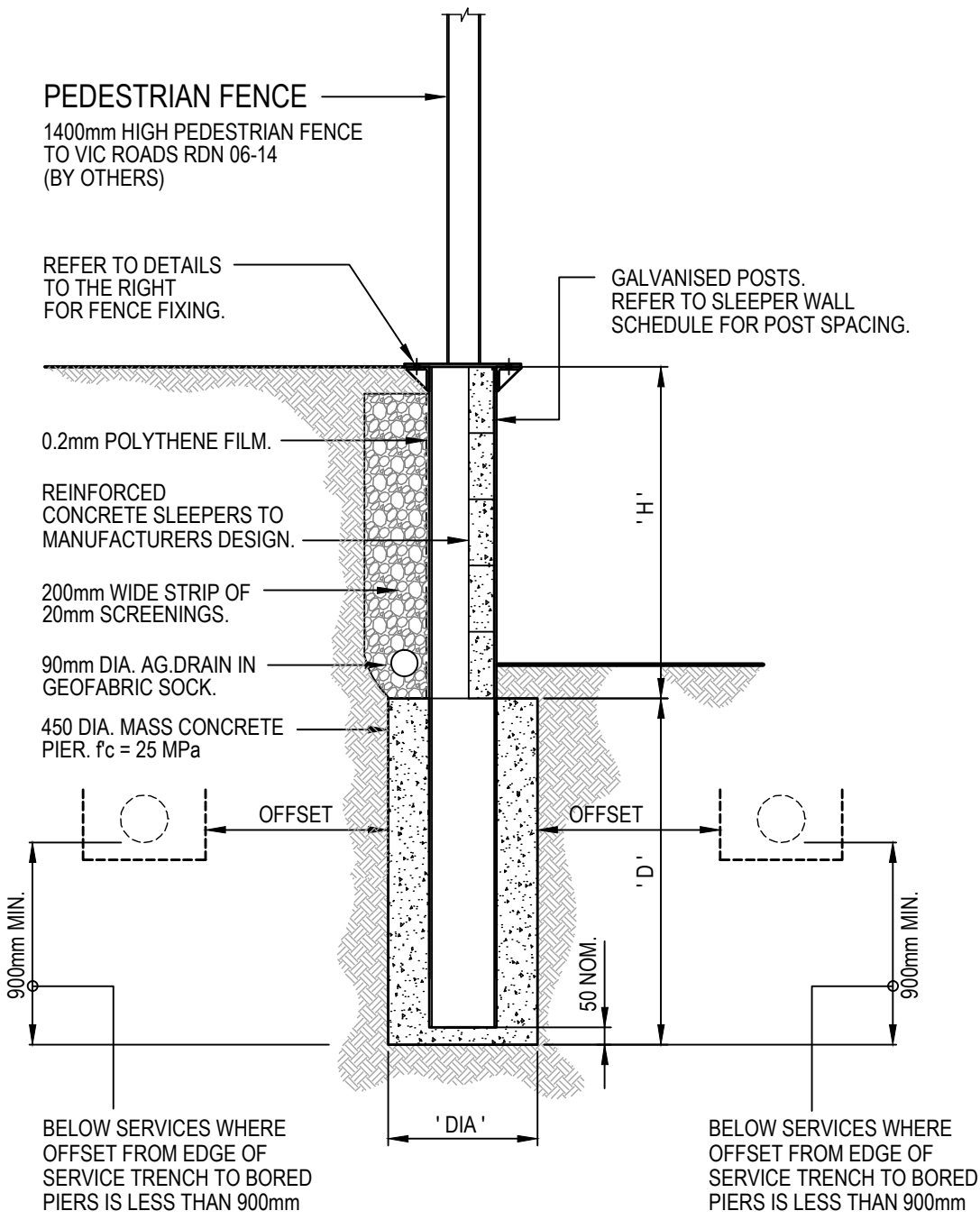

REINFORCED CONCRETE SLEEPER RETAINING WALL
WITH 1.4m HIGH PEDESTRIAN FENCE TO VIC ROADS STANDARDS
SCALE 1:20

- REFER BEVERIDGE WILLIAMS DRAWINGS FOR WALL LOCATIONS AND HEIGHTS.
- WHERE BASALT IS PRESENT, THE BORED PIER FOOTINGS SHALL BE SOCKETED 900mm MINIMUM INTO SOLID UNDISTURBED BEDROCK

SLEEPER WALL SCHEDULE				
SPACING OF POSTS (mm)	RETAINED HEIGHT 'H'	DEPTH 'D'	POST SIZE	DIAMETER 'DIA' OF PIER (mm)
2400	0 - 600mm	1300	150 UB 14	450
2400	601 - 800mm	1700	150 UB 14	450
2400	801 - 1000mm	2000	150 UB 14	450
2400	1001 - 1200mm	2400	150 UB 14	450
2400	1201 - 1400mm	2700	150 UB 18	450
2400	1401 - 1600mm	3000	150 UB 18	450
2400	1601 - 1800mm	3300	200 UB 22	450

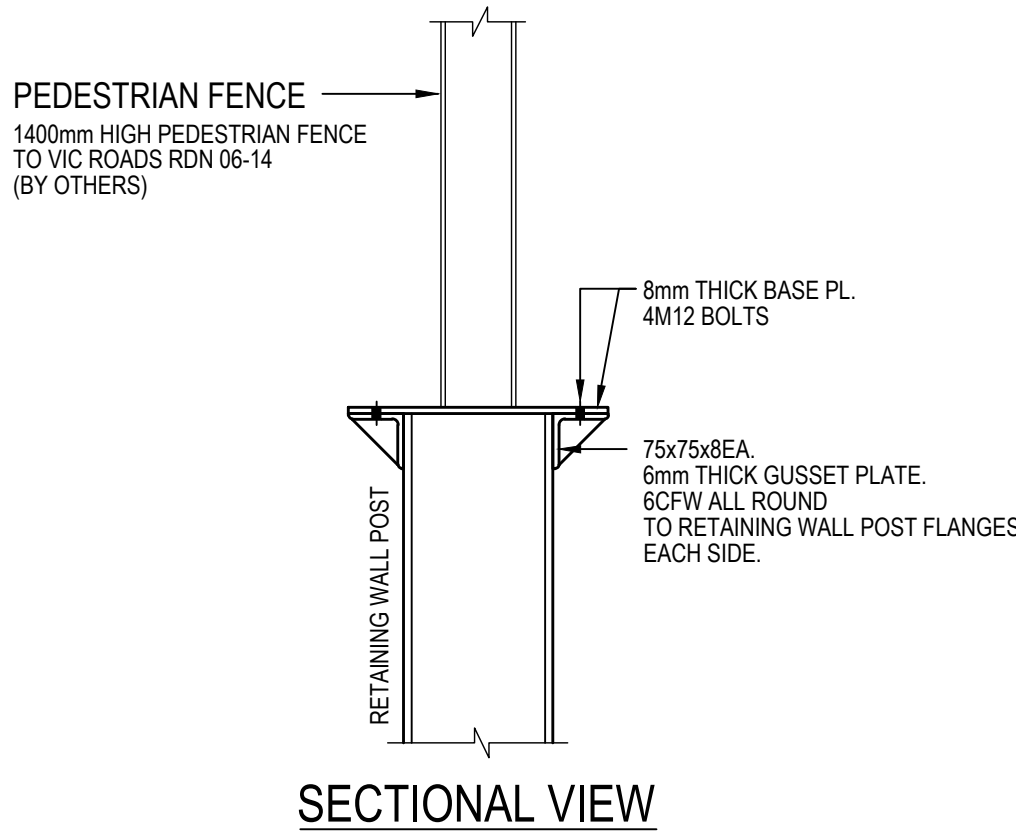

FENCE POST BASE FIXING DETAIL TO 150 UB
SCALE 1:10

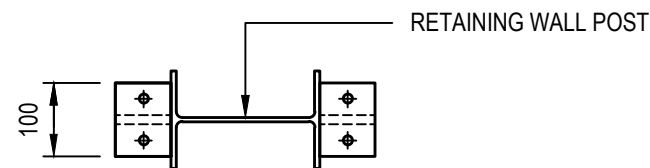

PLAN VIEW

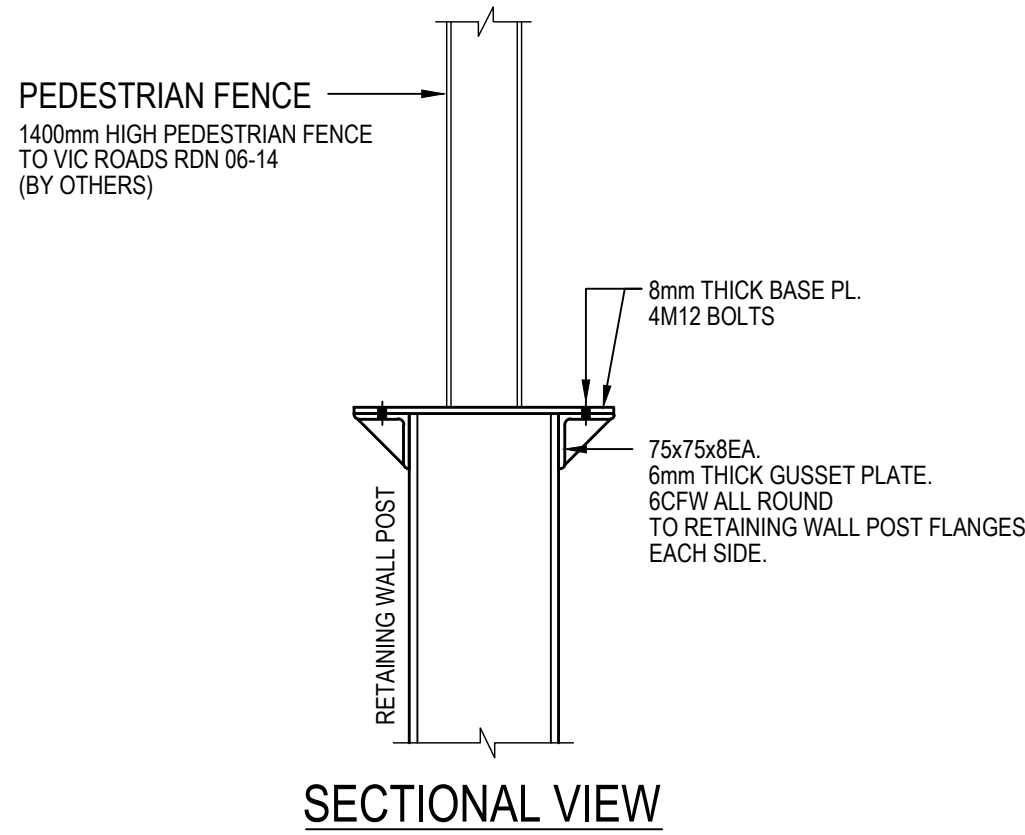

FENCE POST BASE FIXING DETAIL TO 200 UB
SCALE 1:10

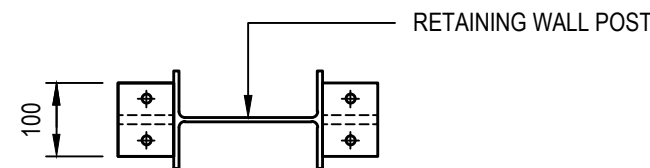

PLAN VIEW

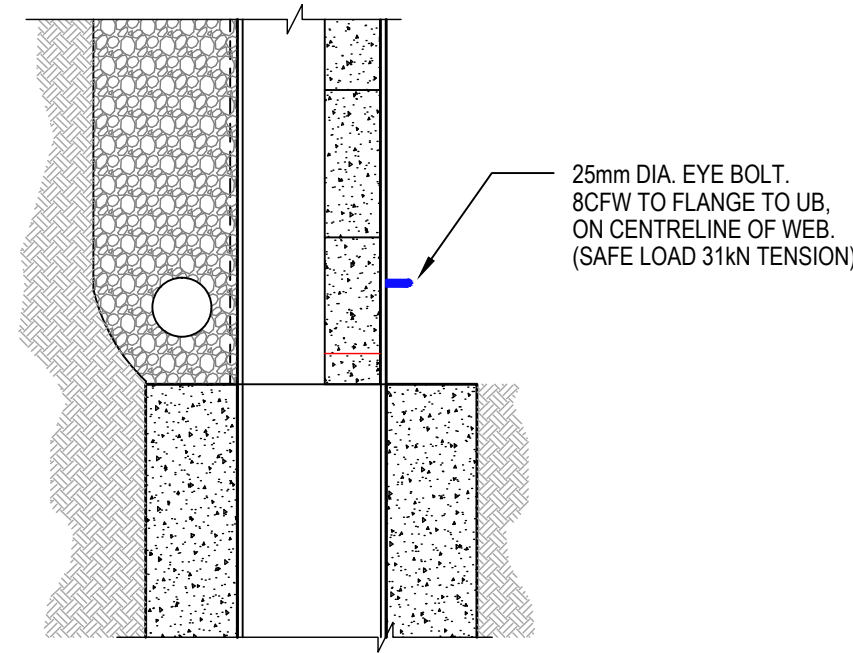

TYPICAL ELECTRICAL EYE BOLT DETAIL
SCALE 1:10

City of Casey

Approved By: **Irshad Ghazi**
Planning Ref: **PA22-0318**
File No: **SEng00025/25**
Council Ref: **R6327**
Date : **25/09/2025**

Approval subject to below conditions:

- Works are to be carried out in accordance with an approved Environmental Management Plan (EMP) and Traffic Management Plan (TMP).
- Relevant service authorities notification and approval is obtained.
- Before starting any work, the contractor must contact Council's Construction Supervision Team on 9705 5200 to arrange Council supervision of the works.
- PDF copy of the "As-constructed" engineering plans must be submitted to engineeringplans@casey.vic.gov.au with references to Council reference numbers.
- A CCTV report must be submitted to the Council supervisor and SubdivisionsConstruction@casey.vic.gov.au for all drainage lines prior to issue of practical completion.
- As-constructed plans and asset information (A-SPEC format) must be provided to Council's satisfaction before statement of compliance will be issued. Grid Coordinates must be MGA Zone 55 (GDA 2020).



APPROVAL

CIVIL

Designed	Date
M ALLAN	APRIL 2023
Drawn	Scale
M.T	AS SHOWN @ A1 SHEET

MA CIVIL DESIGN PTY LTD

ABN: 75 128 863 445
0424 811 015
+61 3 9830 1101
55 Sir Garnet Rd, Surrey Hills, VIC
design@macivil.com.au
www.macivil.com.au

Project Title :

RIVERFIELD SQUARE ESTATE
1675 BALLATO ROAD,
CLYDE NORTH

Drawing Title :

RETAINING WALL DETAILS
SHEET 3

Drawing No :

177-01-S03

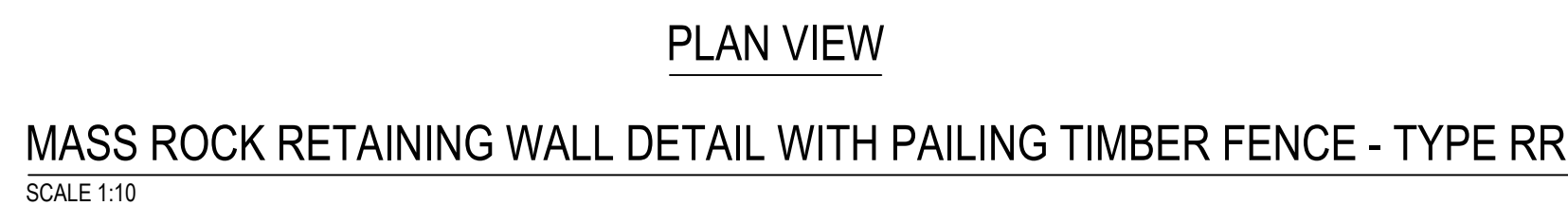

Approved By: **Irshad Ghazi**
Planning Ref: **PA22-0318**
File No: **SEng00025/25**
Council Ref: **R6327**
Date : **25/09/2025**

Approval subject to below conditions:

- Works are to be carried out in accordance with an approved Environmental Management Plan (EMP) and Traffic Management Plan (TMP).
- Relevant service authorities notification and approval is obtained.
- Before starting any work, the contractor must contact Council's Construction Supervision Team on 9705 5200 to arrange Council supervision of the works.
- PDF copy of the "As-constructed" engineering plans must be submitted to engineeringplans@casey.vic.gov.au with references to Council reference numbers.
- A CCTV report must be submitted to the Council supervisor and SubdivisionsConstruction@casey.vic.gov.au for all drainage lines prior to issue of practical completion.
- As-constructed plans and asset information (A-SPEC format) must be provided to Council's satisfaction before statement of compliance will be issued. Grid Coordinates must be MGA Zone 55 (GDA 2020).

