

- NOTES:**
- These plans are preliminary only and have not been approved by Council. They are subject to change without notice and have been provided as a guide only.
  - This plan must be read in conjunction with the Plan of Subdivision. If any discrepancies are identified between the two plans, the Plan of Subdivision takes precedence.
  - Proposed services and connection points shown are preliminary only and subject to authority advice and approval. Vehicle crossing locations shown are subject to Council approval.
  - Existing surface levels refer to the existing surface surveyed by Beveridge Williams & Co Pty Ltd in August 2021.
  - Finished surface levels shown are preliminary only and may be subject to change during design and/or construction.
  - The depth of fill can be determined by calculating the depth between the existing and proposed finished surface levels.
  - Fill depths do not take into account any removal of topsoil, grubbing, or excavation associated with the construction of any temporary or permanent infrastructure within the subdivision.
  - The plan shows the indicative extent of fill greater than 200mm in depth. These extents may be subject to change during design and/or construction. Fill less than 200mm in depth is not shown on this plan.
  - The fill depth shown on this plan is for fill placed during construction of the subdivision whilst the site is under the control of Beveridge Williams & Co Pty Ltd. Beveridge Williams & Co Pty Ltd has no further knowledge or records of any other filling works throughout this subdivision, including prior to the survey being undertaken, or after the completion of construction.
  - Beveridge Williams & Co Pty Ltd will not be liable for any loss or damages incurred or suffered by any party due to the use of the plan or relying on the information contained within the plan.
  - Fill volumes and depths are calculated between the design surface and existing surface, except in areas where standing water was present in the August 2021 survey. In areas where standing water was present in 2021, existing surface levels are shown to an additional survey completed during construction. Areas of standing water will be dewatered, desludged and filled under level 1 supervision.
  - In areas where standing water has been dewatered, desludged, and filled under level 1 supervision the approximate fill depths have been outlined in the above table.

SERVICE OFFSET TABLE

Location	Gas		ND - Water		Water		Electricity		Telecommunication		Sewer	
	Side	Offset (m)	Side	Offset (m)	Side	Offset (m)	Side	Offset (m)	Side	Offset (m)	Side	Offset (m)
BANKSIA WAY	N	2.10	N	2.50	N	2.95	S	2.60	S	1.90	N/S	1.30
GREVILLEA CIRCUIT	E	2.10	E	2.50	E	2.95	W	2.60	W	1.90	W/E	1.30/1.00
KHAKI DRIVE	S	2.10	S	2.50	S	2.95	N	2.60	N	1.90	S	1.00
TIMBERWOLF DRIVE	E	2.10	E	2.50	E	2.95	W	2.60	W	1.90	E	1.00

NOTE: STREET TREES ARE TO BE PLANTED IN THE CENTRE OF ALL NATURE STRIPS

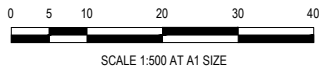

**WARNING**  
**BWARE OF UNDERGROUND SERVICES**  
The locations of underground services are approximate only and their exact position should be proven on site.  
No guarantee is given that all existing services are shown.  
Locate all underground services before commencement of works  
**DIAL 1100 BEFORE YOU DIG**  
www.1100.com.au

PRELIMINARY PRINT  
NOT FOR CONSTRUCTION

REV	DESCRIPTION	DATE	DRN.	APP.	REV	DESCRIPTION	DATE	DRN.	APP.
P4	ROAD NAME UPDATED	07.08.25	M.F.J.	S.Y.					
P3	WATER CONNECTIONS RELOCATED FOR LOTS 3131,3132	14.03.25	K.L.W.	S.Y.					
P2	UPDATED DRIVEWAY LOCATION	23.10.24	K.L.W.	S.Y.					
P1	ISSUED FOR INFORMATION	27.08.24	K.L.W.	N.B.					



Designed: K.LIM WAN  
Date: 20.08.2024  
Drawn: K.LIM WAN  
Checked: N.BALL  
Date: 20.08.2024  
Approved: N.BALL  
Reg. No: PE0009351  
Date: 20.08.2024  
PS Number: PS927176S

**BW Beveridge Williams**  
Development & Infrastructure Consultants  
1 Glenferrie Road  
Malvern VIC 3144  
ph: 03 9524 8888  
www.beveridgewilliams.com.au

Project Details  
RIVERFIELD SQUARE  
STAGE 31  
CITY OF CASEY  
Drawing Title  
MARKETING PLAN  
(SHEET 1 OF 2)

Sheet 01 of 02

Scale  
1:500 @ A1

Project Ref: 2101578  
Stage No: 31  
Drawing No: M01  
Rev: P4



DIGITAL RENDER - LOCATION 1  
INTERSECTION OF KHAKE STREET & TIMBERWOLF DRIVE LOOKING NORTH WEST



DIGITAL RENDER - LOCATION 2  
INTERSECTION OF BANKSIA WAY & TIMBERWOLF DRIVE LOOKING NORTH EAST

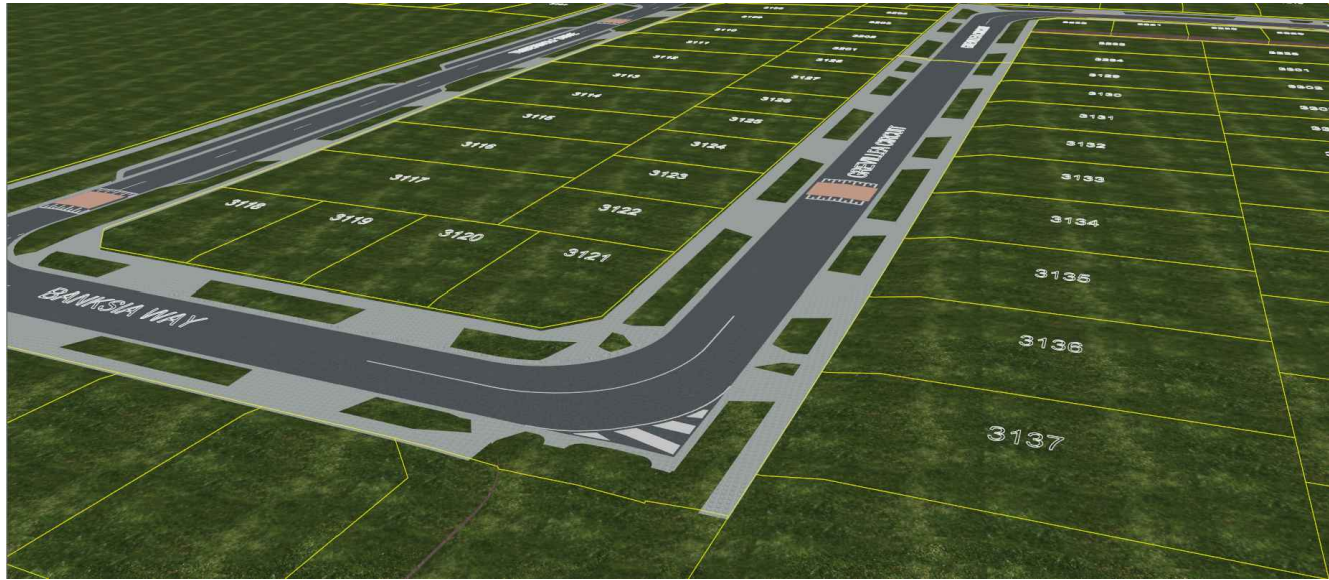

DIGITAL RENDER - LOCATION 3  
INTERSECTION OF BANKSIA WAY & GREVILLEA CIRCUIT LOOKING NORTH WEST

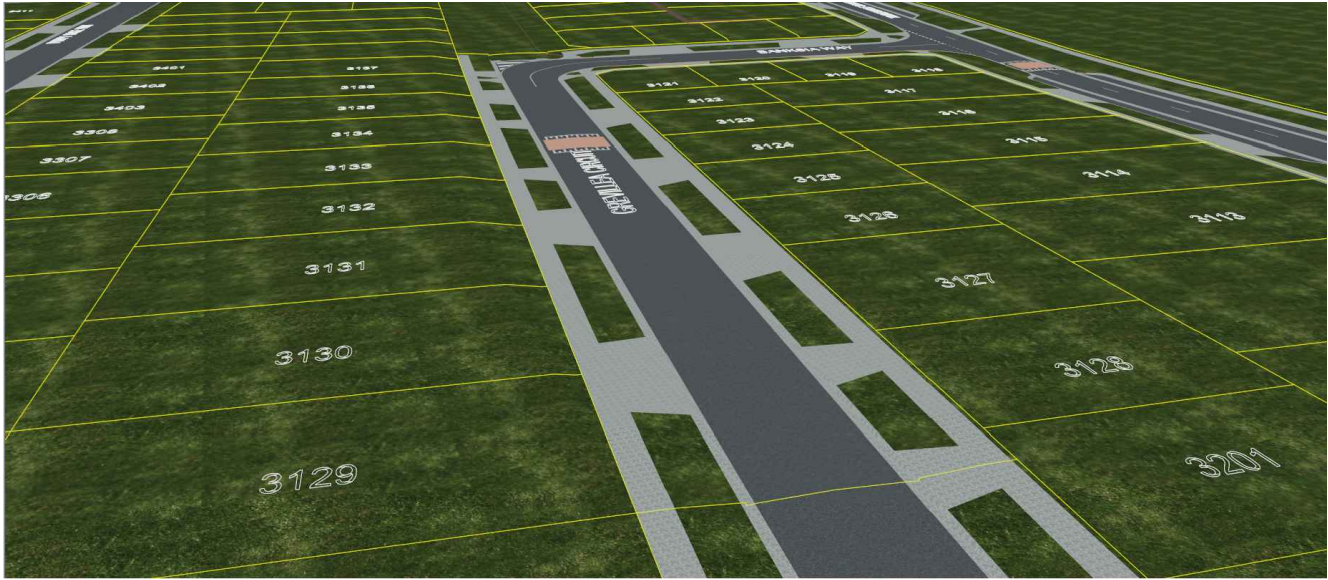

DIGITAL RENDER - LOCATION 4  
GREVILLEA CIRCUIT LOOKING SOUTH

PRELIMINARY PRINT  
NOT FOR CONSTRUCTION

© COPYRIGHT All rights reserved Beveridge Williams & Co. Pty Ltd has granted a licence to the principle to use this document for its intended purpose. No unauthorised copying is permitted									
P4	ROAD NAME UPDATED	07.08.25	M.F.J.	S.Y.					
P3	WATER CONNECTIONS RELOCATED FOR LOTS 3131,3132	14.03.25	KLW	SY					
P2	UPDATED DRIVEWAY LOCATION	23.10.24	KLW	SY					
P1	ISSUED FOR INFORMATION	27.08.24	KLW	NB					
REV	DESCRIPTION	DATE	DRN	APP.	REV	DESCRIPTION	DATE	DRN	APP.



Designed  
Date

K.LIM WAN  
20.08.2024

Drawn

K.LIM WAN

Checked  
Date

N.BALL  
20.08.2024

Approved  
Reg. No.  
Date

N.BALL  
PE00063511  
20.08.2024

PS Number

PS927176S

Beveridge Williams

Development & Infrastructure Consultants

1 Glenferrie Road  
Malvern VIC 3144

ph: 03 9524 8888  
www.beveridgewilliams.com.au

Project Details	RIVERFIELD SQUARE STAGE 31 CITY OF CASEY			Sheet 02 of 02	
	Scale NOT TO SCALE				
Drawing Title	MARKETING PLAN (SHEET 2 OF 2)				
	Project Ref	Stage No	Drawing No	Rev	
	2101578	31	M02	P4	