

LEGEND - MARKETING PLAN

- STORMWATER DRAIN, PIT & PROPERTY INLET
- MELBOURNE WATER DRAIN & PIT
- SWALE DRAIN
- SEWER & MAINTENANCE STRUCTURES
- HOUSE DRAIN
- SERVICE CONDUITS
- TACTILE PAVERS
- ELECTRICITY (UNDERGROUND)
- ELECTRICITY (OVERHEAD)
- OPTIC FIBRE
- TELECOMMUNICATIONS
- GAS
- WATER
- RECYCLED WATER
- EXISTING ELECTRICITY (UNDERGROUND)
- EXISTING ELECTRICITY (OVERHEAD)
- EXISTING GAS
- EXISTING OPTIC FIBRE
- EXISTING TELECOMMUNICATIONS
- EXISTING WATER
- EXISTING RECYCLED WATER
- EXISTING STORMWATER DRAIN

LEGEND:

- PAVEMENT TREATMENT
- STRUCTURAL FILL > 200mm DEEP
- EX. STRUCTURAL FILL > 200mm DEEP
- LOT HATCHING
- ROAD PAVEMENT
- FOOTPATH
- DRIVEWAY
- INDUSTRIAL STRENGTH DRV / LANEWAYS
- NATURE STRIP
- RESERVES
- ELECTRICAL KIOSK
- DRAINAGE RESERVE
- MEDIAN DENSITY LOTS

- NOTES:**
- These plans are preliminary only and have not been approved by Council. They are subject to change without notice and have been provided as a guide only.
 - This plan must be read in conjunction with the Plan of Subdivision. If any discrepancies are identified between the two plans, the Plan of Subdivision takes precedence.
 - Proposed services and connection points shown are preliminary only and subject to authority advice and approval. Vehicle crossing locations shown are subject to Council approval.
 - Existing surface levels refer to the existing surface surveyed by Beveridge Williams & Co Pty Ltd in August 2021.
 - Finished surface levels shown are preliminary only and may be subject to change during design and/or construction.
 - The depth of fill can be determined by calculating the depth between the existing and proposed finished surface levels.
 - Fill depths do not take into account any removal of topsoil, grubbing, or excavation associated with the construction of any temporary or permanent infrastructure within the subdivision.
 - The plan shows the indicative extent of fill greater than 200mm in depth. These extents may be subject to change during design and/or construction. Fill less than 200mm in depth is not shown on this plan.
 - The fill depth shown on this plan is for fill placed during construction of the subdivision whilst the site is under the control of Beveridge Williams & Co Pty Ltd. Beveridge Williams & Co Pty Ltd has no further knowledge or records of any other filling works throughout this subdivision, including prior to the survey being undertaken, or after the completion of construction.
 - Beveridge Williams & Co Pty Ltd will not be liable for any loss or damages incurred or suffered by any party due to the use of the plan or relying on the information contained within the plan.
 - Fill volumes and depths are taken from the design surface to existing surface only. During construction, it is likely the site will be required to be over stripped to find a solid base prior to filling. As such, actual fill depth may be greater than indicated on these plans.

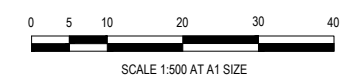

WARNING
BEWARE OF UNDERGROUND SERVICES
The locations of underground services are approximate only and their exact position should be proven on site.
No guarantee is given that all existing services are shown.
Locate all underground services before commencement of works
DIAL 1100 BEFORE YOU DIG
www.1100.com.au

PRELIMINARY PRINT
NOT FOR CONSTRUCTION

REV	DESCRIPTION	DATE	DRN.	APP.	REV	DESCRIPTION	DATE	DRN.	APP.
P4	LOT LEVELS UPDATED	21.02.24	KLW	NB	P9	RETAINING WALL ADDED IN LOT 2741	13.08.25	KLW	SF
P3	RETAINING WALL UPDATES	13.12.23	AP	NB	P8	LEVELS UPDATED FOR LOTS 2703-2714	14.07.25	AJ	SF
P2	RETAINING WALL UPDATES	20.11.23	AP	SY	P7	LOT 2714 DRIVEWAY UPDATED	29.05.25	KLW	AP
P1	MINOR LAYOUT UPDATES	31.08.23	BL	NB	P6	RESERVE ADDED AND LOT BOUNDARY CHANGES	21.02.25	AP	SY
P0	ISSUED FOR INFORMATION	27.07.23	BL	SY	P5	UPDATED RETAINING WALL LEGEND	10.01.25	AP	SY
							04.03.24	NB	NB

BROWN COMMUNITIES

Riverfield square CLYDE

Designed Date: 31.08.2023
Drawn: B.LEONG
Checked Date: 31.08.2023
Approved Reg. No.: N.BALL
Date: 31.08.2023
PS Number: PS919003W

BW Beveridge Williams
Development & Infrastructure Consultants
1 Glenferrie Road
Malvern VIC 3144
ph: 03 9524 8888
www.beveridgewilliams.com.au

Project Details: RIVERFIELD SQUARE STAGE 27 CITY OF CASEY
Drawing Title: MARKETING PLAN (SHEET 1 OF 2)

Sheet 01 of 02
Scale: 1:500 @ A1
Project Ref: 2101578 Stage No: 27 Drawing No: M01 Rev: P10

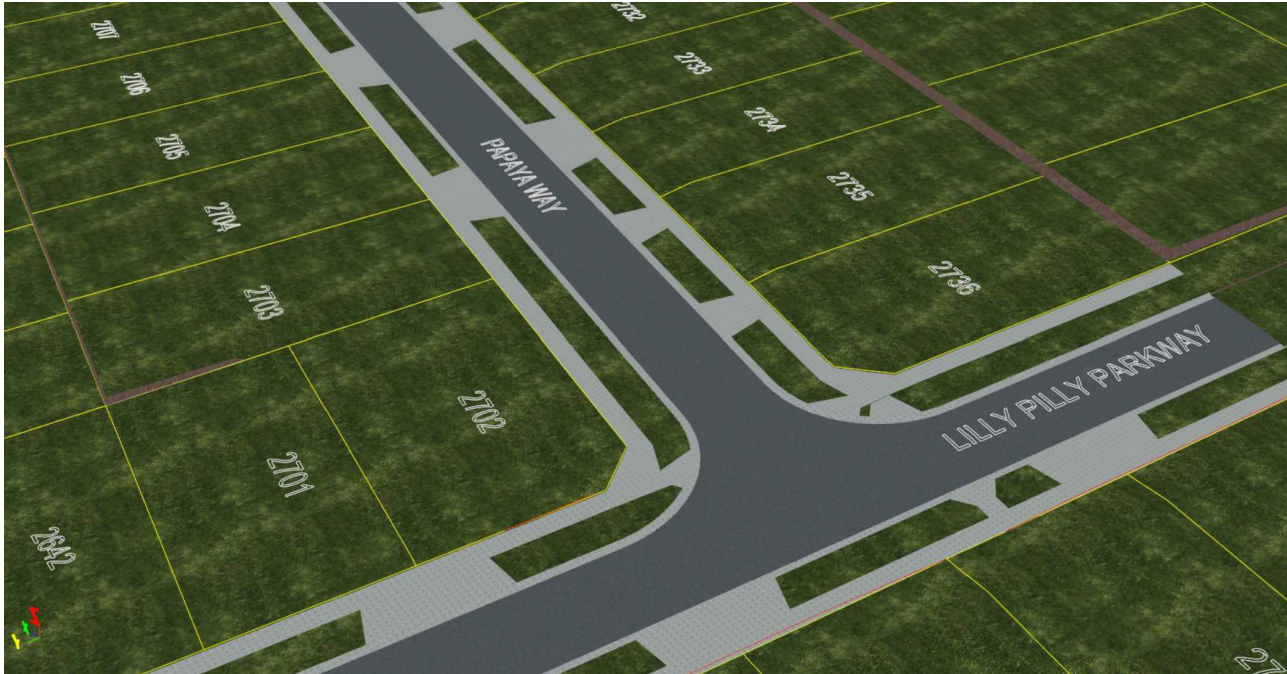

DIGITAL RENDER - LOCATION 1
INTERSECTION OF PAPAYA WAY AND LILLY PILLY PARKWAY LOOKING SOUTH EAST

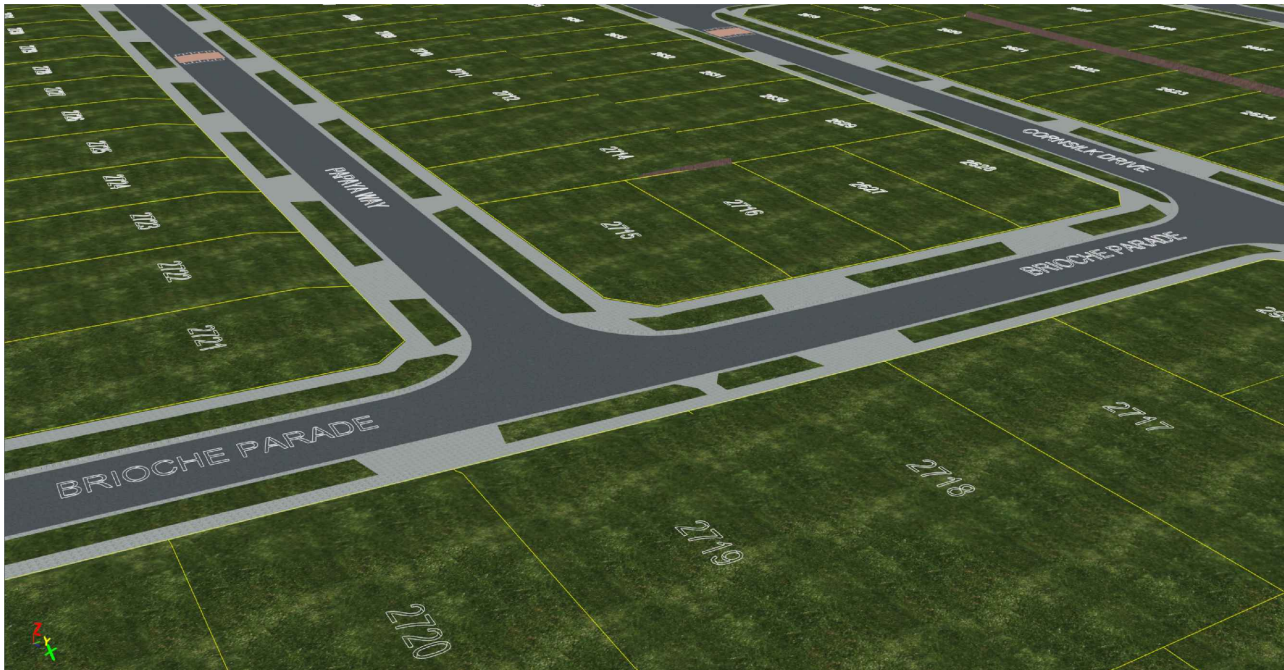

DIGITAL RENDER - LOCATION 2
INTERSECTION OF PAPAYA WAY AND BRIOCHE PARADE LOOKING NORTH WEST

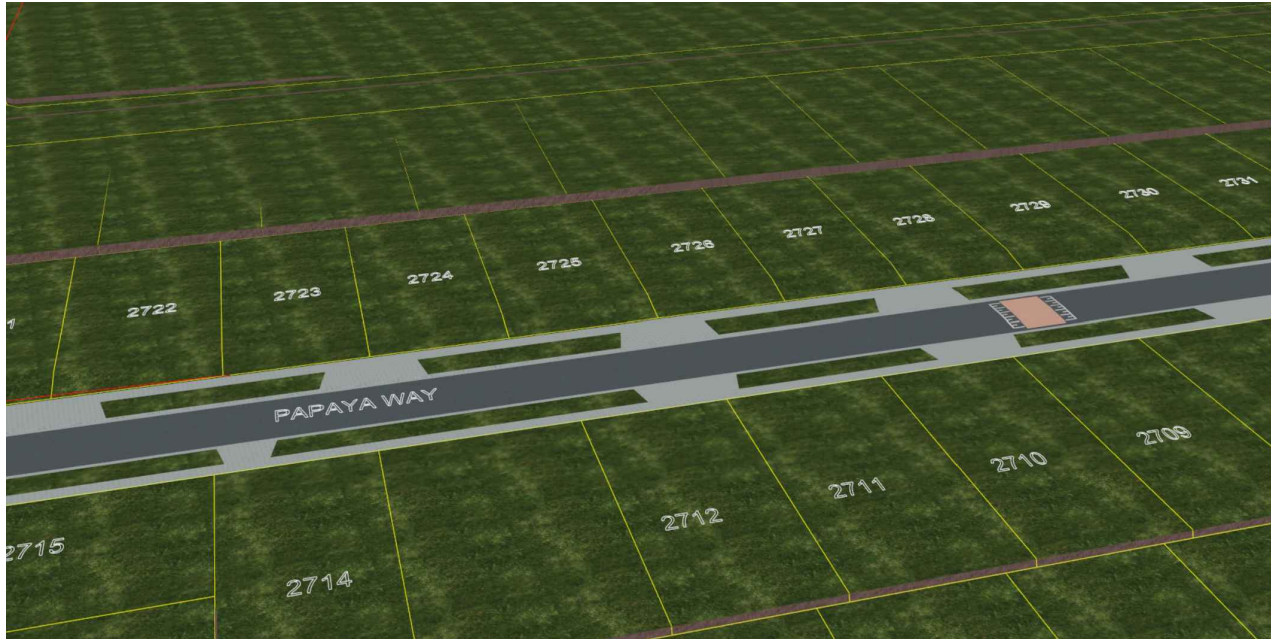

DIGITAL RENDER - LOCATION 3
MID-POINT OF PAPAYA WAY LOOKING SOUTH

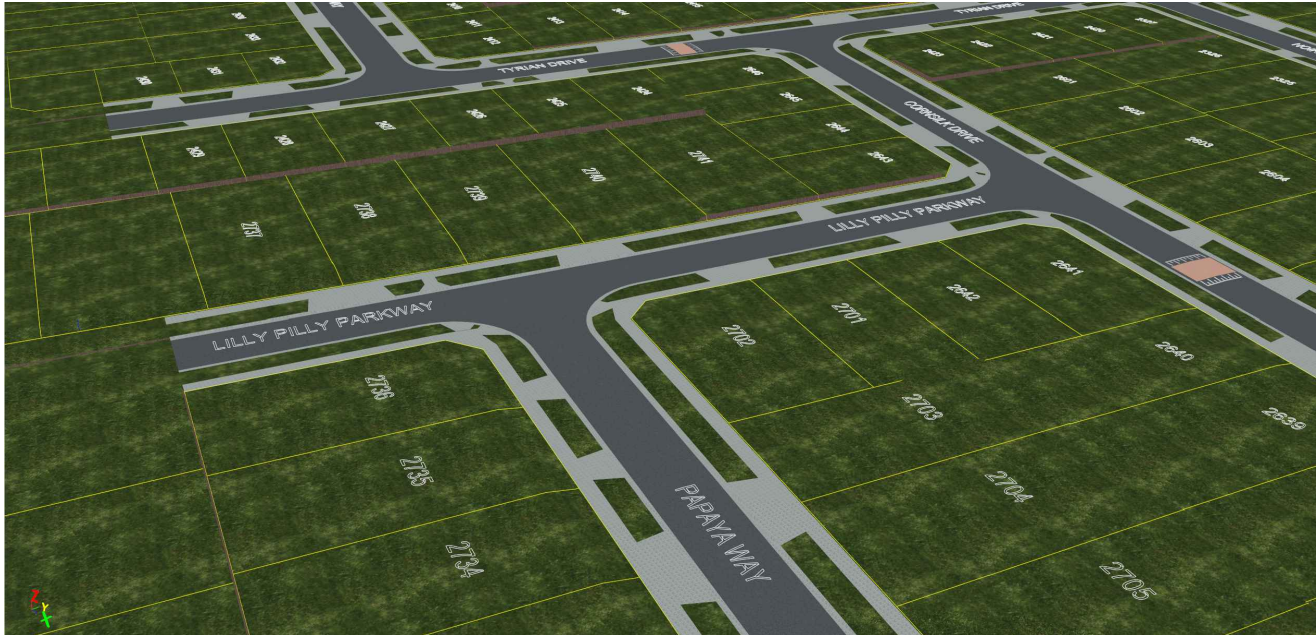

DIGITAL RENDER - LOCATION 4
INTERSECTION OF PAPAYA WAY AND LILLY PILLY PARKWAY LOOKING WEST

PRELIMINARY PRINT
NOT FOR CONSTRUCTION

Sheet 02 of 02

Scale
NOT TO SCALE

Project Ref
2101578

Stage No
27

Drawing No
M02

Rev
P10

<div>© COPYRIGHT All rights reserved Beveridge Williams & Co. Pty Ltd has granted a licence to the principle to use this document for its intended purpose. No unauthorised copying is permitted</div>									
P4	LOT LEVELS UPDATED	21.02.24	KLW	NB	P9	RETAINING WALL ADDED IN LOT 2741	13.08.25	KLW	SF
P3	RETAINING WALL UPDATES	13.12.23	AP	NB	P8	LOT 2735 CROSSOVER UPDATED	14.07.25	AJ	SF
P2	RETAINING WALL UPDATES	20.11.23	AP	SY	P7	LEVELS UPDATED FOR LOTS 2703-2714	29.05.25	KLW	AP
P1	MINOR LAYOUT UPDATES	31.08.23	BL	NB	P6	LOT 2714 DRIVEWAY UPDATED	21.02.25	AP	SY
P0	ISSUED FOR INFORMATION	27.07.23	BL	SY	P5	RESERVE ADDED AND LOT BOUNDARY CHANGES	10.01.25	AP	SY
REV	DESCRIPTION	DATE	DRN.	APP.	REV	DESCRIPTION	DATE	DRN.	APP.
						UPDATED RETAINING WALL LEGEND	04.03.24	NB	NB



Designed
Date

31.08.2023

Drawn

B.LEONG

Checked
Date

31.08.2023

Approved
Reg. No.
Date

N.BALL
PE00063511
31.08.2023

PS Number

PS919003W

Beveridge Williams

Development & Infrastructure Consultants

1 Glenferrie Road
Malvern VIC 3144

ph: 03 9524 8888
www.beveridgewilliams.com.au

Project
Details

RIVERFIELD SQUARE
STAGE 27
CITY OF CASEY

Drawing
Title

MARKETING PLAN
(SHEET 2 OF 2)

Project Ref
2101578

Stage No
27

Drawing No
M02

Rev
P10