

LEGEND - MARKETING PLAN

- STORMWATER DRAIN, PIT & PROPERTY INLET
- MELBOURNE WATER DRAIN & PIT
- SWALE DRAIN
- SEWER & MAINTENANCE STRUCTURES
- HOUSE DRAIN
- SERVICE CONDUITS
- TACTILE PAVERS
- ELECTRICITY (UNDERGROUND)
- ELECTRICITY (OVERHEAD)
- OPTIC FIBRE
- TELECOMMUNICATIONS
- GAS
- WATER
- RECYCLED WATER
- EXISTING ELECTRICITY (UNDERGROUND)
- EXISTING ELECTRICITY (OVERHEAD)
- EXISTING GAS
- EXISTING OPTIC FIBRE
- EXISTING TELECOMMUNICATIONS
- EXISTING WATER
- EXISTING RECYCLED WATER
- EXISTING STORMWATER DRAIN

LEGEND:

- PAVEMENT TREATMENT
- STRUCTURAL FILL > 200mm DEEP
- EX. STRUCTURAL FILL > 200mm DEEP
- LOT HATCHING
- ROAD PAVEMENT
- FOOTPATH
- DRIVEWAY
- INDUSTRIAL STRENGTH DRV / LANEWAYS
- NATURE STRIP
- RESERVES
- ELECTRICAL KIOSK
- DRAINAGE RESERVE

NOTES:

- These plans are preliminary only and have not been approved by Council. They are subject to change without notice and have been provided as a guide only.
- This plan must be read in conjunction with the Plan of Subdivision. If any discrepancies are identified between the two plans, the Plan of Subdivision takes precedence.
- Proposed services and connection points shown are preliminary only and subject to authority advice and approval. Vehicle crossing locations shown are subject to Council approval.
- Existing surface levels refer to the existing surface surveyed by Beveridge Williams & Co Pty Ltd in August 2021.
- Finished surface levels shown are preliminary only and may be subject to change during design and/or construction.
- The depth of fill can be determined by calculating the depth between the existing and proposed finished surface levels.
- Fill depths do not take into account any removal of topsoil, grubbing, or excavation associated with the construction of any temporary or permanent infrastructure within the subdivision.
- The plan shows the indicative extent of fill greater than 200mm in depth. These extents may be subject to change during design and/or construction. Fill less than 200mm in depth is not shown on this plan.
- The fill depth shown on this plan is for fill placed during construction of the subdivision whilst the site is under the control of Beveridge Williams & Co Pty Ltd. Beveridge Williams & Co Pty Ltd has no further knowledge or records of any other filling works throughout this subdivision, including prior to the survey being undertaken, or after the completion of construction.
- Beveridge Williams & Co Pty Ltd will not be liable for any loss or damages incurred or suffered by any party due to the use of the plan or relying on the information contained within the plan.
- Fill volumes and depths are taken from the design surface to existing surface only. During construction, it is likely the site will be required to be over stripped to find a solid base prior to filling. As such, actual fill depth may be greater than indicated on these plans.

LEGEND:

- EXISTING SEWER
- EXISTING HOUSE DRAIN
- EXISTING SWALE DRAIN
- EXISTING SURFACE LEVEL
- FINISHED BUILDING LINE LEVEL
- FINISHED RIDGE LINE LEVEL
- TOP OF RETAINING WALL
- BOTTOM OF RETAINING WALL
- RIDGE LINE
- RETAINING WALL
- EXISTING RETAINING WALL
- PERMANENT SURVEY MARK
- TEMPORARY BENCH MARK
- DIRECTION OF FALL
- OVERLAND FLOW
- ALLOTMENT TO BE GRADED EVENLY IN
- DIRECTION OF FALL TO LEVELS INDICATED
- CONCRETE EDGE STRIP WITH SUBSOIL DRAIN
- "NO ROAD" SIGN & BARRIER
- PROPOSED DRIVEWAY
- LIMIT OF WORKS
- EXISTING TREE TO BE REMOVED

SERVICE OFFSET TABLE

Location	Gas		ND - Water		Water		Electricity		Telecommunication		Sewer	
	Side	Offset (m)	Side	Offset (m)	Side	Offset (m)	Side	Offset (m)	Side	Offset (m)	Side	Offset (m)
MAJORELLE WAY	E	2.10	E	2.50	E	2.95	W	2.60	W	1.90	W/E	1.00 / 1.00
CORNSILK DRIVE	N	2.10	N	2.50	N	2.95	S	2.60	S	1.90	N/S	1.00 / 1.00
LILLY PILLY PARKWAY	W	2.10	W	2.50	W	2.95	E	2.60	E	1.90	W/E	1.00 / 1.00
BROCHOE PARADE	E	2.10	E	2.50	E	2.95	W	2.60	W	1.90	E	Ex. 1.00

NOTE: STREET TREES ARE TO BE PLANTED IN THE CENTRE OF ALL NATURE STRIPS

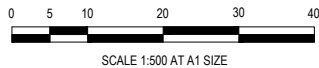

WARNING
BEWARE OF UNDERGROUND SERVICES
The locations of underground services are approximate only and their exact position should be proven on site.
No guarantee is given that all existing services are shown.
Locate all underground services before commencement of works
DIAL 1100 BEFORE YOU DIG
www.1100.com.au

PRELIMINARY PRINT
NOT FOR CONSTRUCTION

© COPYRIGHT All rights reserved Beveridge Williams & Co. Pty Ltd has granted a licence to the principle to use this document for its intended purpose. No unauthorised copying is permitted					P12	RETAINING WALL ADDED IN LILLY PILLY PARKWAY	13.08.25	KLW	AP
					P11	SEWER CONNECTIONS UPDATED FOR LOTS 2631 - 2635	29.05.25	KLW	AP
					P10	STREET NAME UPDATED	06.01.25	AP	SY
P4	RETAINING WALL UPDATES	20.11.23	AP	SY	P9	STREET NAME UPDATED	19.12.24	AP	SY
P3	STREET NAMES UPDATED	25.09.23	AP	NB	P8	2605 CROSSOVER & SPEED HUMP SHIFTED	08.05.24	NB	NB
P2	ELECTRICAL KIOSK REMOVED	11.08.23	AP	NB	P7	2641 & 2642 RIDGE ADDED	20.02.24	KLW	NB
P1	2609 & 2741 CROSSOVER MOVED	14.06.23	NB	SY	P6	SEWER ALIGNMENT UPDATES	25.01.24	NB	NB
P0	ISSUED FOR INFORMATION	06.06.23	AP	SY	P5	REVISION DELETED	15.12.23	AP	NB
REV	DESCRIPTION	DATE	DRN.	APP.	REV	DESCRIPTION	DATE	DRN.	APP.



Designed Date: 01.06.2023
Drawn: A.PHILALAY
Checked Date: 01.06.2023
Approved Reg. No.: S.YOUNG
Date: 06.06.2023
PS Number: PS913557H

BW Beveridge Williams
Development & Infrastructure Consultants
1 Glenferrie Road
Malvern VIC 3144
ph: 03 9524 8888
www.beveridgewilliams.com.au

Project Details: RIVERFIELD SQUARE
STAGE 26
CITY OF CASEY

Drawing Title: MARKETING PLAN
(SHEET 1 OF 2)

Sheet 01 of 02
Scale: 1:500 @ A1

Project Ref: 2101578
Stage No: 26
Drawing No: M01
Rev: P12

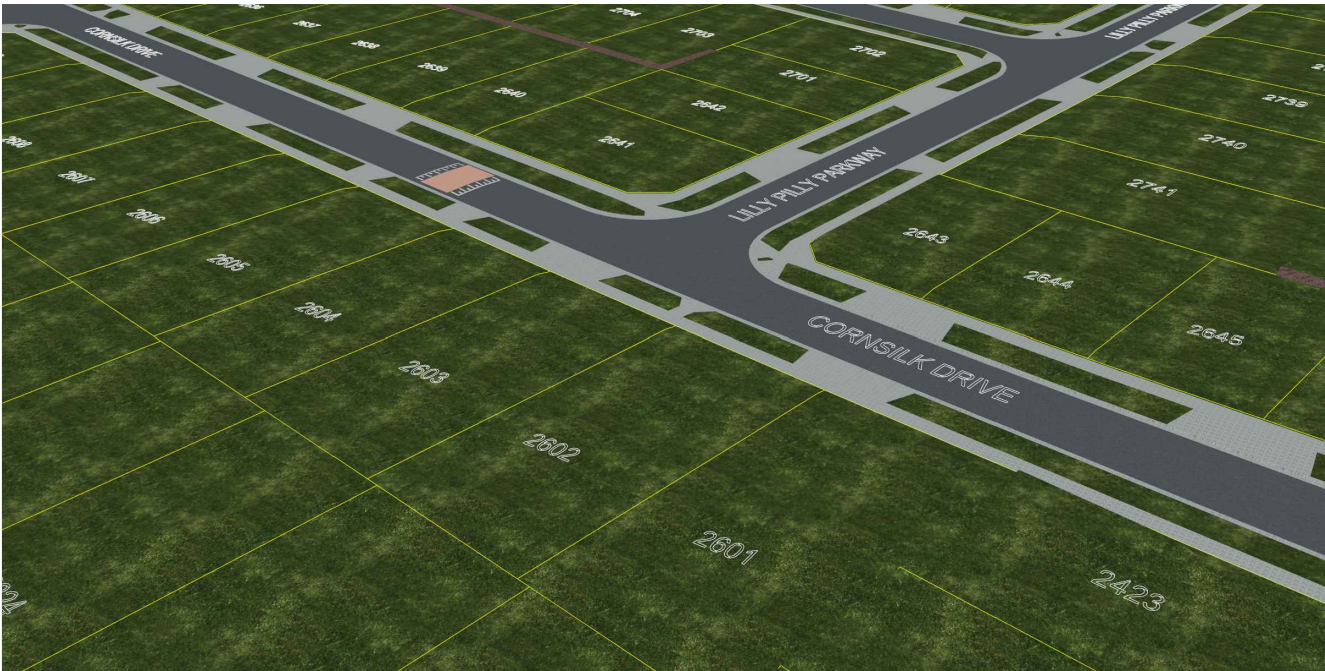

DIGITAL RENDER - LOCATION 1
CORNER OF CORNSILK DRIVE AND LILLY PILLY PARKWAY LOOKING SOUTH EAST

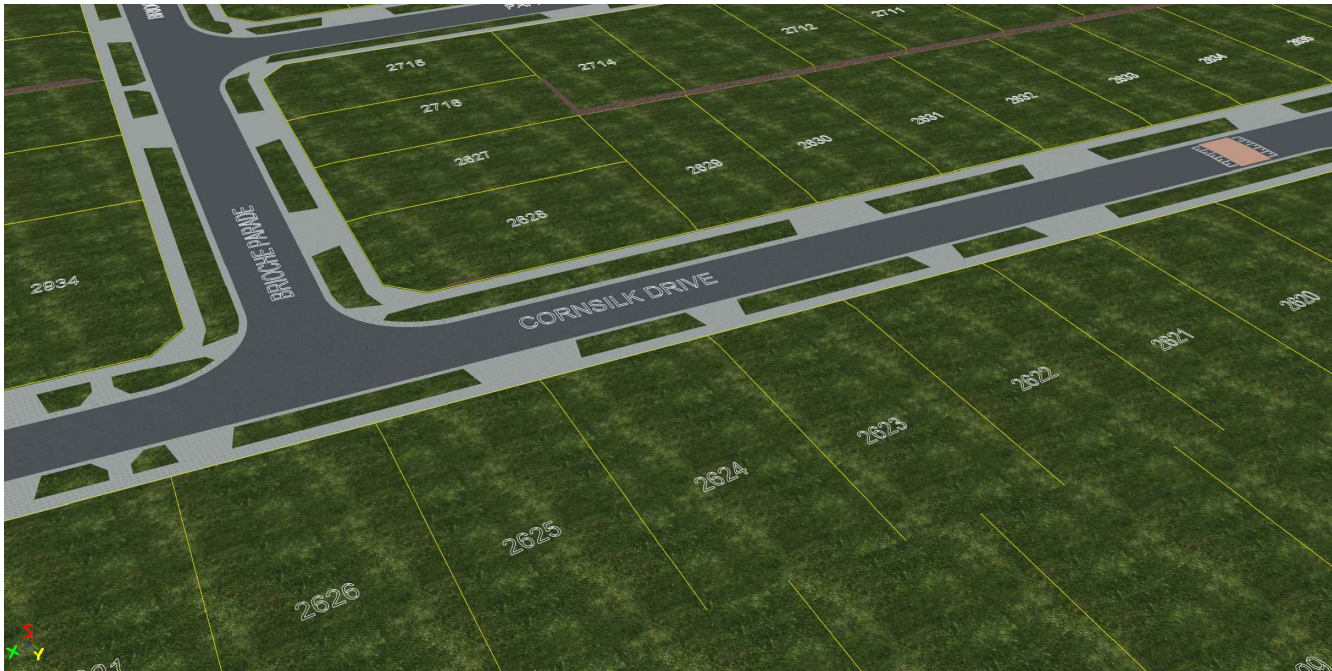

DIGITAL RENDER - LOCATION 2
CORNER OF CORNSILK DRIVE AND BRIOCHE PARADE LOOKING SOUTH WEST

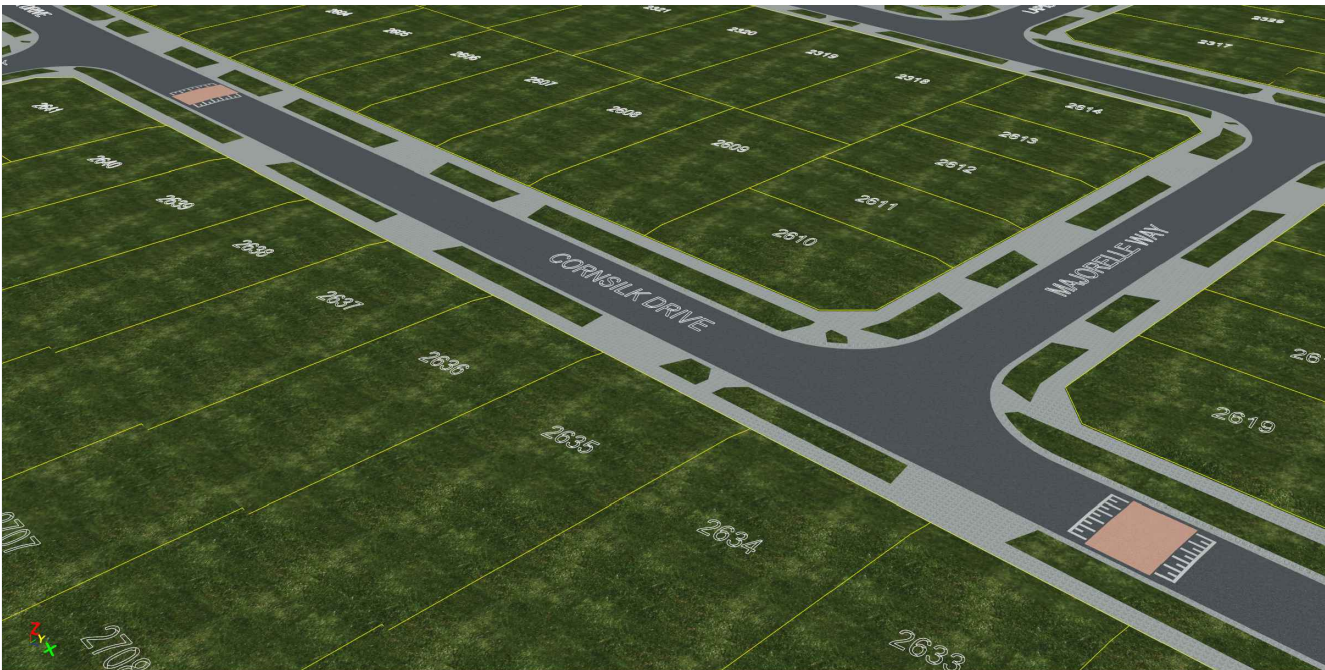

DIGITAL RENDER - LOCATION 3
CORNER OF CORNSILK DRIVE AND MAJORELLE WAY LOOKING NORTH WEST

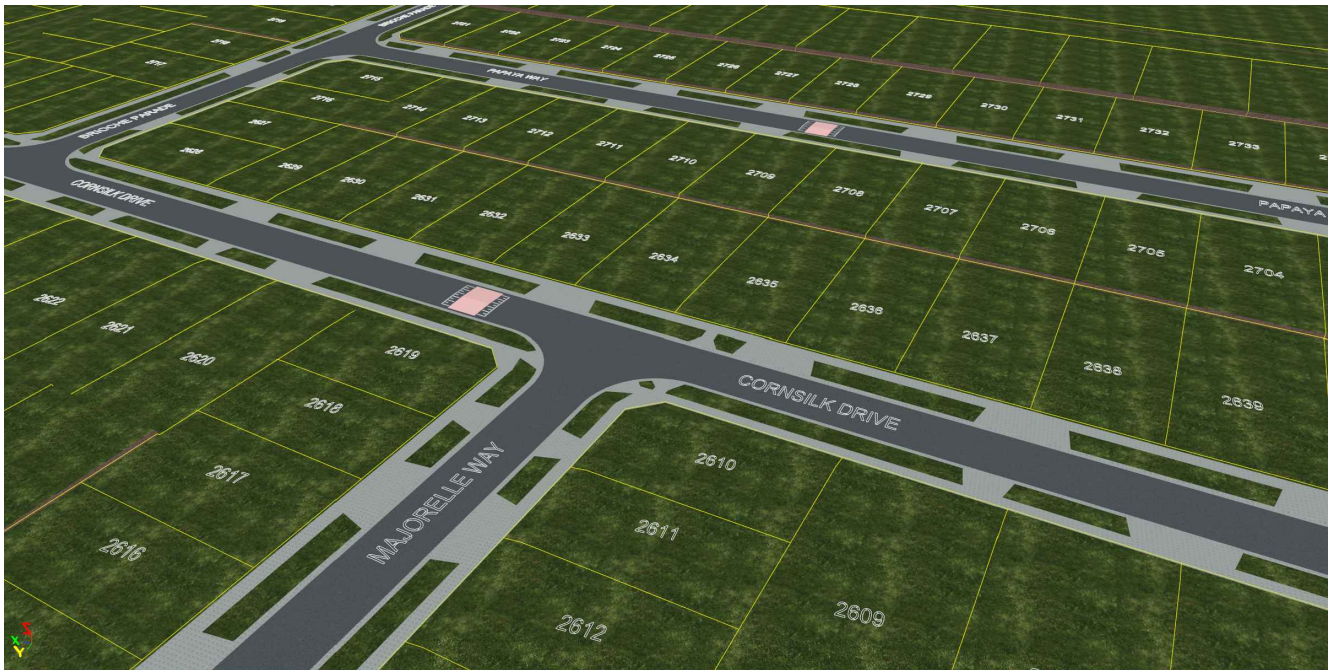

DIGITAL RENDER - LOCATION 4
CORNER OF CORNSILK DRIVE AND MAJORELLE WAY LOOKING SOUTH EAST

PRELIMINARY PRINT
NOT FOR CONSTRUCTION

Sheet 02 of 02

Scale
NOT TO SCALE

Project Ref
2101578

Stage No
26

Drawing No
M02

Rev
P12

© COPYRIGHT All rights reserved Beveridge Williams & Co. Pty Ltd has granted a licence to the principle to use this document for its intended purpose. No unauthorised copying is permitted										P12 RETAINING WALL ADDED IN LILLY PILLY PARKWAY 13.08.25 KLIW AP															
										P11 SEWER CONNECTIONS UPDATED FOR LOTS 2631 - 2635 29.05.25 KLIW AP															
										P10 STREET NAME UPDATED 06.01.25 AP SY															
P4 RETAINING WALL UPDATES 20.11.23 AP SY										P9 STREET NAME UPDATED 19.12.24 AP SY															
P3 STREET NAMES UPDATED 25.09.23 AP NB										P8 2605 CROSSOVER & SPEED HUMP SHIFTED 08.05.24 NB NB															
P2 ELECTRICAL KIOSK REMOVED 11.08.23 AP NB										P7 2641 & 2642 RIDGE ADDED 20.02.24 KLIW NB															
P1 2609 & 2741 CROSSOVER MOVED 14.06.23 NB SY										P6 SEWER ALIGNMENT UPDATES 25.01.24 NB NB															
P0 ISSUED FOR INFORMATION 06.06.23 AP SY										P5 REVISION DELETED 15.12.23 AP NB															
REV	DESCRIPTION									DATE	DRN	APP	REV	DESCRIPTION									DATE	DRN	APP

BROWN
COMMUNITIES

Riverfield square
CLYDE

BW Beveridge Williams
Development & Infrastructure Consultants
1 Glenferrie Road
Malvern VIC 3144
ph: 03 9524 8888
www.beveridgewilliams.com.au

Designed
Date
Drawn
Checked
Date
Approved
Reg. No.
Date
PS Number

ALPHILALAY
01.06.2023
ALPHILALAY
S.YOUNG
01.06.2023
S.YOUNG
PE0006609
06.06.2023
PS913557H

Project
Details
Drawing
Title

RIVERFIELD SQUARE
STAGE 26
CITY OF CASEY
MARKETING PLAN
(SHEET 2 OF 2)

Sheet 02 of 02
Scale
NOT TO SCALE
Project Ref
2101578
Stage No
26
Drawing No
M02
Rev
P12

\\bw.local\work\m\jobs\Jobs Data\2101578 - DI Renzo - 1675 Ballarto Road, Clyde_Eng\Stage 26\Drawings\2101578-26-M.dwg