

# RIVERFIELD SQUARE - STAGE 21 BUILDING ENVELOPES

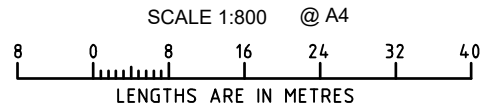

## BUILDING ENVELOPES

**SIDE SETBACKS**  
 FOR LOTS IDENTIFIED THUS: ★, A BUILD TO BOUNDARY ALLOWANCE ONLY APPLIES TO THE SIDE OF THE LOT WHERE THE CROSSOVER EXISTS. A SETBACK OF AT LEAST 1 METRE MUST BE PROVIDED FOR THE OPPOSITE SIDE BOUNDARY.

ⓁS DENOTES DWELLINGS ON THOSE LOTS MUST BE DOUBLE STOREY IN ACCORDANCE WITH THE RIVERFIELD SQUARE DESIGN ASSESSMENT PANEL.

### CERULEAN

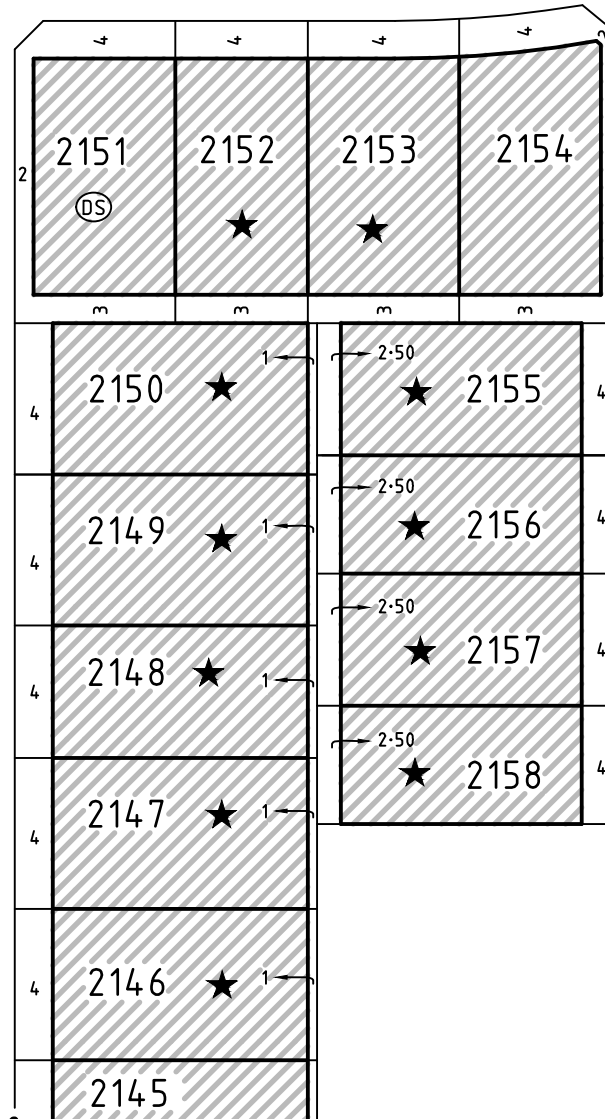

### PROMENADE

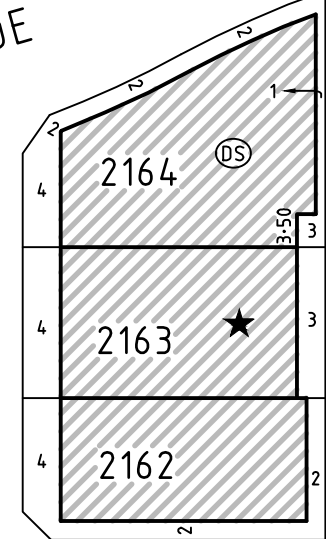

### MIKADO WAY

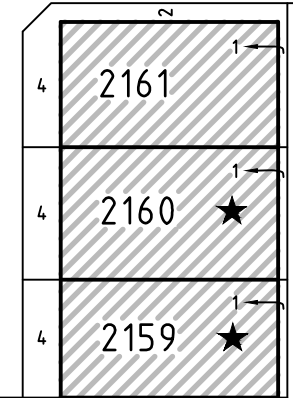

### AVENUE

### CYAN

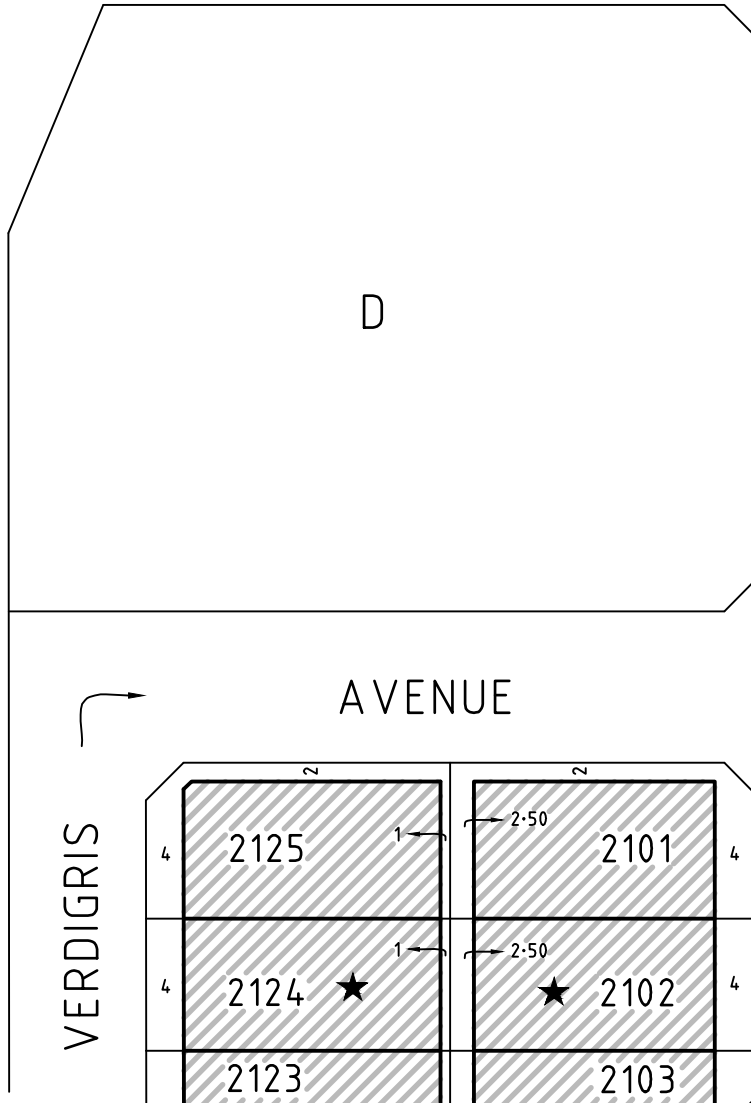

SEE SHEET 2

**BW** Beveridge Williams  
 development & environment consultants  
 Melbourne ph : 03 9524 8888  
 www.beveridgewilliams.com.au

Ref: 2101578/21 Ver G  
 2101578-21-BE-VerG.dwg

# RIVERFIELD SQUARE - STAGE 21 BUILDING ENVELOPES

SEE SHEET 1

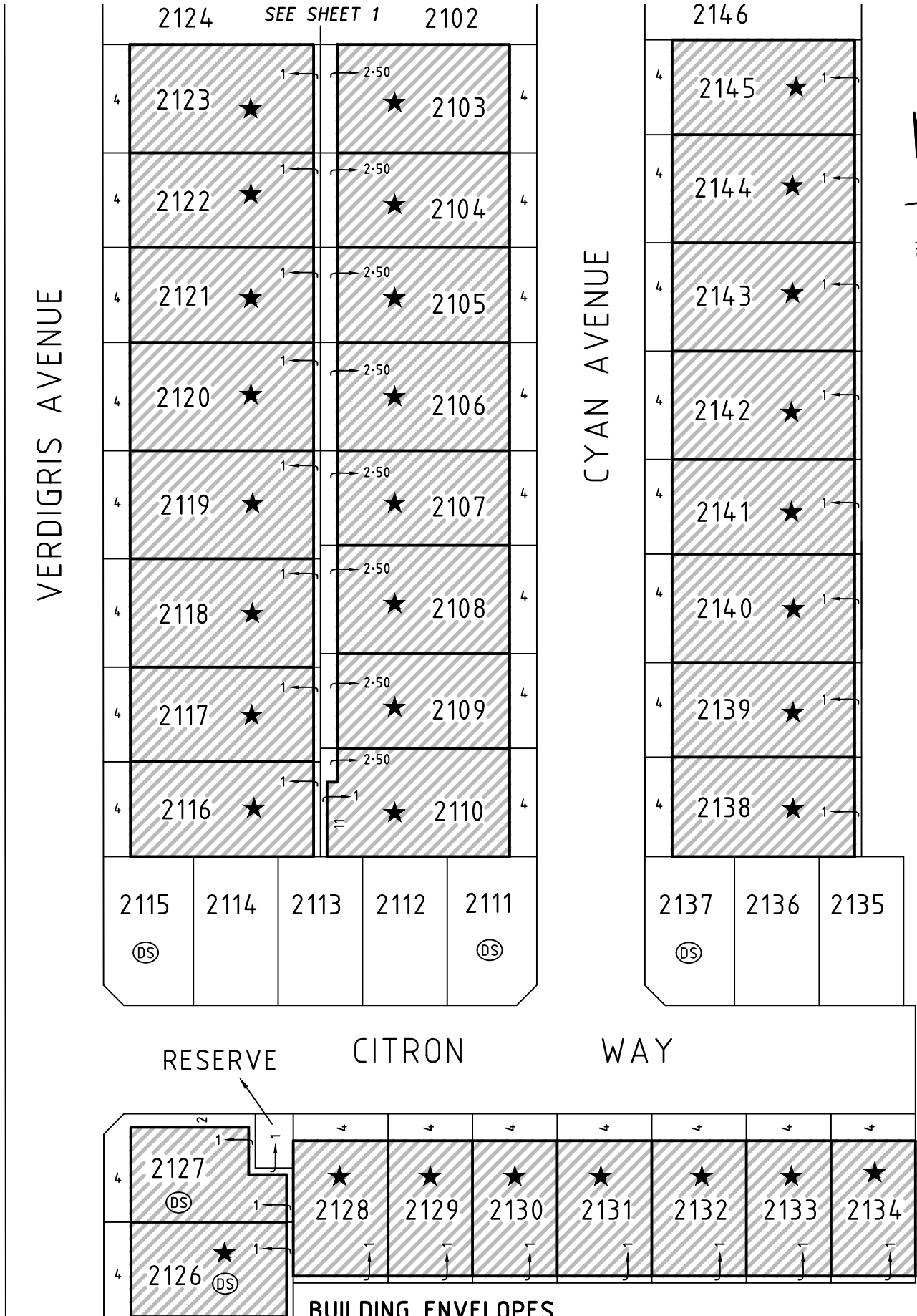

## BUILDING ENVELOPES

**SIDE SETBACKS**  
 FOR LOTS IDENTIFIED THUS: ★, A BUILD TO BOUNDARY ALLOWANCE ONLY APPLIES TO THE SIDE OF THE LOT WHERE THE CROSSOVER EXISTS. A SETBACK OF AT LEAST 1 METRE MUST BE PROVIDED FOR THE OPPOSITE SIDE BOUNDARY.

Ⓢ DENOTES DWELLINGS ON THOSE LOTS MUST BE DOUBLE STOREY IN ACCORDANCE WITH THE RIVERFIELD SQUARE DESIGN ASSESSMENT PANEL.

