

- NOTES:**
- These plans are preliminary only and have not been approved by Council. They are subject to change without notice and have been provided as a guide only.
  - This plan must be read in conjunction with the Plan of Subdivision. If any discrepancies are identified between the two plans, the Plan of Subdivision takes precedence.
  - Proposed services and connection points shown are preliminary only and subject to authority advice and approval. Vehicle crossing locations shown are subject to Council approval.
  - Existing surface levels refer to the existing surface surveyed by Beveridge Williams & Co Pty Ltd in August 2022.
  - Finished surface levels shown are preliminary only and may be subject to change during design and/or construction.
  - The depth of fill can be determined by calculating the depth between the existing and proposed finished surface levels.
  - Fill depths do not take into account any removal of topsoil, grubbing, or excavation associated with the construction of any temporary or permanent infrastructure within the subdivision.
  - The plan shows the indicative extent of fill greater than 200mm in depth. These extents may be subject to change during design and/or construction. Fill less than 200mm in depth is not shown on this plan.
  - The fill depth shown on this plan is for fill placed during construction of the subdivision whilst the site is under the control of Beveridge Williams & Co Pty Ltd. Beveridge Williams & Co Pty Ltd has no further knowledge or records of any other filling works throughout this subdivision, including prior to the survey being undertaken, or after the completion of construction.
  - Beveridge Williams & Co Pty Ltd will not be liable for any loss or damages incurred or suffered by any party due to the use of the plan or relying on the information contained within the plan.



**WARNING**  
**BEWARE OF UNDERGROUND SERVICES**  
 The locations of underground services are approximate only and their exact position should be proven on site.  
 No guarantee is given that all existing services are shown.  
 Locate all underground services before commencement of works  
**DIAL 1100 BEFORE YOU DIG**  
 www.1100.com.au

**PRELIMINARY PRINT**  
**NOT FOR CONSTRUCTION**

REV	DESCRIPTION	DATE	DRN.	APP.	REV	DESCRIPTION	DATE	DRN.	APP.
P10	UPDATED SEWER ALIGNMENT	09.02.24	N.B.	N.B.	P9	RETAINING WALL UPDATES	20.11.23	A.P.	S.Y.
P4	UPDATED CERULEAN PROMENADE	30.08.22	N.B.	S.Y.	P8	LOTS 2241 & 2242 REMOVED	14.03.23	A.P.	N.B.
P3	UPDATED STAGE NUMBER	30.06.22	N.B.	S.Y.	P7	UPDATED LAYOUT	12.01.23	N.B.	S.Y.
P2	3D IMAGERY ADDED	20.06.22	S.Y.	S.Y.	P6	UPDATED DRIVEWAYS	03.10.22	N.B.	S.Y.
P1	UPDATED LOT LAYOUT	10.06.22	N.B.	S.Y.	P5	UPDATED ELECTRICAL KIOSK LOCATIONS	13.09.22	N.B.	S.Y.
P0	ISSUED FOR INFORMATION	19.04.22	B.R.	N.B.					



Designed By: N.BALL  
 Date: 19.04.2022  
 Drawn By: B.RAU  
 Approved By: S.YOUNG  
 Date: 19.04.2022  
 PS Number: PS908306N



Project Details: RIVERFIELD SQUARE STAGE 22 CITY OF CASEY  
 Drawing Title: MARKETING PLAN (SHEET 1 OF 2)

Sheet 01 of 02  
 Scale: 1:500 @ A1  
 Project Ref: 2101578  
 Stage No: 22  
 Drawing No: M01  
 Rev: P10

K:\Jobs Data\2101578 - D\Renzo - 1675 Ballarto Road, Clyde\Eng\Stage 22\Drawings\2101578-22-M.dwg

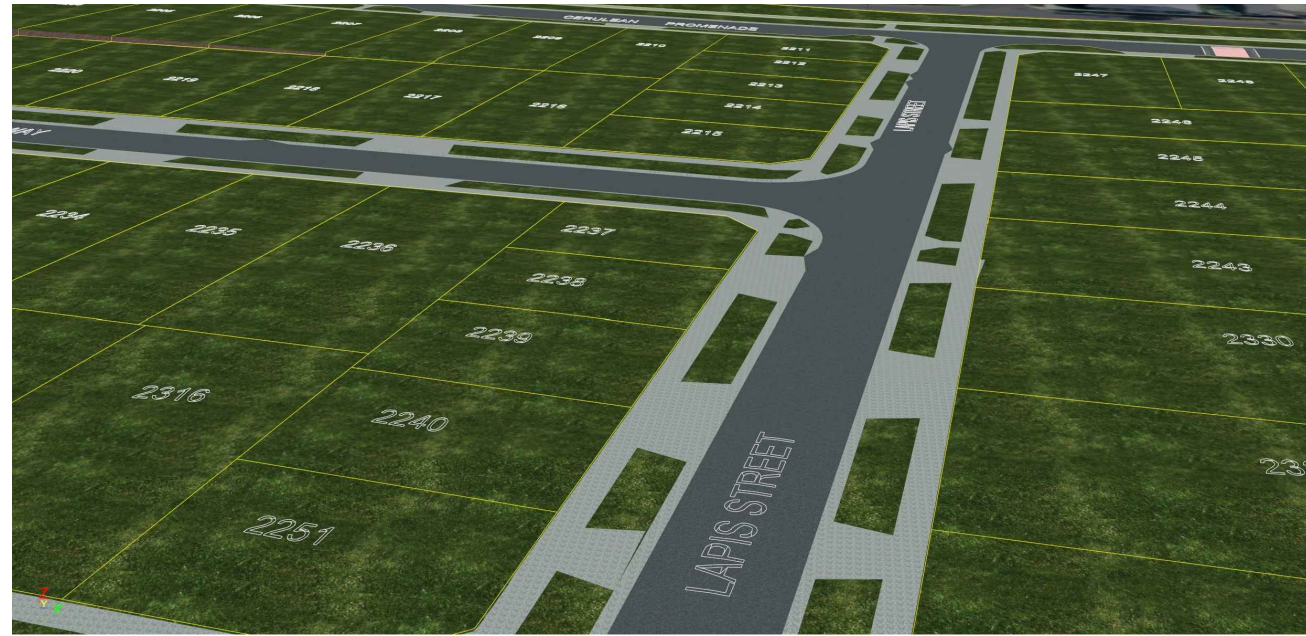

DIGITAL RENDER - LOCATION 1  
LAPIS STREET LOOKING NORTH

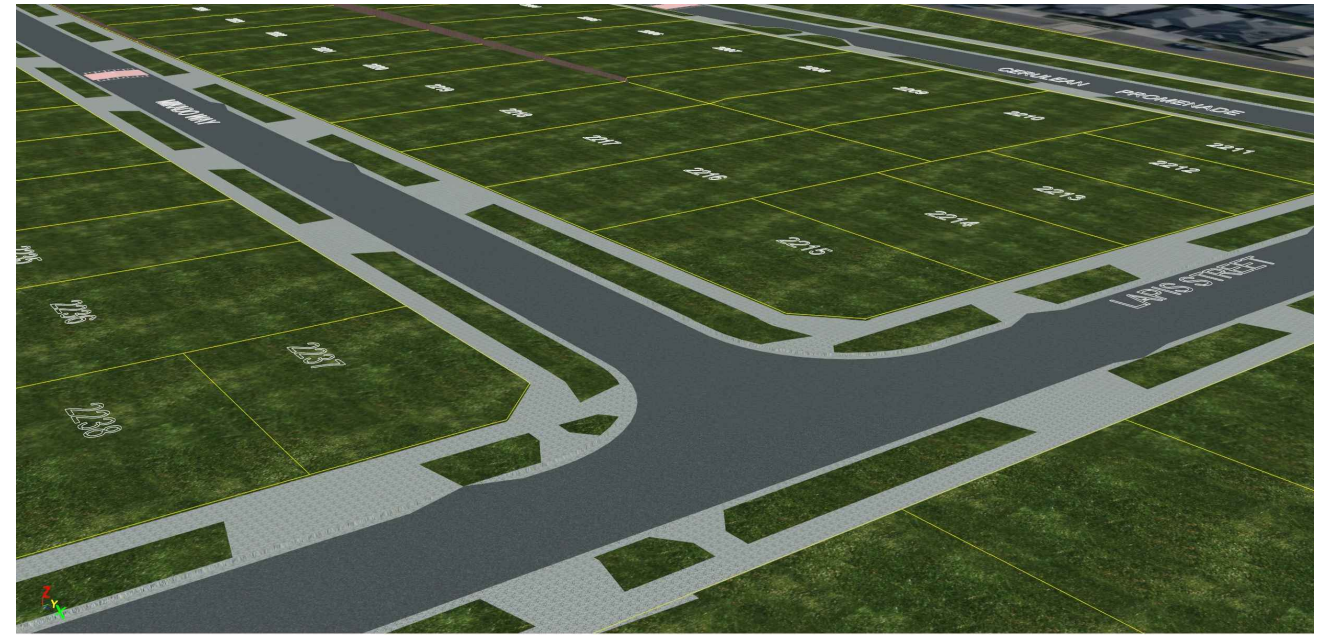

DIGITAL RENDER - LOCATION 2  
CORNER OF LAPIS STREET AND MIKADO WAY, LOOKING NORTH WEST

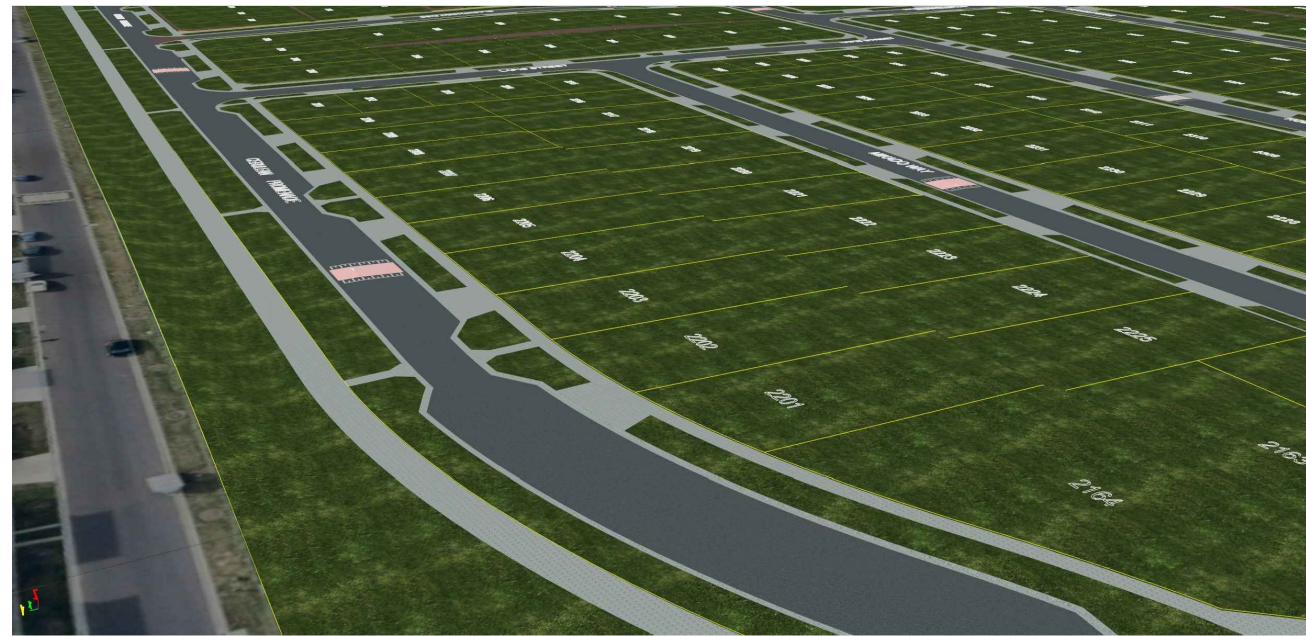

DIGITAL RENDER - LOCATION 3  
CERULEAN PROMENADE LOOKING SOUTH EAST

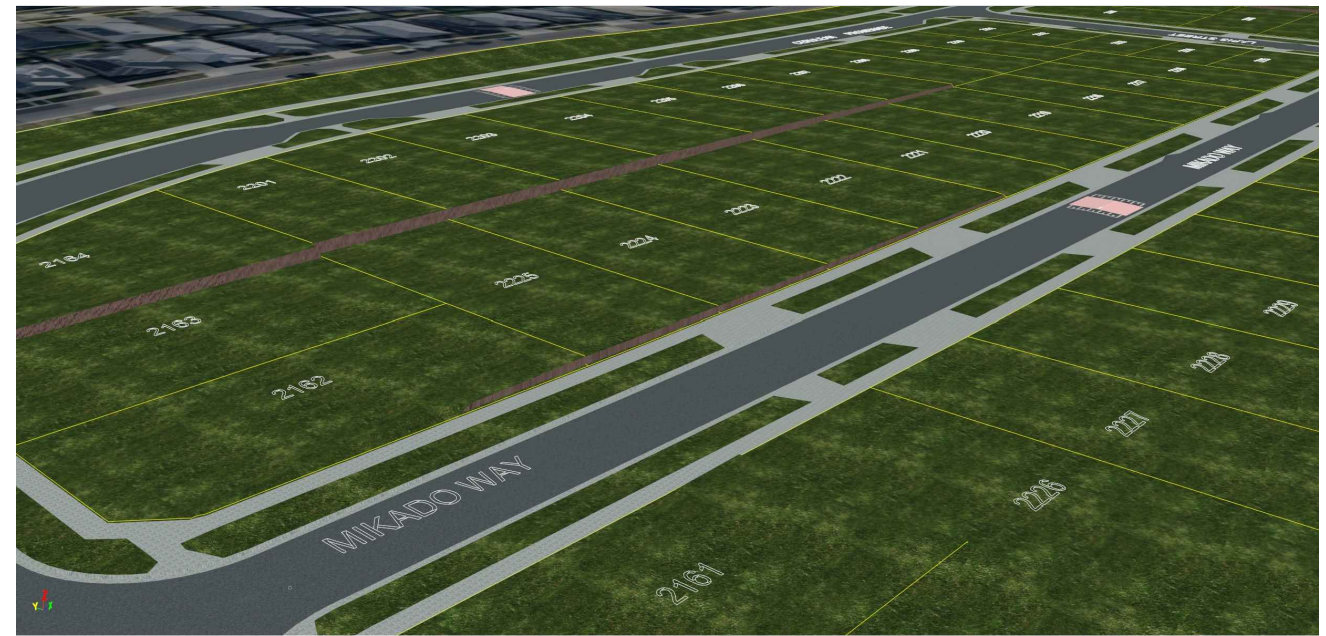

DIGITAL RENDER - LOCATION 4  
CORNER MIKADO WAY LOOKING NORTH EAST

PRELIMINARY PRINT  
NOT FOR CONSTRUCTION

© COPYRIGHT All rights reserved  
Beveridge Williams & Co. Pty Ltd has granted a licence to the principle to use this document for its intended purpose.  
No unauthorised copying is permitted.

REV	DESCRIPTION	DATE	DRN.	APP.	REV	DESCRIPTION	DATE	DRN.	APP.
P10	UPDATED SEWER ALIGNMENT	09.02.24	N.B.	N.B.					
P9	RETAINING WALL UPDATES	20.11.23	A.P.	S.Y.					
P8	LOTS 2241 & 2242 REMOVED	14.03.23	A.P.	N.B.					
P7	UPDATED LAYOUT	12.01.23	N.B.	S.Y.					
P6	UPDATED DRIVEWAYS	03.10.22	N.B.	S.Y.					
P5	UPDATED ELECTRICAL KIOSK LOCATIONS	13.09.22	N.B.	S.Y.					
P4	UPDATED CERULEAN PROMENADE	30.08.22	N.B.	S.Y.					
P3	UPDATED STAGE NUMBER	30.06.22	N.B.	S.Y.					
P2	3D IMAGERY ADDED	20.06.22	S.Y.	S.Y.					
P1	UPDATED LOT LAYOUT	10.06.22	N.B.	S.Y.					
P0	ISSUED FOR INFORMATION	19.04.22	B.R.	N.B.					



Designed  
Date  
19.04.2022  
N. BALL  
19.04.2022  
Drawn  
B.RAU  
Approved  
Date  
13.04.2022  
N.BALL  
13.04.2022  
PS Number  
PS908306N



Project  
Details  
RIVERFIELD SQUARE  
STAGE 22  
CITY OF CASEY  
Drawing  
Title  
MARKETING PLAN  
(SHEET 2 OF 2)

Sheet 02 of 02



Project Ref  
2101578  
Stage No  
22  
Drawing No  
M02  
Rev  
P10