

**AS-CONSTRUCTED PLANS**

THESE AS-CONSTRUCTED PLANS ARE INTENDED TO UPDATE THE DESIGN DRAWINGS TO SHOW SIGNIFICANT CHANGES WHICH OCCURRED DURING CONSTRUCTION. THE LEVELS SHOWN ON THESE PLANS ARE DESIGN LEVELS ONLY AND HAVE NOT BEEN VERIFIED BY SURVEY. ALL INFORMATION SHOWN ON THESE PLANS SHOULD BE VERIFIED ON SITE. CHARLTON DEGG ACCEPT NO RESPONSIBILITY FOR LOSS OR DAMAGES FROM THE INAPPROPRIATE USAGE OF THESE PLANS.

**WARNING**

**BEWARE OF UNDERGROUND SERVICES**

THE LOCATIONS OF UNDERGROUND SERVICES ARE APPROXIMATE ONLY AND THEIR EXACT POSITION SHOULD BE PROVEN ON SITE. NO GUARANTEE IS GIVEN THAT ALL EXISTING SERVICES ARE SHOWN.



Major Cables exist in the area, if your activities are within Telstra encroachment distances (see duty of care) contact 03 9632 9961 at least 2 business days before starting activity.

**LEGEND**

- FOOTPATH
- VEHICULAR CROSSOVER
- KERB AND CHANNEL
- ELECTRICITY TELECOMMUNICATION CONDUITS
- GAS DRINKING WATER NON DRINKING WATER CONDUITS
- ELECTRICITY MAIN
- TELECOMMUNICATION MAIN
- GAS MAIN
- DRINKING WATER MAIN
- NON DRINKING WATER MAIN
- SEWER MAIN, MANHOLE AND MAINTENANCE SHAFT
- PROPOSED DRAINAGE, PIT, HOUSE DRAIN AND PROPERTY INLET
- EXISTING DRAINAGE AND PIT AND FUTURE DRAINAGE AND PIT
- MELBOURNE WATER SCHEME DRAINAGE AND PIT (COUNCIL ASSET)
- MELBOURNE WATER SCHEME DRAINAGE AND PIT (MELBOURNE WATER ASSET)
- DRAINAGE PIT NUMBER
- PROPOSED CUT AREAS
- PROPOSED FILL AREAS
- EXISTING SURFACE LEVEL
- DESIGN SURFACE LEVEL
- TOP OF BATTER LEVEL
- PRE-DEVELOPMENT LEVEL
- STREET NAME SIGN
- LOT SLOPE DIRECTION
- PERMANENT SURVEY MARK
- TEMPORARY BENCH MARK
- RETAINING WALLS (CONCRETE SLEEPER)
- RETAINING WALLS (MASS ROCK WALL)
- KERB TRANSITION
- TRAFFIC SIGNAL PEDESTAL

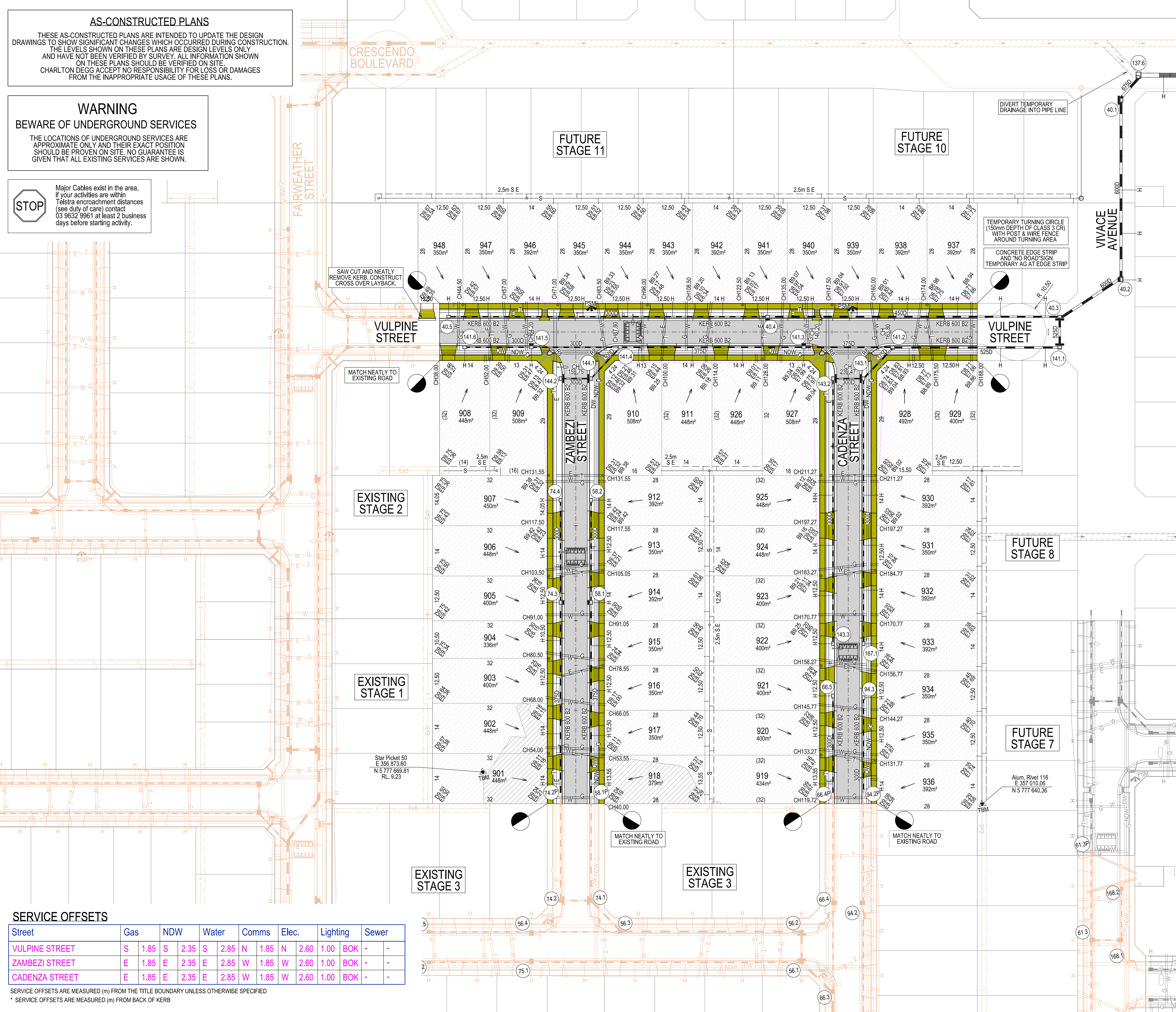
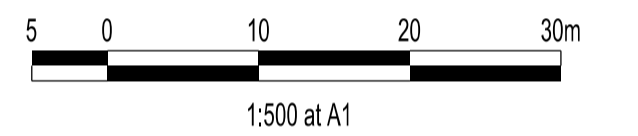

**VERSION DETAILS:**

REV	DATE	DESCRIPTION	STATUS
A	15/09/2021	PRELIMINARY PLAN	PRELIMINARY
B	8/04/2022	COUNCIL SUBMISSION	PRELIMINARY
C	10/05/2022	DRAINAGE ADDED DUE TO STAGE PRIORITIES	PRELIMINARY
D	03/06/2022	COUNCIL COMMENTS DATED 24/05/2022	PRELIMINARY
E	10/06/2022	CURVED SECTION REMOVED FROM DRAINAGE LINE 40	PRELIMINARY
F	26/08/2022	COUNCIL COMMENTS DATED 29/09/2022	PRELIMINARY
G	04/11/2022	AS CONSTRUCTED	AS-CON

FILENAME: P:\1209\1209\_9\IE2 - Design\6 - DGN\R04.dgn

DRAWN: C.BAXTER DATE: APR 2022 SCALE: AS SHOWN

DESIGNED: R.COLMAN DATE: APR 2022 DATE PRINTED: 4/11/2022

AUTHORISED: A.CHARLTON DATE: APR 2022



SUITE 1, LEVEL 1, 84 MT ELIZA WAY, MT ELIZA VIC 3930  
www.charltondegg.com.au

COUNCIL: CITY OF CASEY

TITLE: BROWN PROPERTY GROUP RIVERFIELD - STAGE 9 BALLARTO ROAD - CLYDE

**DETAIL PLAN 1 & SERVICE OFFSET TABLE**

Street	Gas	NDW	Water	Comms	Elec.	Lighting	Sewer
VULPINE STREET	S 1.85	S 2.35	S 2.85	N 1.85	N 2.60	1.00	BOK -
ZAMBEZI STREET	E 1.85	E 2.35	E 2.85	W 1.85	W 2.60	1.00	BOK -
CADANZA STREET	E 1.85	E 2.35	E 2.85	W 1.85	W 2.60	1.00	BOK -

SERVICE OFFSETS ARE MEASURED (m) FROM THE TITLE BOUNDARY UNLESS OTHERWISE SPECIFIED  
\* SERVICE OFFSETS ARE MEASURED (m) FROM BACK OF KERB

**WARNING**  
BEWARE OF UNDERGROUND SERVICES

THE LOCATIONS OF UNDERGROUND SERVICES ARE APPROXIMATE ONLY AND THEIR EXACT POSITION SHOULD BE PROVEN ON SITE. NO GUARANTEE IS GIVEN THAT ALL EXISTING SERVICES ARE SHOWN.

**STOP**

Major Cables exist in the area, if your activities are within Telstra encroachment distances (see duty of care) contact 03 9632 9961 at least 2 business days before starting activity.

**LEGEND**

- FOOTPATH
- VEHICULAR CROSSOVER
- KERB AND CHANNEL
- ELECTRICITY TELECOMMUNICATION CONDUITS
- GAS DRINKING WATER NON DRINKING WATER CONDUITS
- ELECTRICITY MAIN
- TELECOMMUNICATION MAIN
- GAS MAIN
- DRINKING WATER MAIN
- NON DRINKING WATER MAIN
- SEWER MAIN, MANHOLE AND MAINTENANCE SHAFT
- PROPOSED DRAINAGE, PIT, HOUSE DRAIN AND PROPERTY INLET
- EXISTING DRAINAGE AND PIT AND FUTURE DRAINAGE AND PIT
- MELBOURNE WATER SCHEME DRAINAGE AND PIT (COUNCIL ASSET)
- MELBOURNE WATER SCHEME DRAINAGE AND PIT (MELBOURNE WATER ASSET)
- DRAINAGE PIT NUMBER
- PROPOSED CUT AREAS
- PROPOSED FILL AREAS
- EXISTING SURFACE LEVEL
- DESIGN SURFACE LEVEL
- TOP OF BATTER LEVEL
- PRE-DEVELOPMENT LEVEL
- STREET NAME SIGN
- LOT SLOPE DIRECTION
- PERMANENT SURVEY MARK
- TEMPORARY BENCH MARK
- RETAINING WALLS (CONCRETE SLEEPER)
- RETAINING WALLS (MASS ROCK WALL)
- KERB TRANSITION
- TRAFFIC SIGNAL PEDESTAL

Scale: 1:500 at A1

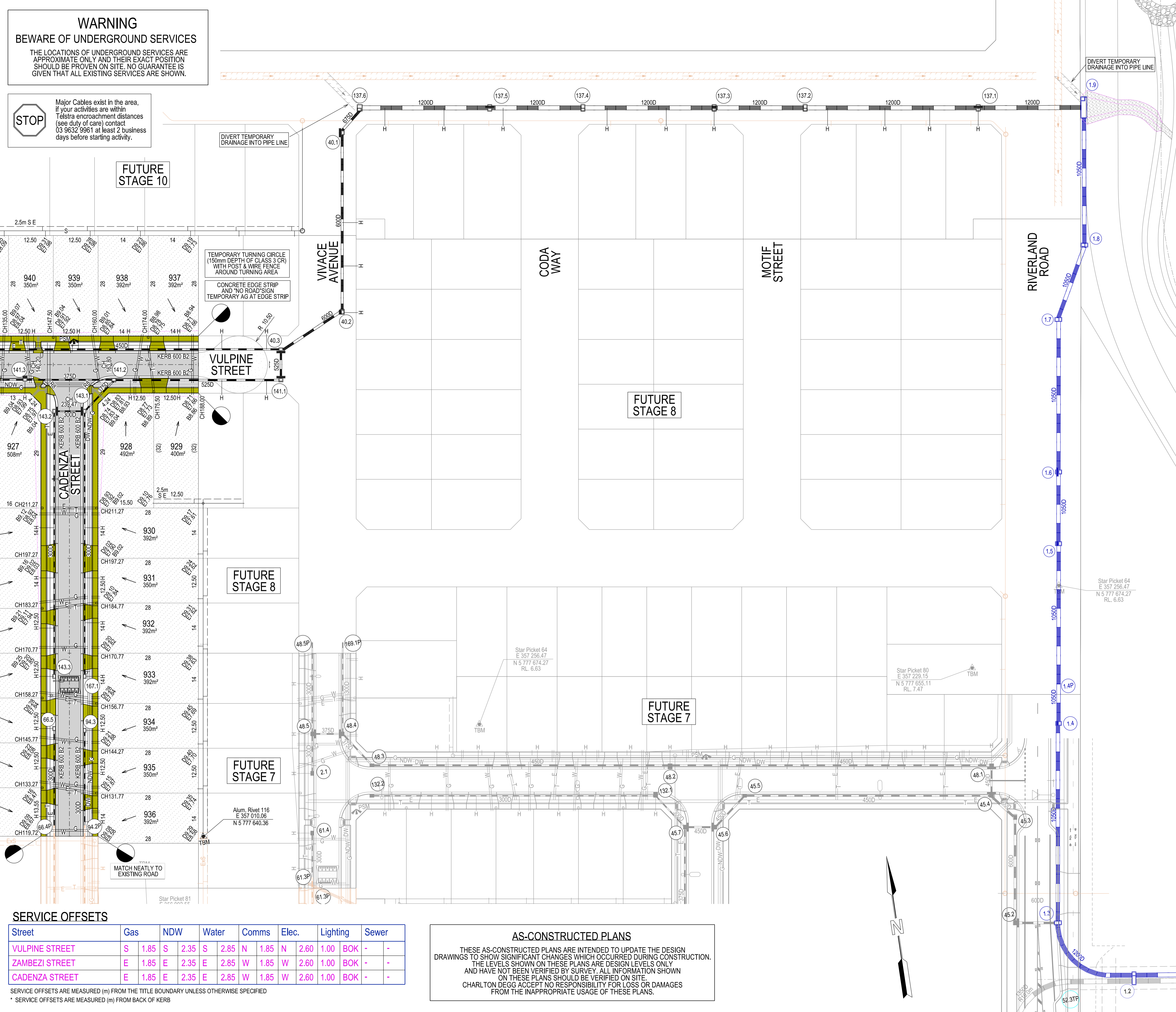

**SERVICE OFFSETS**

Street	Gas	NDW	Water	Comms	Elec.	Lighting	Sewer
VULPINE STREET	S 1.85	S 2.35	S 2.85	N 1.85	N 2.60	1.00	BOK - -
ZAMBEZI STREET	E 1.85	E 2.35	E 2.85	W 1.85	W 2.60	1.00	BOK - -
CADENZA STREET	E 1.85	E 2.35	E 2.85	W 1.85	W 2.60	1.00	BOK - -

SERVICE OFFSETS ARE MEASURED (m) FROM THE TITLE BOUNDARY UNLESS OTHERWISE SPECIFIED  
\* SERVICE OFFSETS ARE MEASURED (m) FROM BACK OF KERB

**AS-CONSTRUCTED PLANS**

THESE AS-CONSTRUCTED PLANS ARE INTENDED TO UPDATE THE DESIGN DRAWINGS TO SHOW SIGNIFICANT CHANGES WHICH OCCURRED DURING CONSTRUCTION. THE LEVELS SHOWN ON THESE PLANS ARE DESIGN LEVELS ONLY AND HAVE NOT BEEN VERIFIED BY SURVEY. ALL INFORMATION SHOWN ON THESE PLANS SHOULD BE VERIFIED ON SITE. CHARLTON DEGG ACCEPT NO RESPONSIBILITY FOR LOSS OR DAMAGES FROM THE INAPPROPRIATE USAGE OF THESE PLANS.

**VERSION DETAILS:**

REV	DATE	DESCRIPTION	STATUS
A	15/09/2021	PRELIMINARY PLAN	PRELIMINARY
B	8/04/2022	COUNCIL SUBMISSION	PRELIMINARY
C	10/05/2022	DRAINAGE ADDED DUE TO STAGE PRIORITIES	PRELIMINARY
D	03/06/2022	COUNCIL COMMENTS DATED 24/05/2022	PRELIMINARY
E	10/06/2022	CURVED SECTION REMOVED FROM DRAINAGE LINE 40	PRELIMINARY
F	26/08/2022	COUNCIL COMMENTS DATED 29/09/2022	PRELIMINARY
G	04/11/2022	AS CONSTRUCTED	AS-CON

FILENAME: P:\1209\1209\_9\IE2 - Design\6 - DGN\R04a.dgn

DRAWN: C.BAXTER DATE: APR 2022 SCALE: AS SHOWN

DESIGNED: R.COLMAN DATE: APR 2022 DATE PRINTED: 4/11/2022

AUTHORISED: A.CHARLTON DATE: APR 2022

SUITE 1, LEVEL 1, 84 MT ELIZA WAY, MT ELIZA VIC 3930  
www.charltondegg.com.au

COUNCIL: CITY OF CASEY

TITLE: BROWN PROPERTY GROUP RIVERFIELD - STAGE 9 BALLARTO ROAD - CLYDE

DETAIL PLAN 2 & SERVICE OFFSET TABLE

DRG NO. 1209\_9/R04a REV. G SHEET 4a OF 20