

SERVICE OFFSETS

Street	Gas	NDW	Water	Comms	Elec.	Lighting	Sewer
FAIRWEATHER STREET	E 1.85	E 2.35	E 2.85	W 1.85	W 2.60	1.00	BOK -
MONTADALE BLVD (L 201-202)	E 1.85	E 2.40	E 2.95	W 2.50	W 3.00	1.00	BOK -
MONTADALE BLVD (L 202-204)	S 1.50	S 2.05	S 2.60	N 0.40	N 0.95	1.00	BOK -
MONTADALE BLVD (L 204-212)	S 1.85	S 2.35	S 2.85	N 1.85	N 2.60	1.00	BOK -
KOPICO STREET	W 1.85	W 2.35	W 2.85	E 1.85	E 2.60	1.00	BOK -
VULPINE STREET	S 1.85	S 2.35	S 2.85	N 1.85	N 2.60	1.00	BOK 1.00 N
RIVERDREAM STREET	E 1.50	E 2.05	E 2.60	W 0.50	W 1.25	1.00	BOK -

SERVICE OFFSETS ARE MEASURED (m) FROM THE TITLE BOUNDARY UNLESS OTHERWISE SPECIFIED
 * SERVICE OFFSETS ARE MEASURED (m) FROM BACK OF KERB
 EXISTING SERVICES DENOTED WITH (E). EXISTING SERVICE OFFSETS ARE AN APPROXIMATE TO BE VERIFIED BY THE CONTRACTOR.

AS-CONSTRUCTED PLANS
 THESE AS-CONSTRUCTED PLANS ARE INTENDED TO UPDATE THE DESIGN DRAWINGS TO SHOW SIGNIFICANT CHANGES WHICH OCCURRED DURING CONSTRUCTION. THE LEVELS SHOWN ON THESE PLANS ARE DESIGN LEVELS ONLY AND HAVE NOT BEEN VERIFIED BY SURVEY. ALL INFORMATION SHOWN ON THESE PLANS SHOULD BE VERIFIED ON SITE. CHARLTON DEGG ACCEPTS NO RESPONSIBILITY FOR LOSS OR DAMAGES FROM THE INAPPROPRIATE USAGE OF THESE PLANS.

LEGEND

- FOOTPATH
- VEHICULAR CROSSOVER
- KERB AND CHANNEL
- ELECTRICITY TELECOMMUNICATION) CONDUITS
- GAS DRINKING WATER NON DRINKING WATER) CONDUITS
- ELECTRICITY MAIN
- TELECOMMUNICATION MAIN
- GAS MAIN
- DRINKING WATER MAIN
- NON DRINKING WATER MAIN
- SEWER MAIN, MANHOLE AND MAINTENANCE SHAFT AND SEWER PROPERTY BRANCHES - BY FHDB
- PROPOSED DRAINAGE, PIT, HOUSE DRAIN AND PROPERTY INLET
- EXISTING DRAINAGE AND PIT AND FUTURE DRAINAGE AND PIT
- MELBOURNE WATER SCHEME DRAINAGE AND PIT (COUNCIL ASSET)
- PROPOSED COUNCIL MAIN DRAINAGE PIPES AND PITS
- DRAINAGE PIT NUMBER
- PROPOSED CUT AREAS
- PROPOSED FILL AREAS
- EXISTING SURFACE LEVEL
- DESIGN SURFACE LEVEL
- TOP OF BATTER LEVEL
- RETAINING WALL LEVEL
- STREET NAME SIGN
- LOT SLOPE DIRECTION
- PERMANENT SURVEY MARK
- TEMPORARY BENCH MARK
- RETAINING WALLS

WARNING
BEWARE OF UNDERGROUND SERVICES
 THE LOCATIONS OF UNDERGROUND SERVICES ARE APPROXIMATE ONLY AND THEIR EXACT POSITION SHOULD BE PROVEN ON SITE. NO GUARANTEE IS GIVEN THAT ALL EXISTING SERVICES ARE SHOWN.

Major Cables exist in the area, if your activities are within Telstra encroachment distances (see duty of care) contact 03 9632 9961 at least 2 business days before starting activity.

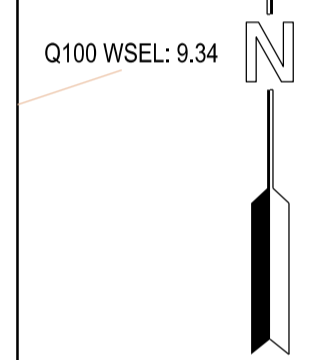
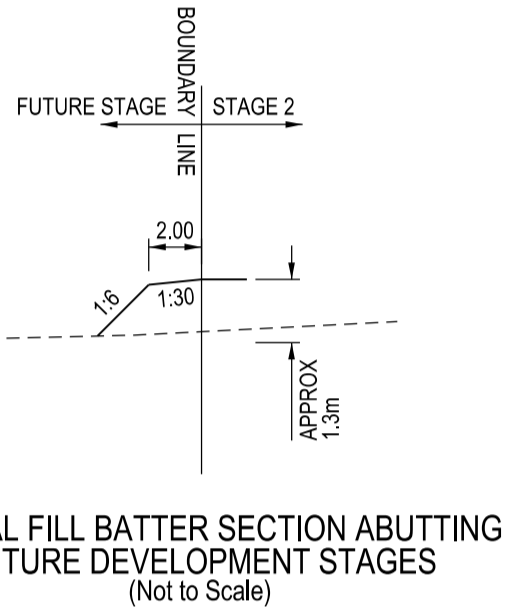
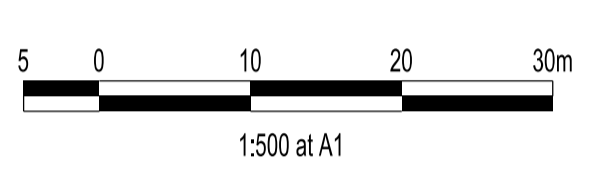

Q100 WSEL: 9.34
 Q100 WSEL: 9.21
 Q100 WSEL: 9.08
 Q100 WSEL: 8.95

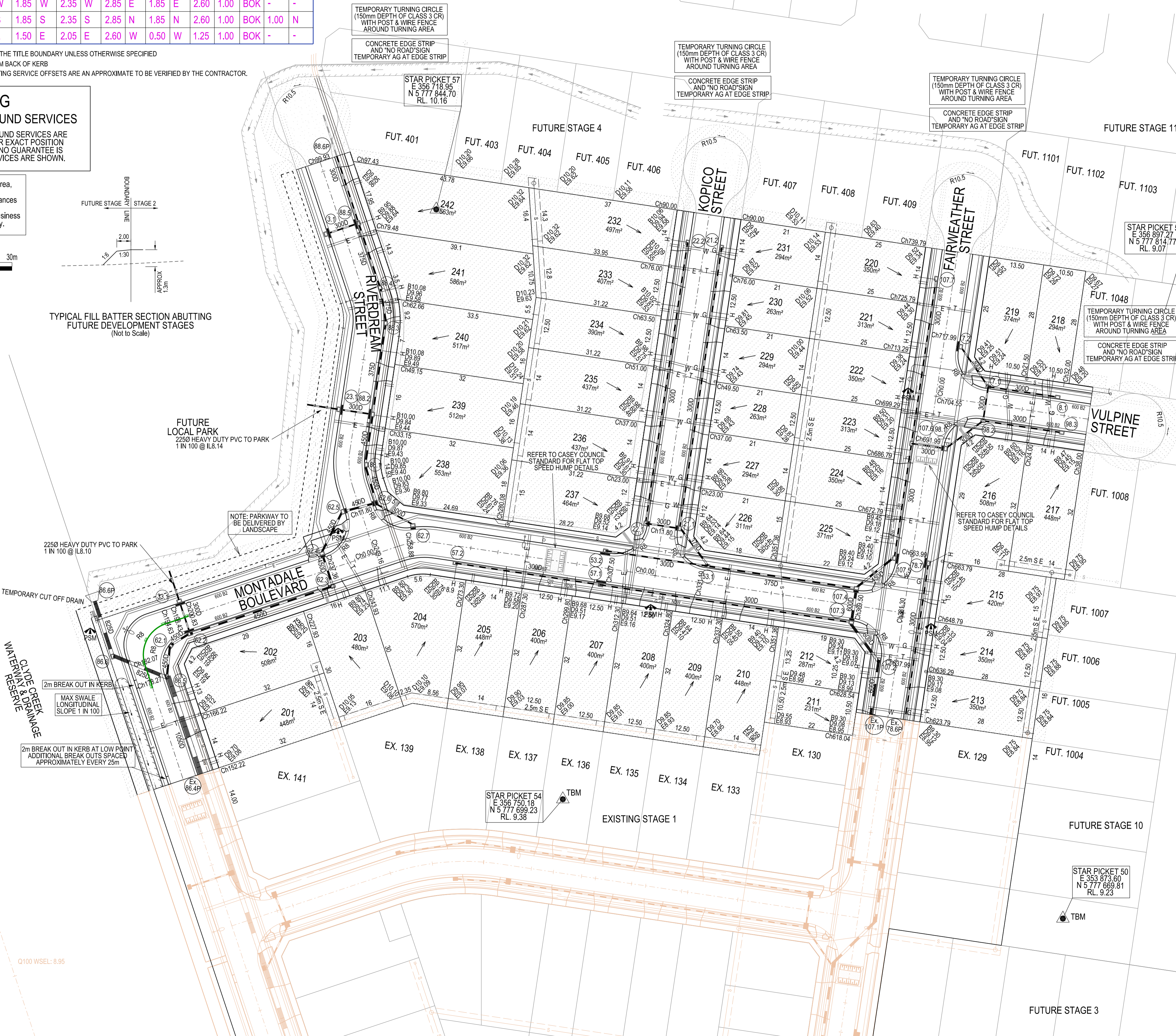

VERSION DETAILS:

REV	DATE	DESCRIPTION	STATUS
A	30/04/2021	COUNCIL ISSUE	PRELIMINARY
B	20/05/2021	DRAINAGE AND GRADING REVISIONS	PRELIMINARY
C	01/07/2021	COUNCIL REVISIONS	PRELIMINARY
D	06/09/2021	COUNCIL COMMENTS (31/08/2021)	PRELIMINARY
E	14/09/2021	COUNCIL COMMENTS (14/08/2021)	PRELIMINARY
F	01/10/2021	STORM WATER DRAINS ADDED TO PARK (23.1, 33.1)	PRELIMINARY
G	19/04/2022	AS CONSTRUCTED PLANS	AS-CON

FILENAME: P:\1209\1209_2\E2 - Design\6 - DGN\R04.dgn

DRAWN: C.DAVIDSON	DATE: APRIL 2021	SCALE: AS SHOWN
DESIGNED: C.DAVIDSON	DATE: APRIL 2021	DATE PRINTED: 19/04/2022
AUTHORISED: A.CHARLTON	DATE: APRIL 2021	



SUITE 1, LEVEL 1, 84 MT ELIZA WAY, MT ELIZA VIC 3930
 www.charltondegg.com.au

COUNCIL: CITY OF CASEY
 TITLE: BROWN PROPERTY GROUP RIVERFIELD - STAGE 2 BALLARTO ROAD - CLYDE

DETAIL PLAN & SERVICE OFFSET TABLE

DRG NO. 1209_2/R 01	REV. G	SHEET 04 OF 23
---------------------	--------	----------------