

RIVERFIELD SQUARE - STAGE 21

BUILDING ENVELOPES

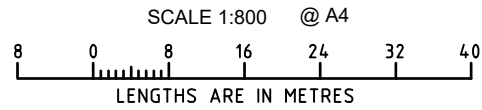

BUILDING ENVELOPES

SIDE SETBACKS
 FOR LOTS IDENTIFIED THUS: ★, A BUILD TO BOUNDARY ALLOWANCE ONLY APPLIES TO THE SIDE OF THE LOT WHERE THE CROSSOVER EXISTS. A SETBACK OF AT LEAST 1 METRE MUST BE PROVIDED FOR THE OPPOSITE SIDE BOUNDARY.

ⓁS DENOTES DWELLINGS ON THOSE LOTS MUST BE DOUBLE STOREY.

CERULEAN

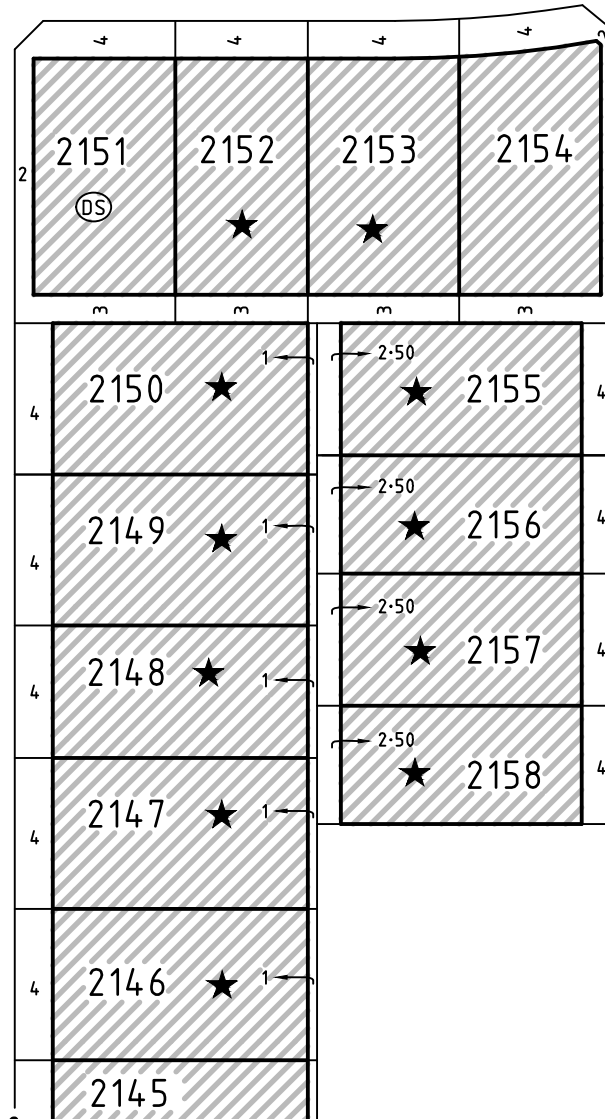

PROMENADE

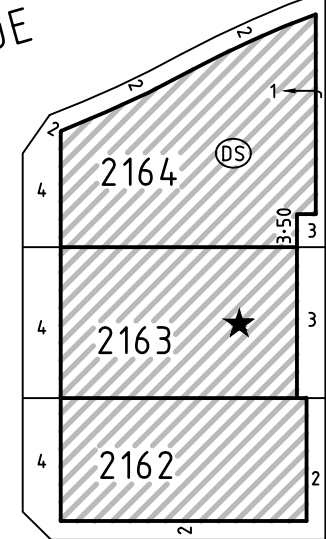

MIKADO WAY

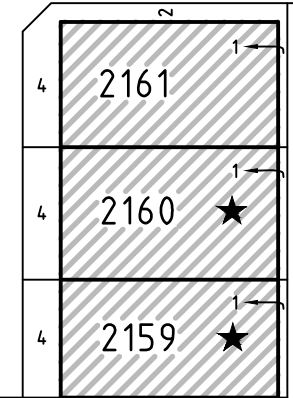

AVENUE

CYAN

BISTRE WAY

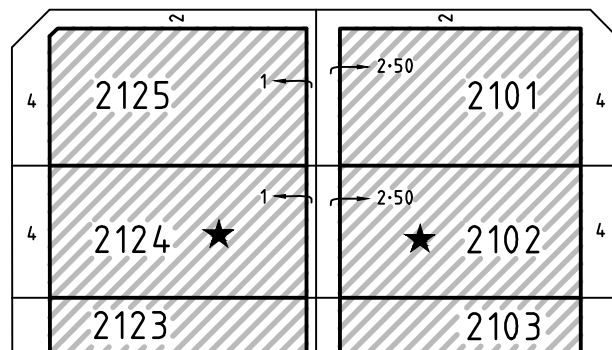

VERDIGRIS AVE

D

SEE SHEET 2

BW Beveridge Williams
 development & environment consultants
 Melbourne ph : 03 9524 8888
 www.beveridgewilliams.com.au

Ref: 2101578/21 Ver F
 2101578-21-BE-VerF.dwg

RIVERFIELD SQUARE - STAGE 21 BUILDING ENVELOPES

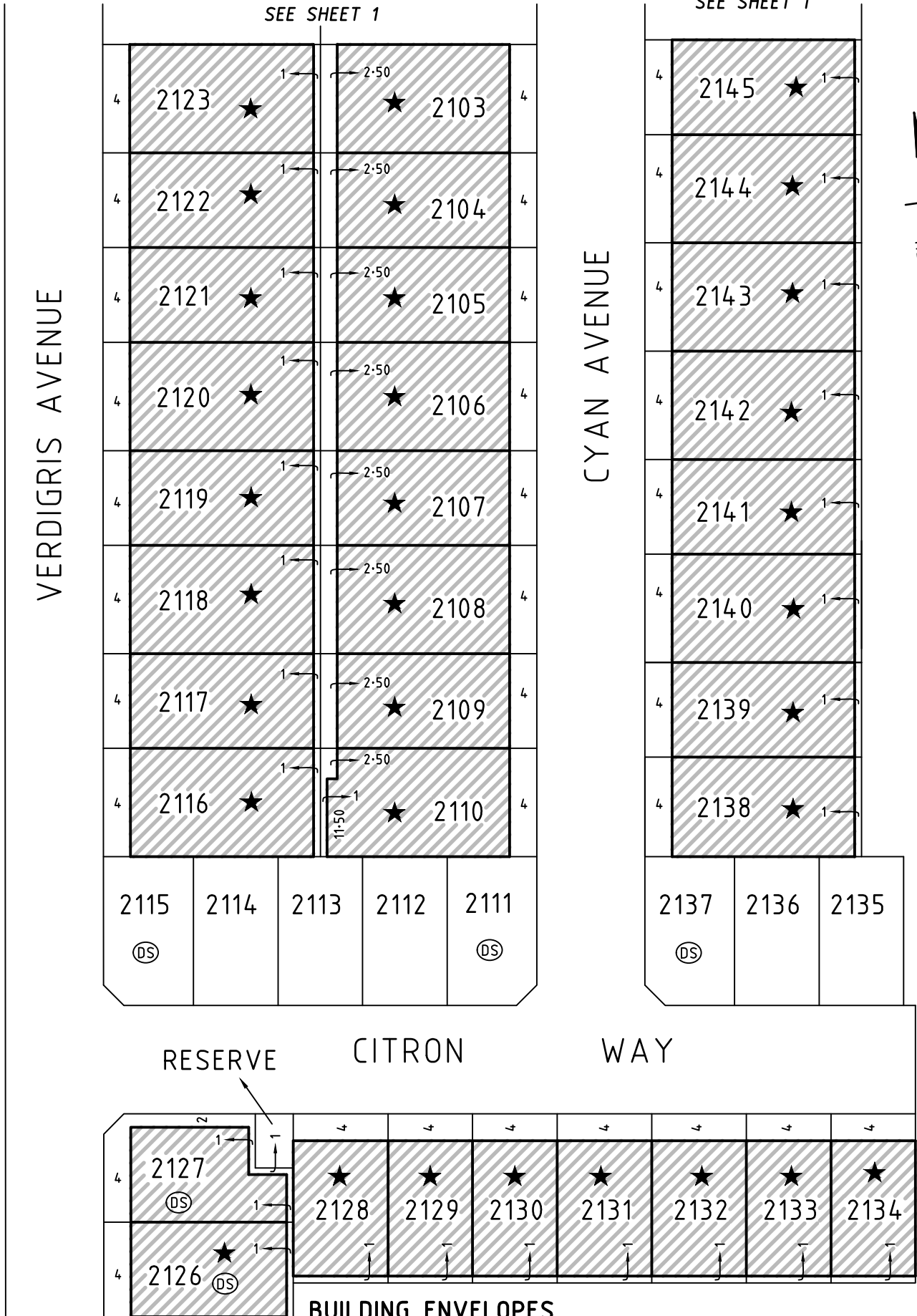

BUILDING ENVELOPES

SIDE SETBACKS

FOR LOTS IDENTIFIED THUS: ★, A BUILD TO BOUNDARY ALLOWANCE ONLY APPLIES TO THE SIDE OF THE LOT WHERE THE CROSSOVER EXISTS. A SETBACK OF AT LEAST 1 METRE MUST BE PROVIDED FOR THE OPPOSITE SIDE BOUNDARY.

Ⓢ DENOTES DWELLINGS ON THOSE LOTS MUST BE DOUBLE STOREY.

