

STOP

Major Cables exist in the area, if your activities are within Telstra encroachment distances (see duty of care) contact 03 9632 9961 at least 2 business days before starting activity.

WARNING

BEWARE OF UNDERGROUND SERVICES

THE LOCATIONS OF UNDERGROUND SERVICES ARE APPROXIMATE ONLY AND THEIR EXACT POSITION SHOULD BE PROVEN ON SITE. NO GUARANTEE IS GIVEN THAT ALL EXISTING SERVICES ARE SHOWN.

SERVICE OFFSETS

Street	Gas	NDW	Water	Comms	Elec.	Lighting*	Sewer
VULPINE STREET	S 1.85	S 2.35	S 2.85	N 1.85	N 2.60	1.00	BOK - -
VIVACE STREET	E 1.85	E 2.35	E 2.85	W 1.85	W 2.60	1.00	BOK - -
CODA WAY	E 1.85	E 2.35	E 2.85	W 1.85	W 2.60	1.00	BOK - -
MOTIF STREET	E 1.85	E 2.35	E 2.85	W 1.85	W 2.60	1.00	BOK 1.00 W
BALLAD STREET	S 1.85	S 2.35	S 2.85	N 1.85	N 2.60	1.00	BOK 1.00 S
RIVERLAND ROAD	W 1.95	W 2.45	W 2.95	E 4.55	E 3.80	1.00	BOK 1.00 W

SERVICE OFFSETS ARE MEASURED (m) FROM THE TITLE BOUNDARY UNLESS OTHERWISE SPECIFIED
 * SERVICE OFFSETS ARE MEASURED (m) FROM BACK OF KERB

LEGEND

- FOOTPATH
- VEHICULAR CROSSOVER
- KERB AND CHANNEL
- ELECTRICITY TELECOMMUNICATION } CONDUITS
- GAS DRINKING WATER NON DRINKING WATER } CONDUITS
- ELECTRICITY MAIN
- TELECOMMUNICATION MAIN
- GAS MAIN
- DRINKING WATER MAIN
- NON DRINKING WATER MAIN
- SEWER MAIN, MANHOLE AND MAINTENANCE SHAFT
- PROPOSED DRAINAGE, PIT, HOUSE DRAIN AND PROPERTY INLET
- EXISTING DRAINAGE AND PIT AND FUTURE DRAINAGE AND PIT
- MELBOURNE WATER SCHEME DRAINAGE AND PIT (COUNCIL ASSET)
- PROPOSED COUNCIL MAIN DRAINAGE PIPES AND PITS
- DRAINAGE PIT NUMBER
- PROPOSED CUT AREAS
- PROPOSED FILL AREAS
- EXISTING SURFACE LEVEL
- DESIGN SURFACE LEVEL
- TOP OF BATTER LEVEL
- PRE-DEVELOPMENT LEVEL
- STREET NAME SIGN
- LOT SLOPE DIRECTION
- PERMANENT SURVEY MARK
- TEMPORARY BENCH MARK
- RETAINING WALLS (CONCRETE SLEEPER)
- RETAINING WALLS (MASS ROCK WALL)
- KERB TRANSITION

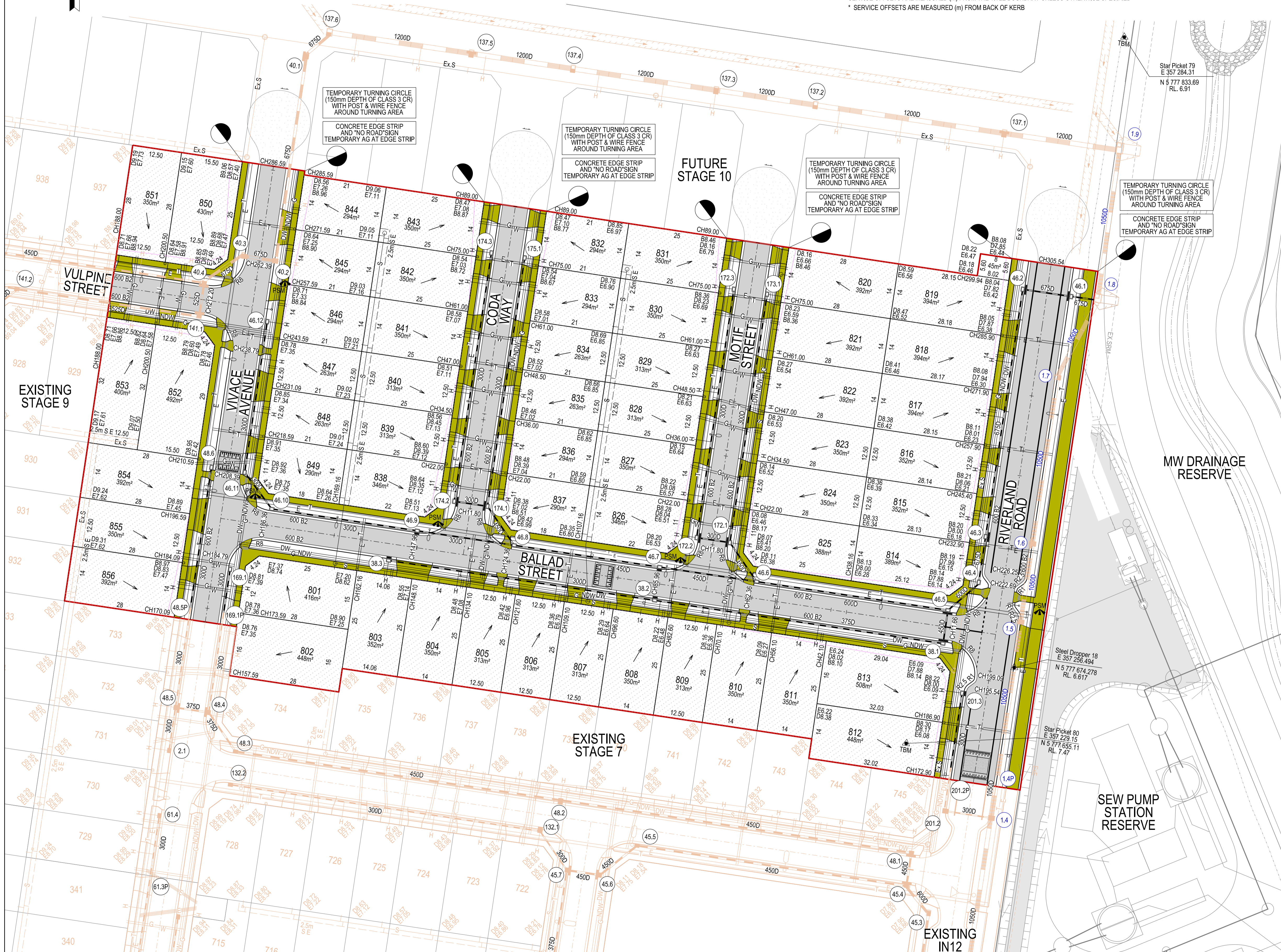

VERSION DETAILS:

REV	DATE	DESCRIPTION	STATUS
A	30/08/2021	PRELIMINARY PLAN	PRELIMINARY
B	25/02/2022	PRELIMINARY COUNCIL SUBMISSION	PRELIMINARY
C	16/05/2022	DRAINAGE & SEWER ALIGNMENT AMENDMENTS DUE TO STAGE SEQUENCING CHANGES.	PRELIMINARY

FILENAME:	P:\1209\1209_8\IE2 - Design\6 - DGN\R04.dgn		
DRAWN:	L.STREET	DATE:	FEB 2022
DESIGNED:	R.COLMAN	DATE:	FEB 2022
AUTHORISED:	A.CHARTLTON	DATE:	FEB 2022

CHARLTON DEGG
 LAND DEVELOPMENT CONSULTANTS

SUITE 1, LEVEL 1, 84 MT ELIZA WAY, MT ELIZA VIC 3930
 www.charltondegg.com.au

COUNCIL:	CITY OF CASEY		
TITLE:	BROWN PROPERTY GROUP RIVERFIELD - STAGE 8 BALLARTO ROAD - CLYDE		
DETAIL PLAN			
DRG NO.	1209_8/R04	REV.	C
			SHEET 4 OF 27