

SERVICE OFFSETS

Street	Gas	NDW	Water	Comms	Elec.	Lighting	Sewer
RUBATO STREET	E 2.00	E 2.50	E 3.00	W 1.85	W 2.45	0.80 BOK	1.00 W
NOCTURNE AVENUE	E 2.00	E 2.50	E 3.00	W 1.85	W 2.60	0.80 BOK	-
TENOR WAY	E/S 2.00	E/S 2.50	E/S 3.00	W/N 1.85	W/N 2.60	0.80 BOK	-
BARITONE COURT	E 1.00	E 1.55	E 2.10	W 1.80	W 2.60	0.80 BOK	1.00 W
FIETS CLOSE	N 1.25	N 1.75	N 2.25	N 0.40	S 3.75	0.80 S	-
ANDANTE CRES (501-538)	E 2.00	E 2.55	E 3.10	W 0.35	W 1.10	0.80 BOK	1.00 E
ANDANTE CRES (522-537)	S 2.00	S 2.50	S 3.00	N 1.85	N 2.45	0.80 BOK	1.00 S

SERVICE OFFSETS ARE MEASURED (m) FROM THE TITLE BOUNDARY UNLESS OTHERWISE SPECIFIED
 * SERVICE OFFSETS ARE MEASURED (m) FROM BACK OF KERB

WARNING
 BEWARE OF UNDERGROUND SERVICES
 THE LOCATIONS OF UNDERGROUND SERVICES ARE APPROXIMATE ONLY AND THEIR EXACT POSITION SHOULD BE PROVEN ON SITE. NO GUARANTEE IS GIVEN THAT ALL EXISTING SERVICES ARE SHOWN.

City of Casey
 Approved By: Ange Dean
 Planning Ref: PlnA01020/19
 File No: SEng00197/21
 Date: 16/11/2021
 Council Drawing No.: R5682
 Approval subject to:
 - A TMP approved prior to commencement of works.
 - An EMP approved prior to commencement of works.
 - Relevant service authorities notification and approval.
 Signed: *[Signature]*

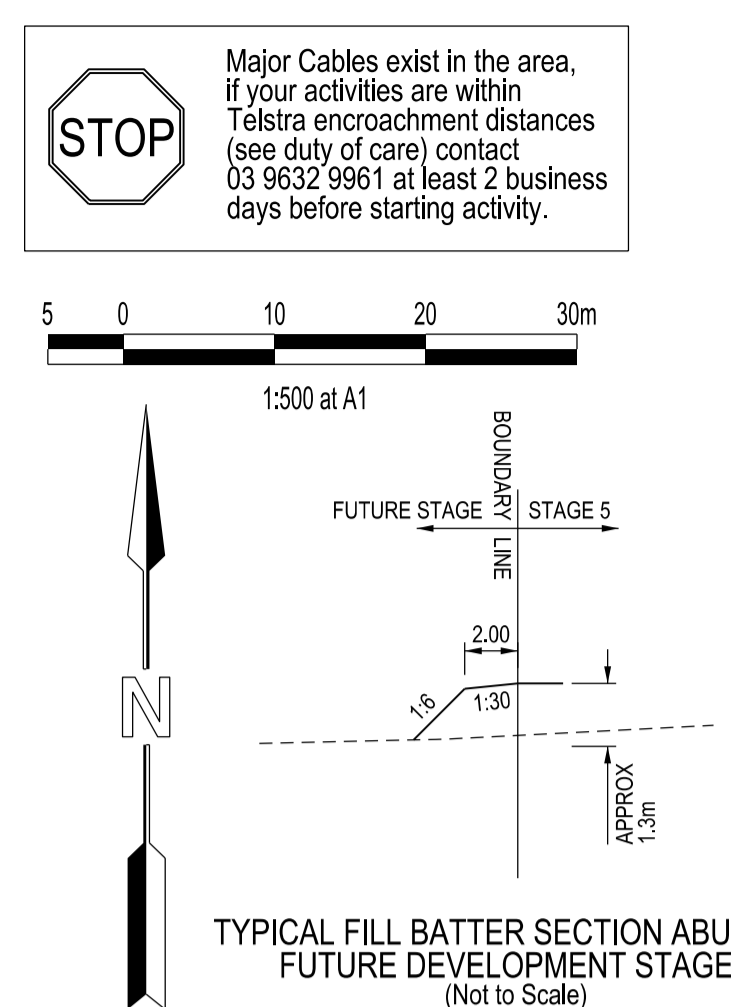

LEGEND

- FOOTPATH
- VEHICULAR CROSSOVER
- KERB AND CHANNEL
- ELECTRICITY TELECOMMUNICATION) CONDUITS
- GAS DRINKING WATER) CONDUITS
- NON DRINKING WATER
- ELECTRICITY MAIN
- TELECOMMUNICATION MAIN
- GAS MAIN
- DRINKING WATER MAIN
- NON DRINKING WATER MAIN
- SEWER MAIN, MANHOLE AND MAINTENANCE SHAFT
- SEWER MAIN, MANHOLE AND MAINTENANCE SHAFT AND SEWER PROPERTY BRANCHES - BY FHOBB
- PROPOSED DRAINAGE, PIT, HOUSE DRAIN AND PROPERTY INLET
- EXISTING DRAINAGE AND PIT AND FUTURE DRAINAGE AND PIT
- MELBOURNE WATER SCHEME DRAINAGE AND PIT (COUNCIL ASSET)
- PROPOSED COUNCIL MAIN DRAINAGE PIPES AND PITS
- DRAINAGE PIT NUMBER
- PROPOSED CUT AREAS
- PROPOSED FILL AREAS
- E00.00 EXISTING SURFACE LEVEL
- D00.00 DESIGN SURFACE LEVEL
- B00.00 TOP OF BATTER LEVEL
- TW00.00 RETAINING WALL LEVEL
- STREET NAME SIGN
- LOT SLOPE DIRECTION
- PERMANENT SURVEY MARK
- TEMPORARY BENCH MARK
- RETAINING WALLS
- PROPOSED ELECTRICAL KIOSK LOCATION
- NEW ASPHALT PAVEMENT
- NEW CONCRETE PAVEMENT
- DAM TO BE DESLUDGED AND FILLED TO LEVEL 1 SPECIFICATIONS

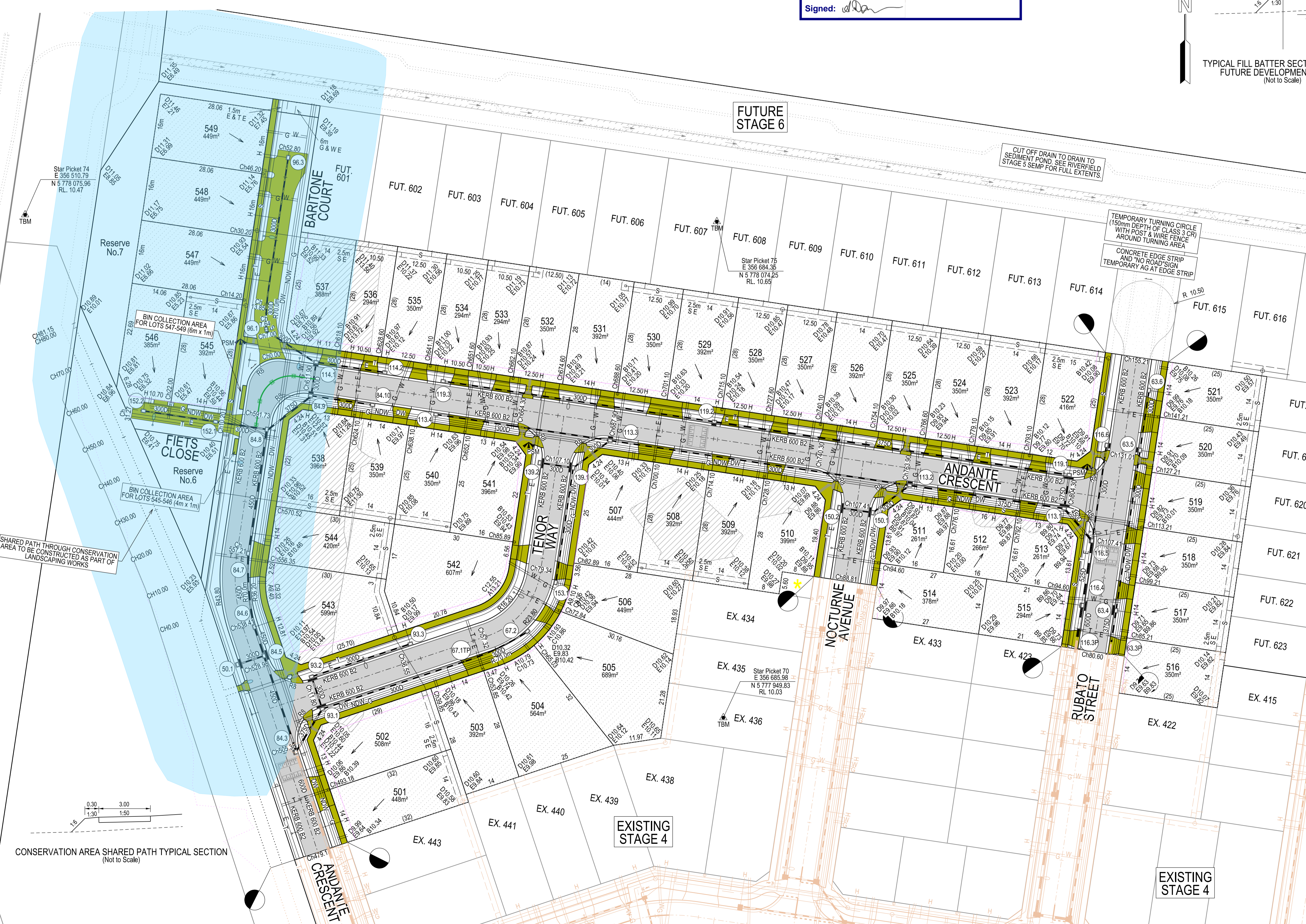

VERSION DETAILS:

REV	DATE	DESCRIPTION	STATUS
A	28/04/2021	CROSSOVER AND EASEMENT REVISION	INITIAL ISSUE
B	04/05/2021	PRELIMINARY PLAN	PRELIMINARY
C	06/07/2021	PRELIMINARY ISSUE TO COUNCIL	PRELIMINARY
D	12/07/2021	EXISTING SURFACE LEVELS AND CUT/FILL AREAS AMENDED TO REFLECT STRIPPED DAM SURFACE	PRELIMINARY
E	04/11/2021	COUNCIL COMMENTS DATED 29/10/21	PRELIMINARY
F	15/11/2021	COUNCIL COMMENTS DATED 15/10/21	IFC

FILENAME: P:\1209\1209_5IE2 - Design\6 - DGN\R04.dgn

DRAWN: C.BAXTER DATE: JUNE 2021 SCALE: AS SHOWN

DESIGNED: R.COLMAN DATE: JUNE 2021 DATE PRINTED: 16/11/2021

AUTHORISED: A.CHARLTON DATE: JUNE 2021



COUNCIL: CITY OF CASEY

TITLE: BROWN PROPERTY GROUP RIVERFIELD - STAGE 5 BALLARTO ROAD - CLYDE

DETAIL PLAN & SERVICE OFFSET TABLE

DRG NO. 1209_5/R04	REV. F	SHEET 04 OF 27
--------------------	--------	----------------